

## Features

- Double Shut Off
- Ball Lock
- Operating Temperature from -40 °C to +105 °C
- ISO 16028
- Free-Cutting Steel
- Interchangeable:

Stucchi  
Tema  
EAS CQ  
ISO 16028

## RS PRO Hydraulic Quick Connect Couplings

RS Stock No.: 0727310



RS PRO is the own brand of RS. The RS PRO Seal of Approval is your assurance of professional quality, a guarantee that every part is rigorously tested, inspected, and audited against demanding standards. Making RS PRO the Smart Choice for our customers.

## Product Description

These RS PRO couplings are compliant with ISO 16028 are designed for demanding hydraulic applications where leak-free performance and contamination control are critical. These hydraulic flat face quick couplings are the most popular types of quick hydraulic couplings due to lack of fluid spillage after disconnection and ease of cleaning, both strictly related to the flat face design of the sealing valves; the connection and disconnection mode is also comfortable and user-friendly.

**Sleeve:** Hardened and solid barstock construction for a quality coupling giving maximum resistance to damage from hydraulic or mechanical shock. Performs as spring loaded “locking Latch”.

**Safety Sleeve Lock:** When the coupling is dragged along the ground to prevent accidental disconnection. Sleeve is rotated to engage the lock.

**Locking Balls:** A large number of locking balls distribute the workload evenly while providing alignment to reduce hose torque and prolong hose life.

Applications:

- Industrial manufacturing
- Mobile equipment
- Agricultural equipment
- Construction
- Oil and gas extraction and exploration
- HVAC applications
- And many other industrial processes

Interchangeability:

- Stucchi
- Tema
- EAS CQ
- ISO 16028

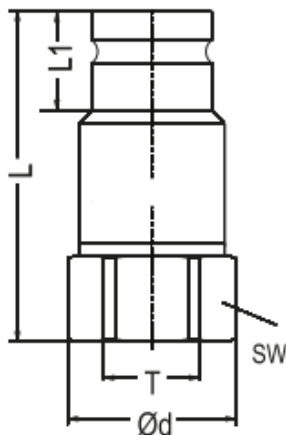

Female Threaded Plug

T Connection	SW (mm)	ØD (mm)	L (mm)
G 3/8"	24	17	62

## Specifications

<b>Manufacturer Series</b>	72
<b>Standards Met</b>	ISO 16028
<b>Compatible with</b>	Stucchi Tema EAS CQ9 ISO 16028
<b>Maximum Operating Pressure</b>	325 Bar
<b>Minimum Operating Temperature</b>	-40 °C
<b>Maximum Operating Temperature</b>	+105 °C
<b>Type</b>	Coupling Plug
<b>Locking Style</b>	Ball Lock
<b>Double Shut Off</b>	Double Shut Off
<b>Thread Size</b>	3/8 in
<b>Thread Standard</b>	G
<b>Thread Gender</b>	Female
<b>Coupling Gender</b>	Male
<b>Thread</b>	G 3/8 in Female
<b>Material</b>	Steel
<b>Finish</b>	Free-Cutting Steel, Chrome Plating
<b>Seal Material</b>	Nitrile Rubber
<b>Sleeve Material</b>	Chrome-Plated Case-Hardening Steel (8620)
<b>Valve Material</b>	Chrome Plating on AISI 420 Material
<b>Spring Material</b>	14310
<b>Locking O Ring Material</b>	Nitrile Rubber
<b>Ball Material</b>	AISI-420

