

Features

- Voltage Rating: 30Vac, 60Vdc
- Current Rating: Max 24A
- Insulation Material: ABS
- Contact Material: Brass
- Contact Plating: Zinc plated

RS PRO Black 4mm Panel-mount Socket, Solder Termination, 24A, 30Vac

RS Stock No.: 0205394



RS PRO is the own brand of RS. The RS PRO Seal of Approval is your assurance of professional quality, a guarantee that every part is rigorously tested, inspected, and audited against demanding standards. Making RS PRO the Smart Choice for our customers.

Banana Plugs & Connectors

Product Description

- RS Connectivity insulated banana Panel-mount test plugs have a ABS insulating body and Zinc plated brass contact. The Tip Jack series accept wire sizes to 16-gauge and has a recessed head to reduce shock hazard.*

General Specifications

Type	Banana Panel-mount Socket
Accepts Standard	4mm
Colour	Black
Gender	Panel-mount Socket
Contact Material	Brass
Contact Plating	Zinc plated

Electrical Specifications

Voltage Rating	30Vac,60Vdc
Current Rating	Max.24A
Insulation Material	ABS
Insulation resistance	Min.500M ohm
Contact resistance	Max 0.005 ohm

Mechanical Specifications

Banana Plugs & Connectors

Length ($\pm 10\%$)	29.5mm
Overall Diameter ($\pm 10\%$)	11mm

Approvals

Standards Met	RoHS Compliant
Declarations	Reach

Spec Drawings Diameter

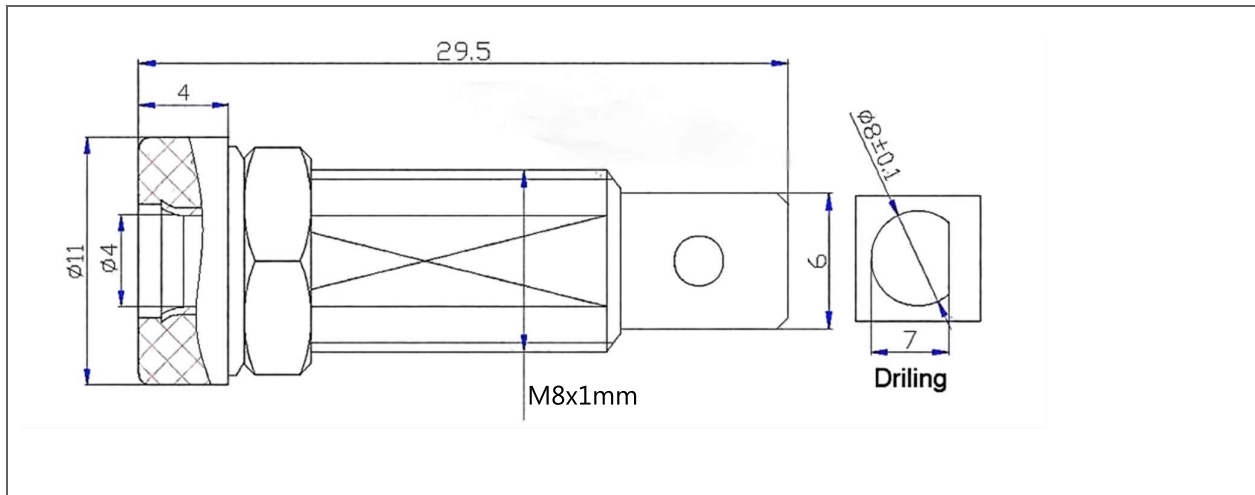

Product Dimensions Details