

Features

- Flexible and durable H05VVF3G1.0- pvc cable
- Y junction cable extension
- Moulded IEC -C14
- Fully moulded Y junction
- Moulded IEC C13 x 2
- Integrated strain relief for connection support and protection

RS PRO 2.5m Power cable C13, IEC to C14 IEC 10A 250 V

RS Stock No.: 0285173



RS PRO is the own brand of RS. The RS PRO Seal of Approval is your assurance of professional quality, a guarantee that every part is rigorously tested, inspected, and audited against demanding standards. Making RS PRO the Smart Choice for our customers.

Product Description

From RS PRO a high quality and durable “Y” junction power extension cord for connecting two computer appliances with C14 inlets to a single power input cord. This extension cord is fully equipped with an IEC C14 male type plug on one end and two IEC C13 female sockets on the other. The cable features integrated strain relief that provides additional support.

General Specifications

Connector A	C13, IEC Female – Angled EN60320 /C13 x 2
Connector B	C14 IEC Male – Straight EN60320-2-2/E
Connector C	Y junction (AT1)
Sheath colour	black
Material	PVC
Applications	DIY and home improvements, Maintenance work, Household Entertainment (TVs, Satellite boxes, routers etc.) Industrial machines and equipment Office desks (monitors, computers, phones) Any Electrical device needed to be connected by mains, also an IEC extension lead, Powering two pieces of equipment. Example Computer and printer.

Mechanical Specifications

Length	2.5m
--------	------

Electrical Specifications

Power Cord Rating	10 A - 250V
Visual Inspection	100%
Electrical Test	100%
High pot test wire to wire	3.000Vac for 2 sec.
Continuity test	25Aac to grounding / 20A to line and neutral
Polarity test	yes
Skin high pot test	6.000Vac line to skin

Protection Category

Environmental Conformity	Eu-Directive 2002/96/EC (WEEE)
	Eu-Directive 2003/11/EC (Council Directive 76/769/EEC)
	Eu-Directive 2002/95/EC (RoHS-Compliant)

Approvals

C13 CONNECTOR x 2	ENEC, CE, UKCA
C14G IEC	ENEC, CE, UKCA
Y JUNCTION	UL CSA
Cable	Harmonised <HAR>

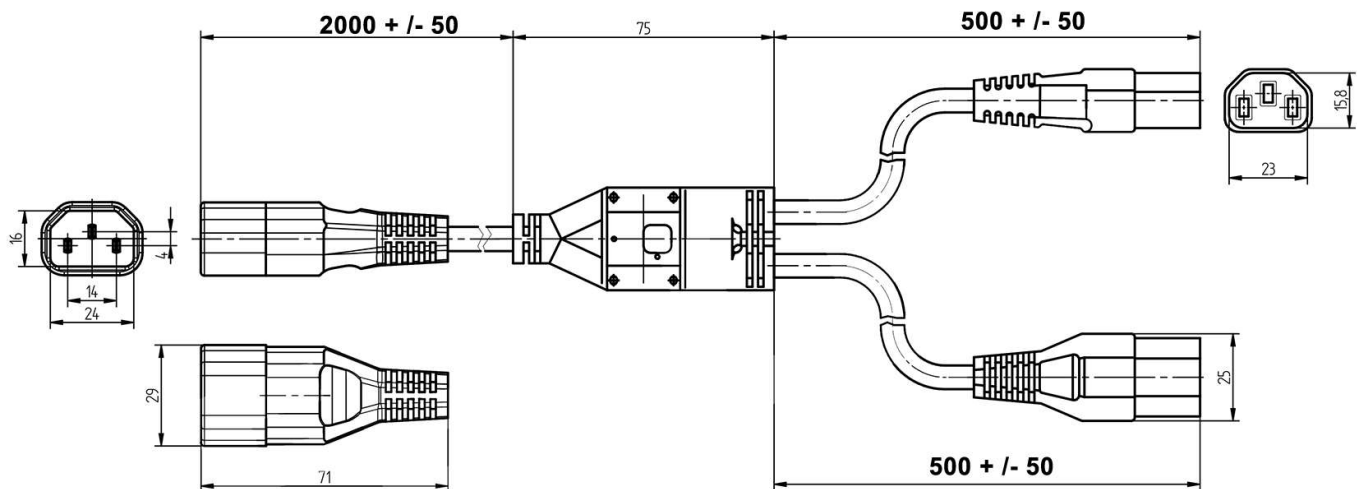

All Dimensions in mm

Classification