

**ICD15S13E6GV00LF - D-Subminiature High Density : High density 15 way Right Angle Solder socket, >500 Mating Cycles, Harpoons + Female Screw UNC 4 - 40 + Elec cont**

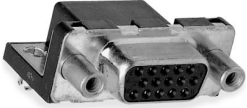

[www.fci.com](http://www.fci.com)



## Specifications

<b>General</b>	
Contact type	Signal
Gender	Socket
Number of contacts (Total)	15
Orientation	Right Angle
Product Type	Connector
Termination Style	Solder
<b>Dimensional</b>	
Size (Shell)	E
Thickness (Board)	1.6 mm
Height (Conductor)	6.3 mm
<b>Electrical</b>	
Current rating	2.5 A Per contact
Resistance (Contact)	< 25 milli ohms
Voltage rating	300V rms at 50 Hz
Voltage rating (DWV - Dielectric withstanding)	750V r.m.s
<b>Mechanical</b>	
Durability (Plating - Mating cycles)	High Perf (>500 Mating Cycles)
Extraction force (Mating part)	0.3N min. per contact
Insertion force (Mating part)	5N max.Per contact
<b>Mounting</b>	
Attachment	Board
Mounting accessory	Harpoons + Female Screw UNC 4-40 + Electrical continuity
<b>Physical</b>	
Plating (Contact)	Gold over Nickel
Plating (Shell)	Semi bright Nickel
Plating (Termination)	Matte Tin over Nickel
Temperature (Operating - range)	-55°C to +125°C
<b>Approvals / Certifications</b>	
Approvals / Certifications	UL 94 V0

<b>Other Features</b>	
<b>Most Popular Configuration</b>	Yes

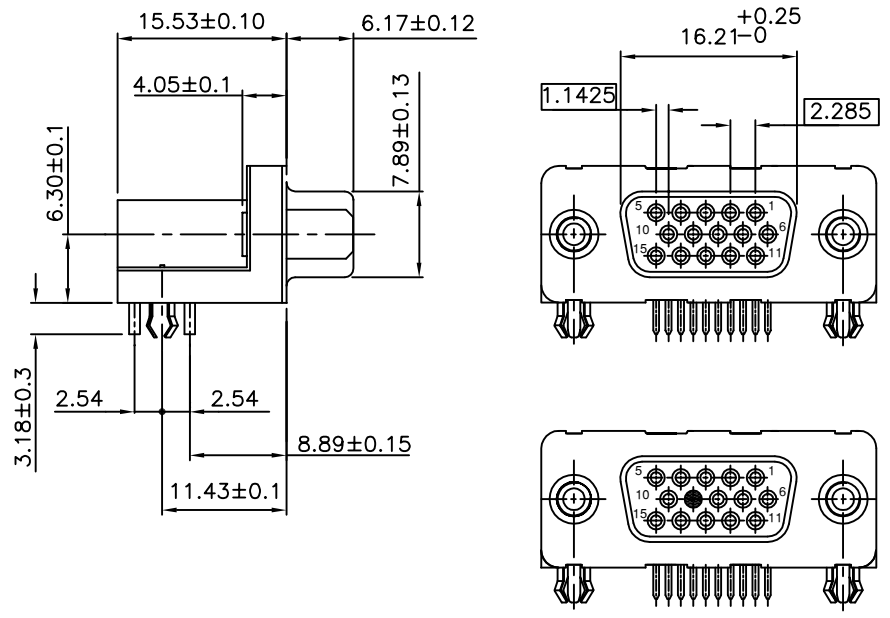
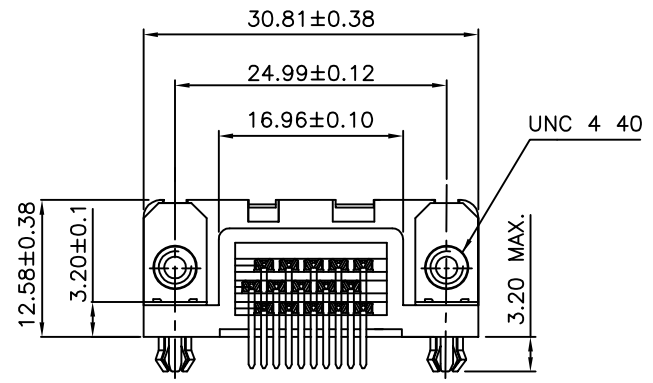
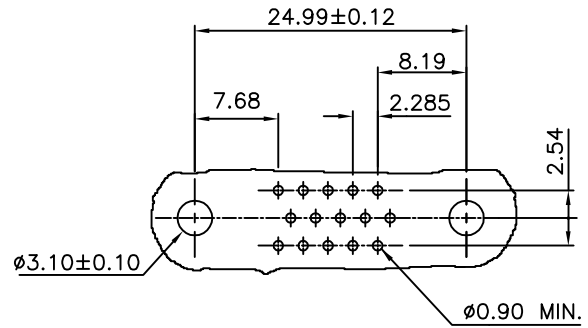
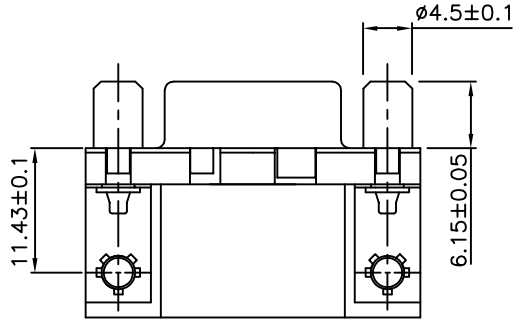

FOR 14 POSN.HOLE NO.9 IS BLOCKED.

**ORDERING INFORMATION**

I C D 1 5 S 1 3 E 4 G V 0 0 L F

**SERIES**  
NO.OF CONTACTS: 14, 15  
TYPE OF CONTACTS: S-SOCKET  
TYPE OF TERMINATION: 13 - ANGLED SPILL  
PITCH 2.54 USA  
FOOT PRINT 8.89 USA  
HEIGHT OF TERMINATION: E-3.18 US STANDARD  
PLATING: 4->FLASH Au+SnPb/Sn, 6->0.76 Au+SnPb/Sn

**LEAD FREE**

**SPECIAL CODE**  
00->STANDARD

**MOUNTING OPTIONS**  
GV->HARPOON+F. SCREW LOCK UNC 4.40+METAL BRACKET  
PA->STANDARD HOLE  
GL->HARPOON+INSERTM3+METAL BRACKET  
GX->HARPOON+INSERT UNC 4.40+METAL BRACKET  
UL->INSERT M3+METAL BRACKET  
UX->INSERT UNC 4.40+METAL BRACKET  
UV->F.SCREW LOCK UNC 4.40+METAL BRACKET

**TECHNICAL SPECIFICATIONS**

<b>MATERIAL</b>	
SHELL	: STEEL TIN / ZINC Cr3 PLATED.
INSULATORS	: SELF EXTINGUISHING BLACK POLYESTER UL CLASS 94V0 THE HOUSING WILL WITHSTAND EXPOSURE TO 260-265°C IF WE USE PROTECTIVE ADHESIVE (type Kapton or Teflon) OR PROTECTIVE METALLIC DEVICE
CONTACTS	: COPPER ALLOY
<b>PLATING</b>	
ACTIVE ZONE	: GOLD OVER NICKEL
TERMINATION ZONE	: TIN LEAD OVER NICKEL
METAL BRACKET FOR LEAD FREE PLATING	: BRASS,TIN/ZINC Cr3 PLATED. 2µMIN.MATTE TIN TOP OVER 1.27µ MIN.NICKEL UNDER PLATE(ON TERMINATION ZONE)
HARPOON	: BRASS,TIN PLATED.
CLINCH NUT	: BRASS,TIN/ZINC Cr3 PLATED.
SCREW LOCK	: BRASS,TIN/ZINC Cr3 PLATED.
<b>ELECTRICAL DATA</b>	
MAX.CURRENT RATING	: 3A
TEST VOLTAGE	: 1000V
RATED VOLTAGE	: 300V
CONTACT RESISTANCE	: ≤ 25mΩ
SHELL RESISTANCE	: ≤ 5mΩ
INSULATION RESISTANCE	: ≥ 5000MΩ
<b>ENVIRONMENTAL CHARACTERISTICS.</b>	
OPERATING TEMPERATURE RANGE	: -55°C +125°C
<b>MECHANICAL CHARACTERISTICS</b>	
MATING/UNMATING CYCLES (MIN)	: 200 (FLASH Au); 500 (0.76µ Au)
INSERTION/EXTRACTION FORCE PER CONTACT	: 5 N Max./ 0.3 N Min.

"This LF product meets European Union Directives and other country regulations as described in GS-22-008"

The housing will withstand exposure to 260°C peak temperature for 3.5 seconds in a wave solder application with a 1.6mm minimum thick circuit board.

Packaging as per GS-14-920

mat'l. code	surface	tolerance	projection	product family
SEE NOTE 4	ISO 1302 ✓	ISO 406 ISO 1101		COMPACT D
ltr	ecn no	dr	date	title
F	106-0074	GVJ	2006/06/08	COMPACT-D A/S FEMALE CONNECTOR (GV VER.) (WITH F. SCREW LOCK ,HARPOON & METAL BRACKET)
				MM
				scale -
				dwg no
				sheet 1 of 1
				size
				A3
				type
				Product Customer Drawing
sheet index	revision sheet	F	1	



Copyright FCI