



**FAG**

## SES515-612-L

### Plummer block housing

Split plummer block housing for various bearing designs. The SNV series will be replaced by the new SES series in 2022.

## Technical information

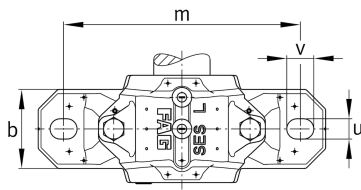

### Main Dimensions & Performance Data

D	130 mm	Outside diameter bearing
a	280 mm	Length base
h <sub>1</sub>	156 mm	Height
g	115 mm	Width housing body
K	56 mm	Width bearing seat
≈m	7 kg	Weight

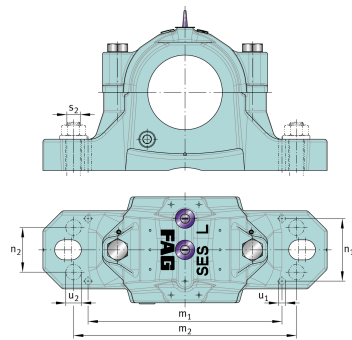
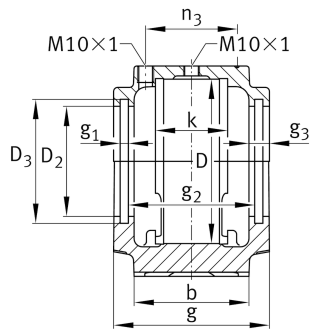
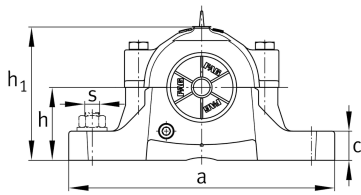

## Dimensions

b	80 mm	Width base
c	30 mm	Height base
h	80 mm	Base to shaft centerline height
m	230 mm	Distance fixing bore
s	15.875 mm	Screw size
s	M16	Size of fixing screws
u	18 mm	Width slot
v	24 mm	Length slot
D <sub>2</sub>	87 mm	Diameter sealing
D <sub>3</sub>	95.5 mm	Diameter sealing groove
D <sub>5</sub>	93.2 mm	Outside diameter sealing labyrinth
g <sub>1</sub>	5 mm	Width sealing groove
g <sub>2</sub>	97 mm	Distance sealing
g <sub>3</sub>	13 mm	Wall thickness
g <sub>4</sub>	28 mm	Distance oil lubrication
m <sub>1</sub>	194 mm	Distance holes aligned pins m1
n <sub>3</sub>	71 mm	Distance lubrication
n <sub>4</sub>	101 mm	Distance lubrication sealing
u <sub>1</sub>	8 mm	Bore diameter u1
u <sub>2</sub>	14 mm	Bore diameter u2