

Low Profile or Prominent with Flush Mounting

Key Characteristics

Functional

- 6.35mm mounting
- Space critical applications
- 80° viewing angle

Resilient

- IP66 sealed
- -40 to 85°C operating and storage temp
- Corrosion resistant

Adaptable

- Full colour range with lens options
- Voltage and current options
- Customer specials on request



Specifications

COLOURS									
Luminous Intensity	mcd	White	Red	Yellow	Green	Blue	Voltage		Current (mA)
							Forward	Reverse	
STD	35	x	✓	✓	✓	x	5,12,24,28	5,12,24,28	15
	45	x	✓	✓	✓	x	2.2	5	20
High Intensity	750	✓	x	✓	x	x	5,12,24,28	5,12,24,28	15
	900	x	✓	x	x	✓	5,12,24,28	5,12,24,28	15
	940	x	x	x	✓	x	5,12,24,28	5,12,24,28	15
	1000	✓	x	x	x	x	2.2	5	20
	1000	x	x	✓	x	x	3.6	5	20
	1200	x	x	x	x	✓	3.6	5	20
	1250	x	✓	x	x	x	1.9	5	20
1250	x	x	x	✓	x	3.6	5	20	

Ordering Information

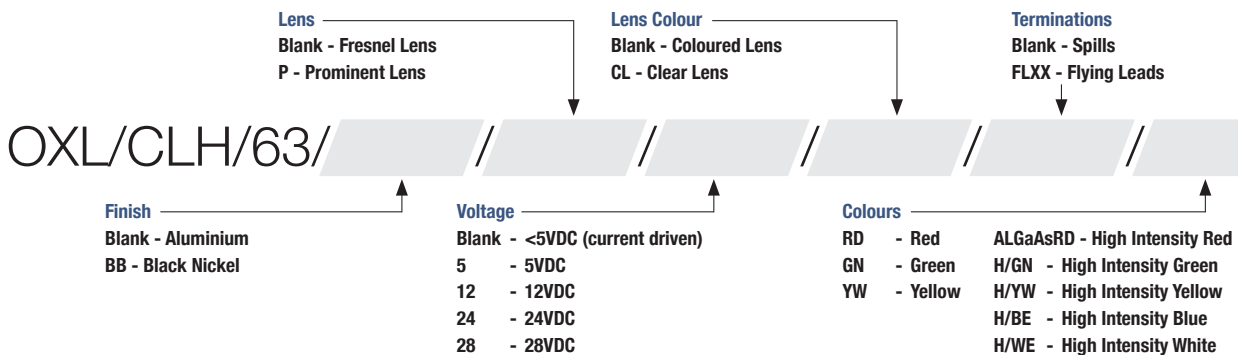

Example: OXL/CLH/63/RD - Aluminium Finish, Fresnel Lens, 2.2v, Coloured Lens, Spills, Standard Intensity Red

Example: OXL/CLH/63/BB/P/12/CL/FL20/H/BE - Black Nickel, Prominent Lens, Clear Lens, 12v, Flying Lead 20cm, High Intensity Blue

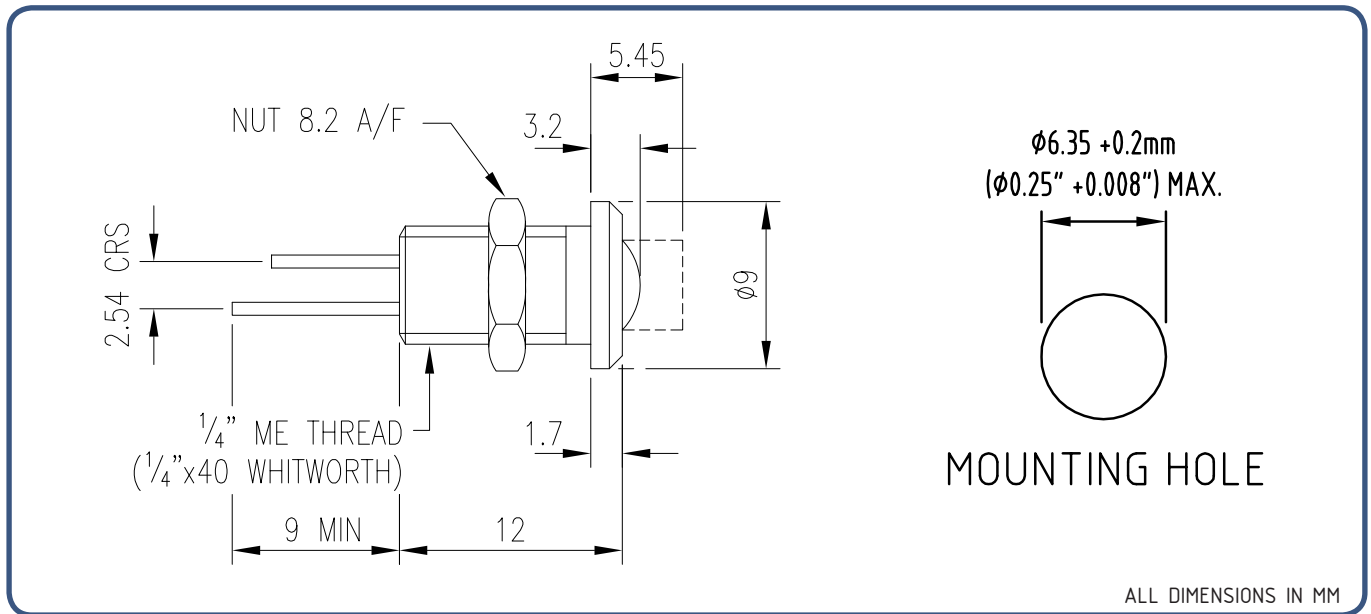

Technical Information

Terminations	Flying Leads Copper wire PVDF Insulation
Body	Aluminium Alloy, Clear (Black Nickel Option)
Lens	Colour Polycarbonate (Clear Lens Optional)
Nut	Nickel Plated Brass
Washer	Spring Steel, Bright Zinc Plated
Chassis Thickness	1.5mm (0.059") – 5mm (0.197")
Mounting Hole	6.35mm + 0.2
Recommended Mounting Torque	1Nm (0.74lbft)
Mean Time Before Failure	90,000 hours

Termination Options



Flying Leads

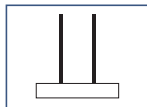

Spills

Lens Options



Low Profile



Prominent

Distributed by

