

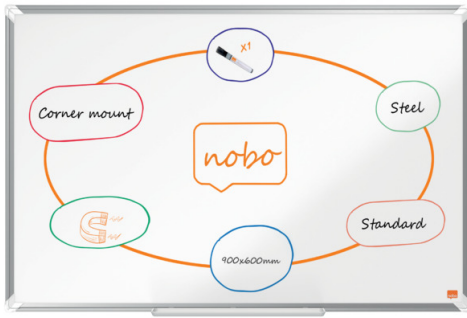

Nobo Premium Plus Steel Magnetic Whiteboard 900x600mm

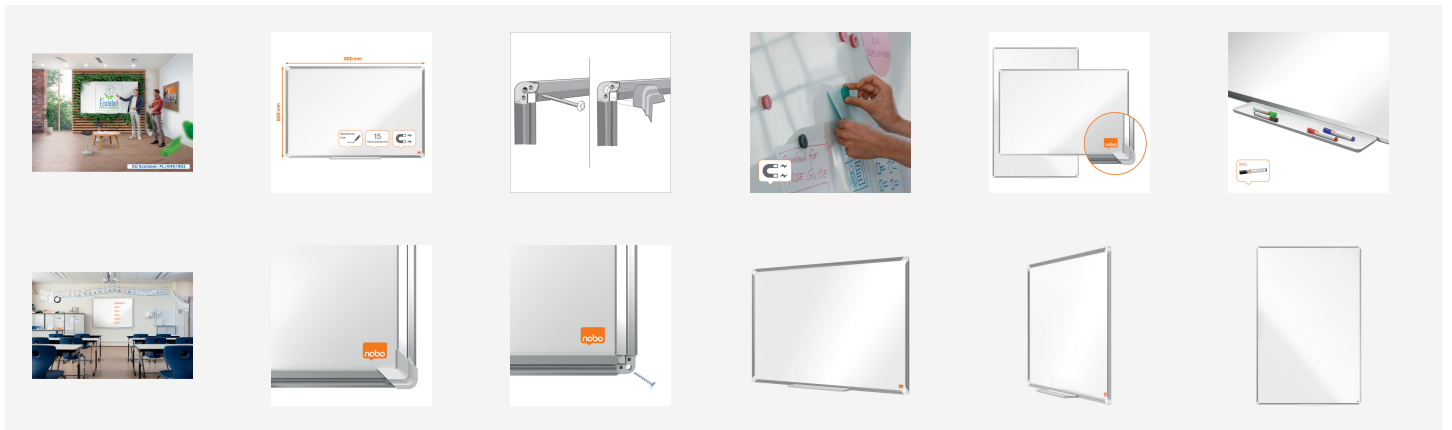

This modern standard magnetic whiteboard, with its sleek aluminium trim and stylish corner caps, is the perfect addition to any office, school, or home workspace. Its painted steel surface offers increased erasability which is less prone to ghost marks, stains and resistant to scratches and dents, making it ideal for moderate use. This medium whiteboard has a smooth surface that enhances writing, ensuring clear, bold and stand out communication for effective collaboration. Designed with a concealed traditional through corner-mount system, it can be easily installed in either landscape or portrait orientation. The wall mounted whiteboard is magnetic, allowing for easy attachment of notes, photos, and key information and includes a large clip on accessories tray for the storage of whiteboard pens and whiteboard magnets. Our Premium Plus Whiteboards proudly carry the globally respected EU Ecolabel, recognising environmental excellence and ensuring reduced impact throughout the product life cycle. Whiteboard size: 900x600mm



Attributes

- Painted steel magnetic whiteboard surface delivering an increased level of erasability for moderate use.
- EU Ecolabel certified, recognising environmental excellence and ensuring reduced impact throughout the product lifecycle.
- Fixed with a traditional through corner wall mounting and concealed with stylish corner caps.
- Traditional standard format size 900x600mm
- Framed whiteboard with a modern stylish aluminium trim can be fixed portrait or landscape orientation for flexibility.
- A large whiteboard accessories tray for the convenient storage of whiteboard markers, erasers and magnets within easy reach.
- Supplied with a Nobo whiteboard pen
- 15 year surface guarantee



Specifications

Number	1915155
Colour	white
Dimensions (W x H x D)	903 x 594 x 14 mm
Weight	2860 g
Pallet quantity	70
EAN code	5028252608275