

Core
FS-1ETD-4415-00

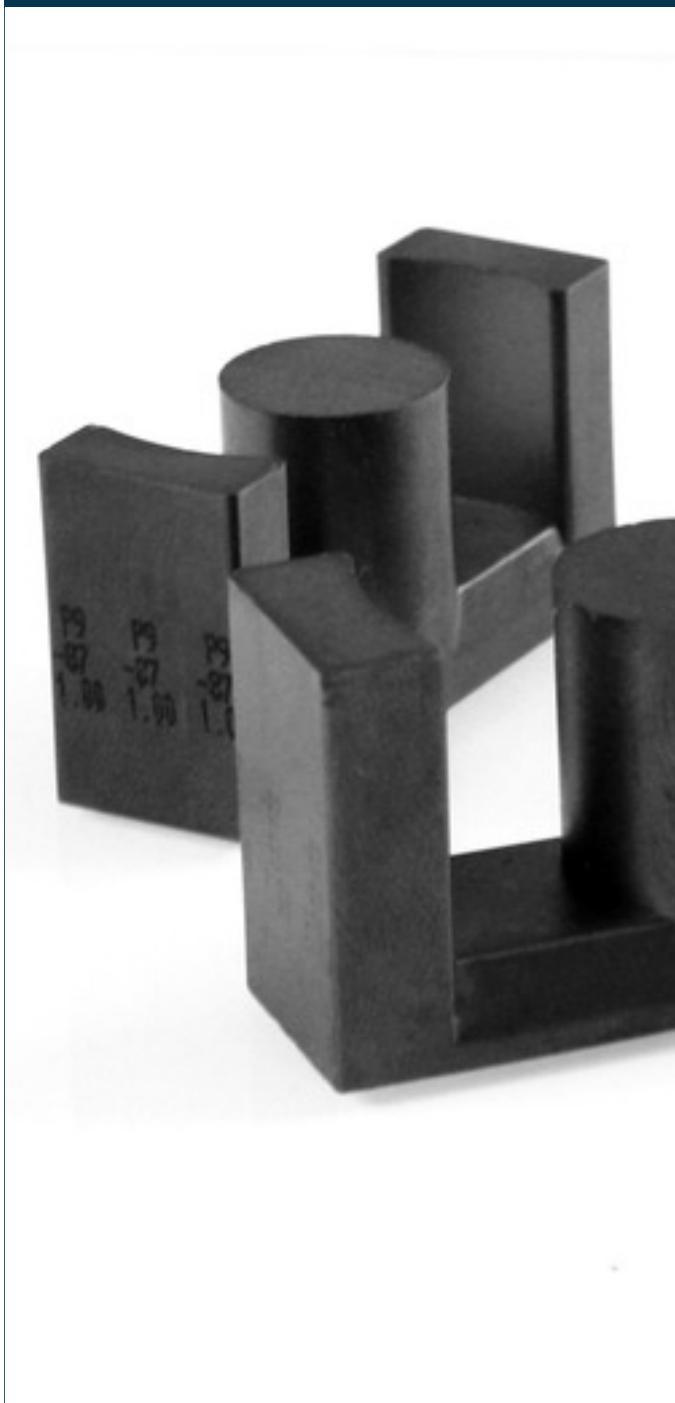

Advantages

Insertion of air gaps on request

On request wound inductors to EN61558-2-16 standard an EN60950 or vacuum potted

Cost saving and easy compilation of components for pattern construction through unification

Applications

Transformers and reactors in switch mode power supplies

Approvals



Core FS-1ETD-4415-00

| Type | | FS-1ETD-4415-00 |
|-----------------|--------------------------|------------------------|
| Electrical data | General data | |
| | for housing | FS-1ETD-4415 |
| | Magnetic characteristics | |
| | | >210°C |
| | | <450 kW/m³ |
| | | 21A/m @25°C |
| | | 13A/m @100°C |
| | | >380 |
| | Ae | 173.0 mm² |
| | | 172.0 mm² |
| | Le | 103.0 mm |
| | | 3500 nH ± 25% |
| | | 0 nH ± 10% |
| | | 1440 nH ± 10% |
| | | 862 nH ± 10% |
| | 438 nH ± 10% | |
| | 262 nH ± 10% | |
| | 194 nH ± 10% | |
| | 157 nH ± 10% | |
| | 133 nH ± 10% | |
| Operating data | | |
| | | 25 kHz - 200 kHz |
| Notes | | |
| | | ISO 2768-m |
| Order numbers | | |
| Order Number | | FS-1ETD-4415-00 |

| Type | | FS-1ETD-4415-00 |
|--------|--|-----------------|
| Notes | | |
| Remark | | |

30 Mechanical data

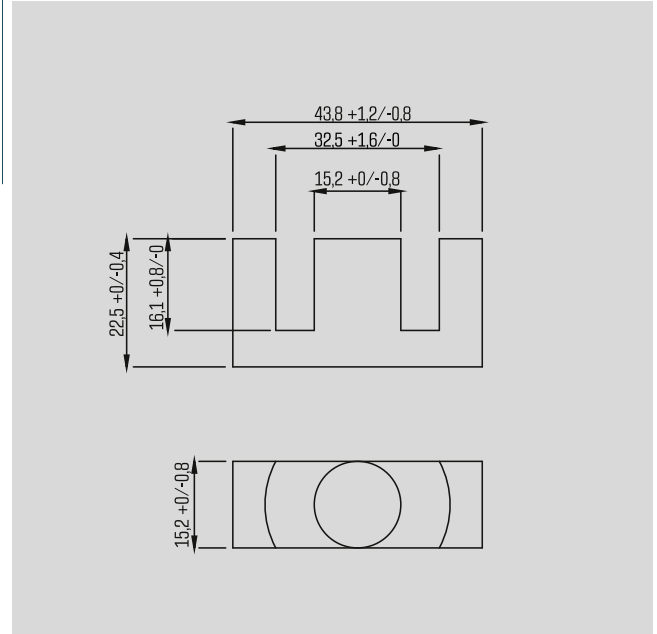

Subjects to change.