

**Blower Fan Package**

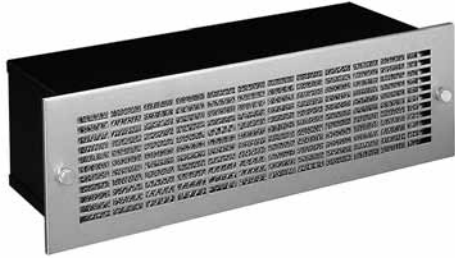

**Industry Standards**

UL Component Recognized; File No. E61997

EIA RS-310-D  
CSA certified  
(blower motor only)

**Application**

For enclosure or 19-in. rack applications, the Blower Fan Package provides the maximum amount of cooling air in the least amount of space by utilizing 115 volt AC, 60/50 hertz, single-phase input power. Engineered for 20,000 hours of continuous operation when properly powered.

**Features**

- Intake grille is easily removed with two captive thumbnuts
- Washable aluminum filter
- Single phase motor powers the statically balanced blower
- Motor is thermally protected and cooled by incoming forced air
- Direct drive induction motor contains permanently lubricated ball bearings
- Lubricant protects from -20 F to 298 F (-29 C to 148 C)
- Rotating components are suspended on neoprene shock-mounts
- Three-conductor power cord (five feet long)

**Installation**

Can be mounted as shown below or installed on standard 19-in. (483-mm) racks. The unit is self-supporting with 16 gauge steel flanges notched per EIA RS-310-D. Two openings are required in the enclosure for air to flow in and out. Refer to drawings for size and location of openings. An exhaust grille and filter package (catalog number **AEXGR275**) is required and must be ordered separately.

*Consult your local Hoffman sales office for information on modifications to this product.*

**Specifications**

- 16 gauge steel housing

**Finish**

Blower housing is black enamel.  
Grille is brushed stainless steel.

**Accessories**

Exhaust Grille and Filter  
Filter Adhesive  
Temperature Control Switch

Bulletin: D85

**Standard Product**

Catalog Number	AxBxC in./mm	Free Air (CFM)	Watts	Voltage	Hz	Amps	Motor RPM	Noise SIL (dB)	Weight (lb.)	Weight (kg)
<b>ADB275</b>	5.75 x 19.00 x 7.25	230 / 275	84	115	50 / 60	1.2	2580 / 3100	56	15.00	7.00
	146 x 483 x 184									

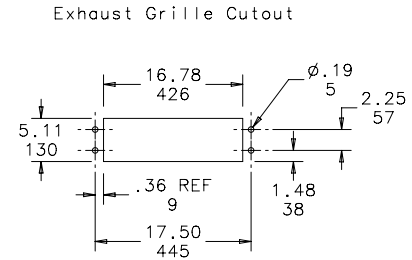
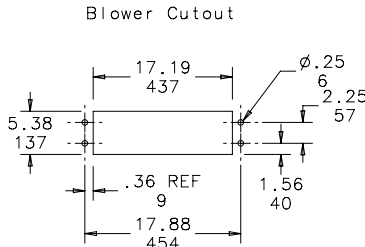
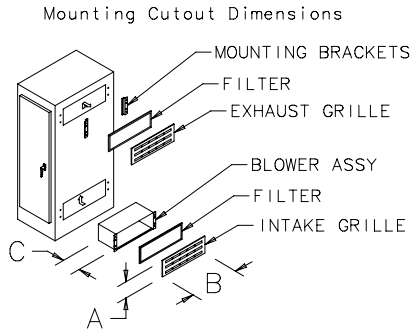

87541398

### Performance Curve for ADB275 Blower

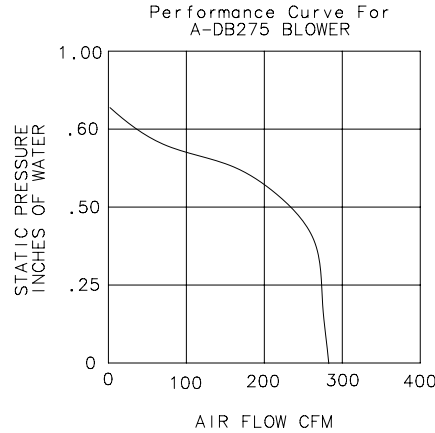

87794143

### Exhaust Grille and Filters for Blower Package

Bulletin: D85



Located at air discharge side of an enclosure using Blower Package ADB275. Polished stainless steel grille is 65 percent open and offers low resistance to airflow. Expanded aluminum filter (included with each grille) is easily removed for cleaning from outside the enclosure. Mounting hardware is furnished.

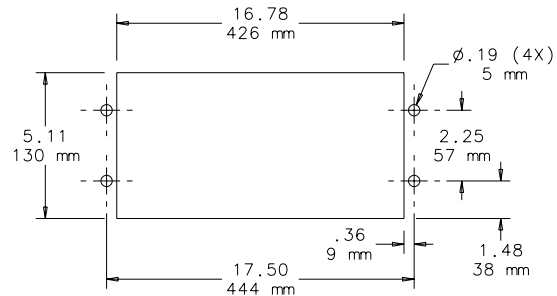

87541416

Catalog Number	Dimensions A x B in./mm	Filter Size in./mm
AEXGR275	5.75 x 19.00 146 x 483	4.98 x 16.56 126 x 421

### Replacement Filter

Catalog Number	Description	Quantity
AFLTR275AL	Aluminum Filter Replacement	5/pkg.