



Type	Switch-disconnector-fuse switch bodies for use with NF C or DIN fuses Handle to be ordered separately (see previous page)			
Rated insulation voltage (Ui)	690 V			
Conventional thermal current (Ith)	32 A	50 A	63 A	100 A
Fuse size	10 x 38	14 x 51	Size 00C (1)	22 x 58
External front-mounted and RH side-mounted operator	3-pole GS1DD3	GS2F3	GS2G3	GS2J3
External LH side-mounted operator	4-pole GS1DD4 (2)	GS2F4	GS2G4	GS2J4
Direct RH side-mounted operator	3-pole GS1DD3 (3)	GS2FG3	GS2GG3	GS2JG3
operator	4-pole GS1DD4 (2)	GS2FG4	GS2GG4	GS2JG4
Direct RH side-mounted operator	3-pole GS1DD3 (3)	GS1FD3	GS1GD3	GS1JD3
operator	4-pole GS1DD4 (2) (3)	GS1FD4	GS1GD4	GS1JD4

(1) Compact fuse for German market

(2) 3-pole + switched neutral

(3) Direct front-mounted operator

Type	Switch-disconnector-fuse switch bodies for use with BS fuses Handle to be ordered separately (see previous page)			
Rated insulation voltage (Ui)	690 V			
Conventional thermal current (Ith)	32 A	32 A	63 A	100 A
Fuse size	A1	A1	A2-A3	A4 (Ø ≤ 31 mm)
External front-mounted and RH side-mounted operator	3-pole GS1DDB3	GS2DB3	GS2GB3	GS2JB3
operator	4-pole GS1DDB4 (2)	GS2DB4	GS2GB4	GS2JB4

Accessories

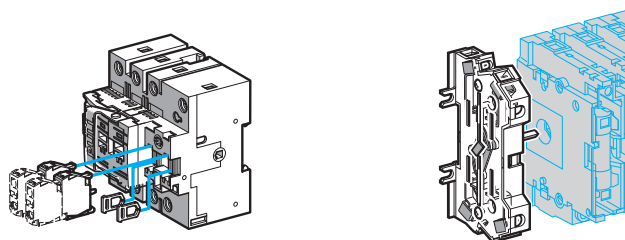

Type	Auxiliary contacts			
	Early break and/or O, I and Test signalling		O and I signalling	
Switch rating	32...1250 A		50...1250 A	
Number of contacts	1 NO	1 NC	1 NO + NC	2 NO + 2 NC
Operator	external front-mounted or RH side-mounted GS1AM110	GS1AM101	GS1AN11	GS1AN22
	external LH side-mounted GS1AM110	GS1AM101	GS1AN11G	GS1AN22G
	direct RH side-mounted -	-	GS1AN11	GS1AN22
	direct front-mounted -	-	-	-

Type	Auxiliary "blown fuse" signalling contacts for use with NF C and DIN fuses			
Number of contacts	1 NO/NC			
Switch rating	50 A	100 and 125 A	160 A	250 and 400 A
Fuse size	14 x 51	22 x 58	Size 0	Size 1 and Size 2
References	3-pole GS1AF1	GS1AF23	GS1AF33	GS1AF43
	4-pole GS1AF1	GS1AF24	GS1AF34	GS1AF44