

# CHARX ET2C-3AC20-5,0MES00P1 - AC charging cable



1518293

<https://www.phoenixcontact.com/gb/products/1518293>

Please be informed that the data shown in this PDF document is generated from our online catalog. Please find the complete data in the user documentation. Our general terms of use for downloads are valid.



CHARX connect eco, Type 2, AC charging cable, 20 A permanent, 480 V AC, with vehicle charging connector and open cable end, Functional prototype, cable: 5 m, black, straight, with protective cap, with SAMPLE marking, PHOENIX CONTACT logo, IEC 62196-2, for charging electric vehicles (EV) with alternating current (AC)

## Product description

AC charging cable with vehicle charging connector and free cable end for charging electric vehicles (EV) with alternating current (AC) via type 2 vehicle charging inlets, for installation at charging stations for e-mobility (EVSE)

## Your advantages

- Complete product range
- Convenient handling due to the ergonomic, triple award-winning design
- Available with your logo on request - for consistent branding of your charging station
- Longitudinal water tightness reliably prevents water ingress
- Developed and produced in accordance with the IATF 16949 automotive standard and ISO 9001
- Tested in accordance with automotive standards LV124, LV214, and LV215-2
- Tested in accordance with EV Ready 37 requirements
- Laser-marked mating face in accordance with DIN EN 17186

## Commercial data

|                                      |               |
|--------------------------------------|---------------|
| Item number                          | 1518293       |
| Packing unit                         | 1 pc          |
| Minimum order quantity               | 1 pc          |
| Sales key                            | XWBAAZ        |
| Product key                          | XWBAAZ        |
| GTIN                                 | 4063151981839 |
| Weight per piece (including packing) | 1,715 g       |
| Weight per piece (excluding packing) | 1,715 g       |
| Customs tariff number                | 85444290      |
| Country of origin                    | PL            |

# CHARX ET2C-3AC20-5,0MES00P1 - AC charging cable



1518293

<https://www.phoenixcontact.com/gb/products/1518293>

## Technical data

### Product properties

|                     |   |
|---------------------|---|
| Product type        | AC charging cable   |
| Product family      | CHARX connect eco   |
| Application         | for charging electric vehicles (EV) with alternating current (AC)<br>compatible with type 2 infrastructure charging sockets at charging stations for electromobility (EVSE) |
| Type                | AC charging cable<br>with vehicle charging connector and open cable end<br>Functional prototype   |
| Design              | with protective cap<br>with SAMPLE marking  |
| Affixed logo        | PHOENIX CONTACT logo  |
| Charging mode       | Mode 3, Case C  |
| Charging standard   | Type 2  |
| Customer variations | On request  |

### Electrical properties

|                               |  |
|-------------------------------|--|
| Type of signal transmission   | Pulse width modulation                   |
| Note on the connection method | Crimp connection, cannot be disconnected |
| Coding                        | 680 $\Omega$ (between PE and PP)         |
| Type of charging current      | AC 3-phase                               |
| Charging power                | 16.63 kW (3-phase)                       |
| Charging current              | 20 A AC (3-phase)                        |

### Power contact

|               |                       |
|---------------|-----------------------|
| Number        | 5 (L1, L2, L3, N, PE) |
| Rated voltage | 480 V                 |
| Rated current | 20 A                  |

### Signal contact

|               |            |
|---------------|------------|
| Number        | 2 (CP, PP) |
| Rated voltage | 30 V AC    |
| Rated current | 2 A        |

## Dimensions

### Vehicle charging connector

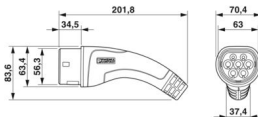
|                     |  |
|---------------------|--|
| Dimensional drawing |  |
| Width               | 70.4 mm  |

# CHARX ET2C-3AC20-5,0MES00P1 - AC charging cable



1518293

<https://www.phoenixcontact.com/gb/products/1518293>

|        |          |
|--------|----------|
| Height | 82.3 mm  |
| Depth  | 201.8 mm |

## Material specifications

|                                       |              |
|---------------------------------------|--------------|
| Color (Housing)                       | black (9005) |
| Color (Handle area)                   | black (9005) |
| Color (Mating face)                   | black (9005) |
| Color (Protective cap)                | black (9005) |
| Color (Cable)                         | black (9005) |
| Material (Vehicle charging connector) | Plastic      |
| Material (Cable outer sheath)         | TPE-U        |
| Material (Contact surface)            | Silver       |

## Cable/line

|                              |   |
|------------------------------|---|
| Cable length                 | 5 m   |
| Wiring standards/regulations | prEN 50620/DIN EN 50620   |
| Wiring certifications        | VDE   |
| Cable weight                 | max. 193.00 kg/km   |
| Cable type                   | Class 5   |
| Cable type                   | straight  |
| Cable structure              | 5 x 1.5 mm <sup>2</sup> + 1 x 0.5 mm <sup>2</sup>                         |
| External cable diameter      | 11.55 mm ±0.35 mm   |
| Outer sheath, material       | TPE-U   |
| Cable resistance             | ≤ 0.011324 Ω/m (based on a power core, at an ambient temperature of 20°C) |
| Bending radius               | min. 86.625 mm (7.5x diameter)  |

## Mechanical properties

### Mechanical data

|                             |         |
|-----------------------------|---------|
| Insertion/withdrawal cycles | > 10000 |
| Insertion force             | < 100 N |
| Withdrawal force            | < 100 N |

## Environmental and real-life conditions

### Ambient conditions

|   |  |
|---|--|
| Degree of protection (Vehicle charging connector) | IP44 (plugged in; when plugged in and ready to operate, the degree of protection is only ensued if both plug-in components are original products from Phoenix Contact or suitable standard-compliant products) |
| Degree of protection (Protective cap)             | IP54   |
| Ambient temperature (operation)                   | -40 °C ... 50 °C   |
| Ambient temperature (storage/transport)           | -40 °C ... 80 °C   |
| Altitude  | max. 5000 m (above sea level)  |

## Standards and regulations

# CHARX ET2C-3AC20-5,0MES00P1 - AC charging cable



1518293

<https://www.phoenixcontact.com/gb/products/1518293>

## Standards

|                       |             |
|-----------------------|-------------|
| Standards/regulations | IEC 62196-2 |
|-----------------------|-------------|

# CHARX ET2C-3AC20-5,0MES00P1 - AC charging cable

1518293

<https://www.phoenixcontact.com/gb/products/1518293>

## Drawings

Dimensional drawing

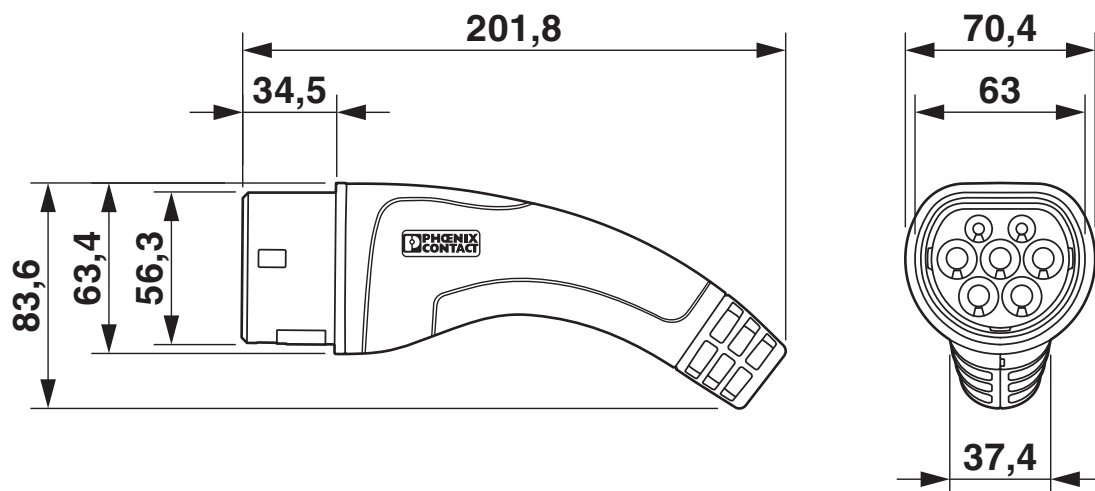

Connection diagram

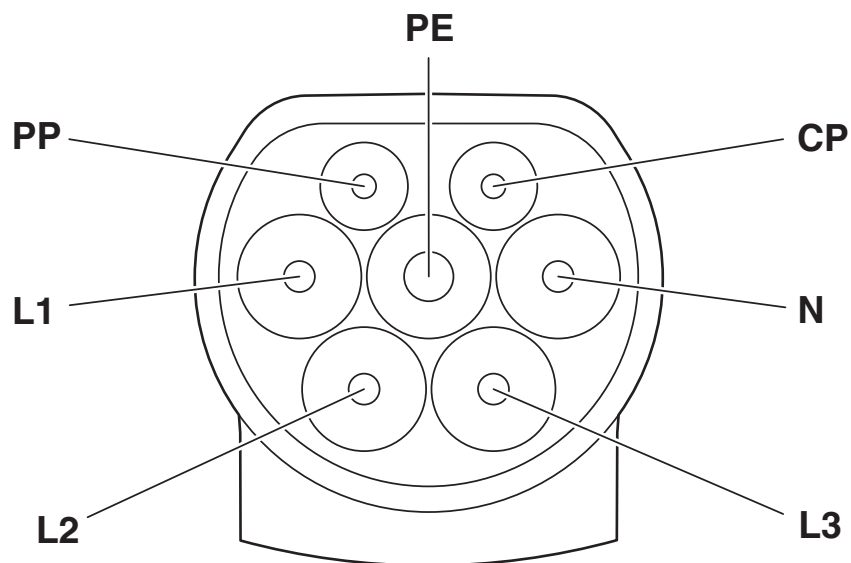

Pin assignment of Infrastructure Plug

# CHARX ET2C-3AC20-5,0MES00P1 - AC charging cable

1518293

<https://www.phoenixcontact.com/gb/products/1518293>

Schematic diagram

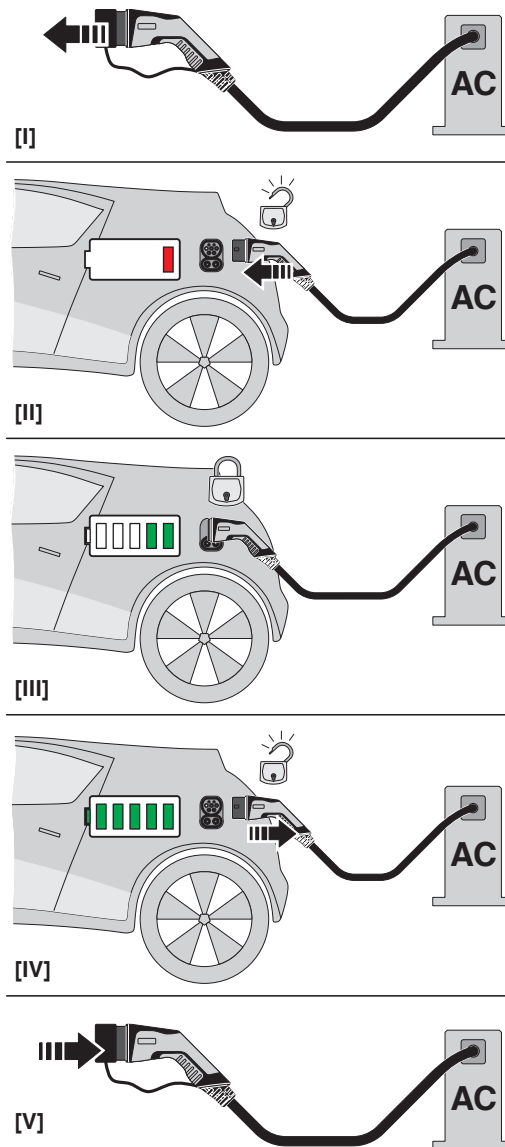

Operating instructions

# CHARX ET2C-3AC20-5,0MES00P1 - AC charging cable

1518293

<https://www.phoenixcontact.com/gb/products/1518293>

Schematic diagram

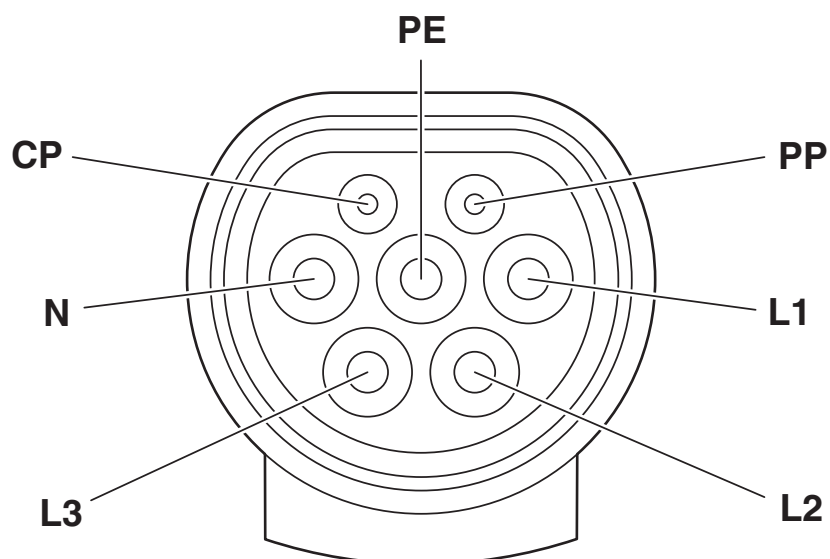

Pin assignment of the Vehicle Connector

Schematic diagram

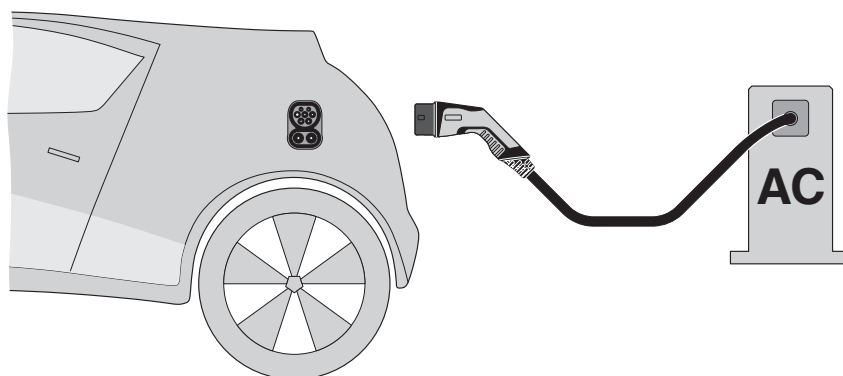

Terminology definition

# CHARX ET2C-3AC20-5,0MES00P1 - AC charging cable



1518293  
<https://www.phoenixcontact.com/gb/products/1518293>

## Approvals

To download certificates, visit the product detail page: <https://www.phoenixcontact.com/gb/products/1518293>

|   |                                |                                |                   |                               |
|---|--------------------------------|--------------------------------|-------------------|-------------------------------|
|  | <b>IECEE CB Scheme</b>         |                                |                   |                               |
|   | Approval ID: SG PSB-EH-00034   |                                |                   |                               |
|   |                                |                                |                   |                               |
|   | Nominal voltage U <sub>N</sub> | Nominal current I <sub>N</sub> | Cross section AWG | Cross section mm <sup>2</sup> |
|   | 480 V                          | 20 A                           | -                 | -                             |



# CHARX ET2C-3AC20-5,0MES00P1 - AC charging cable



1518293  
<https://www.phoenixcontact.com/gb/products/1518293>

## Classifications

### ECLASS

|             |          |
|-------------|----------|
| ECLASS-11.0 | 27144705 |
| ECLASS-12.0 | 27144705 |
| ECLASS-13.0 | 27144705 |

### ETIM

|          |          |
|----------|----------|
| ETIM 9.0 | EC002897 |
|----------|----------|

# CHARX ET2C-3AC20-5,0MES00P1 - AC charging cable



1518293

<https://www.phoenixcontact.com/gb/products/1518293>

## Environmental product compliance

### EU RoHS

|   |      |
|---|------|
| Fulfills EU RoHS substance requirements | Yes  |
| Exemption                               | 6(c) |

### China RoHS

|  |   |
|--|---|
| Environment friendly use period (EFUP) | EFUP-10   |
|  | An article-related China RoHS declaration table can be found in the download area for the respective article under "Manufacturer declaration". For all articles with EFUP-E, no China RoHS declaration table issued and required. |

### EU REACH SVHC

|                                     |                                      |
|-------------------------------------|--------------------------------------|
| REACH candidate substance (CAS No.) | Lead(CAS: 7439-92-1)                 |
| SCIP                                | 666ba920-2e84-4914-ace6-6f71511b6b2b |

Phoenix Contact 2025 © - all rights reserved

<https://www.phoenixcontact.com>

PHOENIX CONTACT Ltd  
Halesfield 13, Telford  
Shropshire, TF7 4PG  
01952 681700  
[info@phoenixcontact.co.uk](mailto:info@phoenixcontact.co.uk)