

IPD P 3P2,5 F BK - Connector

1088665

<https://www.phoenixcontact.com/gb/products/1088665>



Please be informed that the data shown in this PDF document is generated from our online catalog. Please find the complete data in the user documentation. Our general terms of use for downloads are valid.



Connector, product family: IPD, connection method: Push-lock connection, number of positions: 2+PE, Socket, 0.5 mm² ... 2.5 mm², 500 V, 20 A, PA, black, coding: P, external cable diameter: 6 mm ... 9 mm and 8 mm ... 13 mm

Your advantages

- Easy distribution of power, as components are plugged directly
- Simple, time-saving wiring in the field with Push-Lock connection
- Reliable installation in harsh environments with IP66, IP68, and IP69K throughout the entire system
- Secure, tool-free locking even in particularly difficult installation situations
- Fast commissioning with preassembled cable assemblies

Commercial data

Item number	1088665
Packing unit	1 pc
Minimum order quantity	1 pc
Sales key	AF6JAA
Product key	AF6JAA
GTIN	4055626890821
Weight per piece (including packing)	48.3 g
Weight per piece (excluding packing)	49.2 g
Country of origin	DE

IPD P 3P2,5 F BK - Connector

1088665

<https://www.phoenixcontact.com/gb/products/1088665>



Technical data

Notes

General

NOTE: Observe the permissible bending radii when routing cables, since the degree of protection may be at risk if the bending forces are too high. Reduce mechanical loads upstream of the connector, e.g., by using cable ties.

Product properties

Product type	Installation connector
Product family	IPD
Number of positions	3
Connection profile	2+PE
Position marking	L, N, PE
Number of connections per position	1
Coding	P

Insulation characteristics

Overvoltage category	III
Degree of pollution	3

Electrical properties

Rated surge voltage (III/3)	6 kV
Rated current	20 A
Rated voltage (III/3)	500 V
Nominal voltage U_N	500 V AC 500 V DC
Nominal current I_N	20 A

Connection data

Connection technology

Connection method On the field side	Push-lock connection
-------------------------------------	----------------------

Conductor connection

Conductor cross section flexibel	0.5 mm ² ... 2.5 mm ²
Conductor cross section solid	0.5 mm ² ... 2.5 mm ²
Conductor cross section with ferrule	0.5 mm ² ... 2.5 mm ²
Connection cross section AWG	20 ... 14

Dimensions

Dimensional drawing

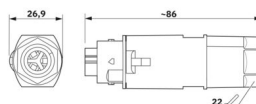

IPD P 3P2,5 F BK - Connector



1088665

<https://www.phoenixcontact.com/gb/products/1088665>

Width	26.5 mm
Height	26.9 mm
Length	85.9 mm

Material specifications

Color (Housing)	black (RAL 9005)
Material Housing	PA
Material Seal	NBR
Flammability rating according to UL 94	V0
Contact material	Cu
Contact surface material	Ni/Ag/Sn

Cable/line

External cable diameter	6 mm ... 9 mm
	8 mm ... 13 mm
Position marking	L, N, PE

Mechanical properties

Mechanical data

Insertion/withdrawal cycles	50 (IP66/IP68/IP69K)
	100 (IP66)

Environmental and real-life conditions

Ambient conditions

Degree of protection	IP66
	IP68 (2 m / 24 h)
	IP69K
	Touch-proof when not plugged in (IP2X)
Impact strength	IK07
Ambient temperature (operation)	-30 °C ... 100 °C
Temperature when conductor connected	-5 °C ... 50 °C
Ambient temperature (storage/transport)	-30 °C ... 100 °C
Resistance to UV radiation	yes

IPD P 3P2,5 F BK - Connector

1088665

<https://www.phoenixcontact.com/gb/products/1088665>



Drawings

Dimensional drawing

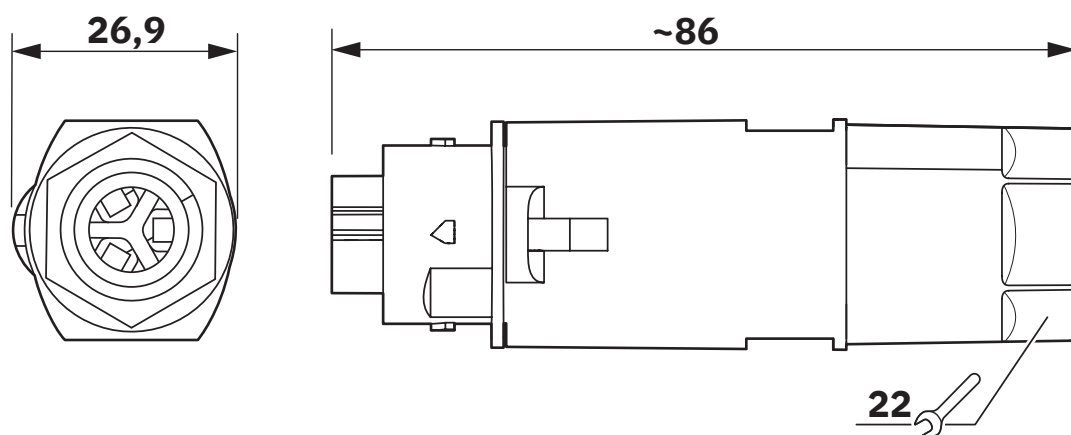

Diagram

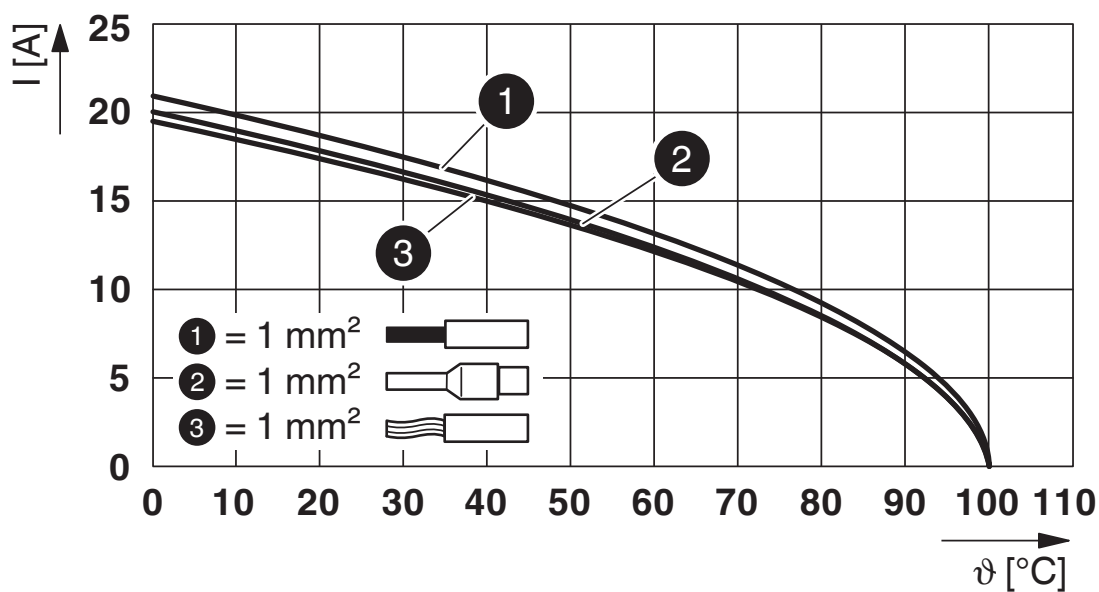

Derating diagram for 1.0 mm²

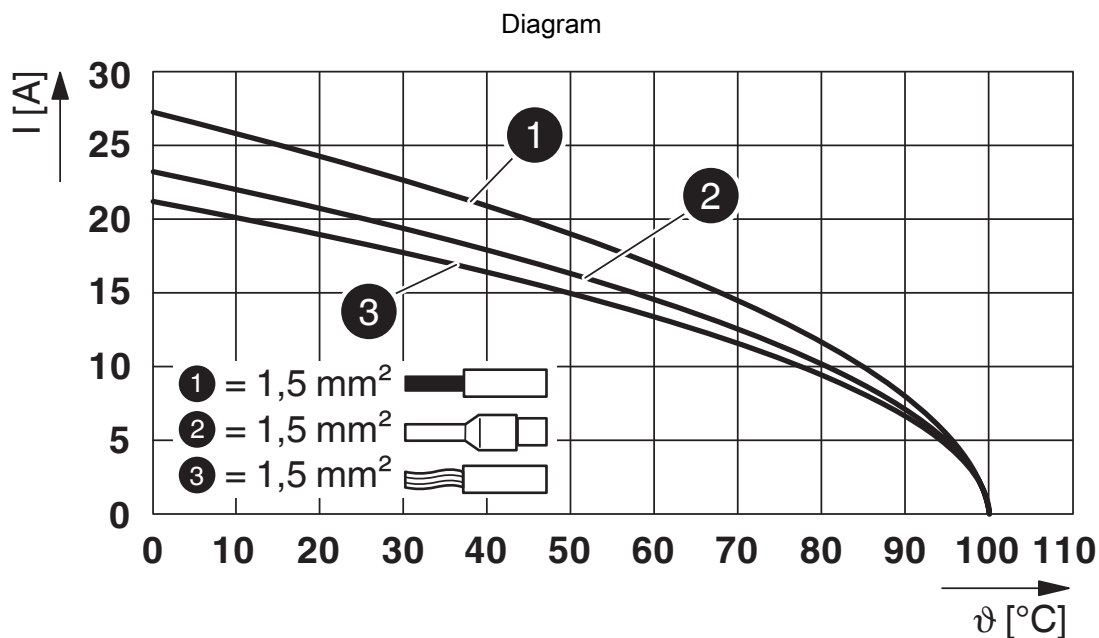

Derating diagram for 1.5 mm²

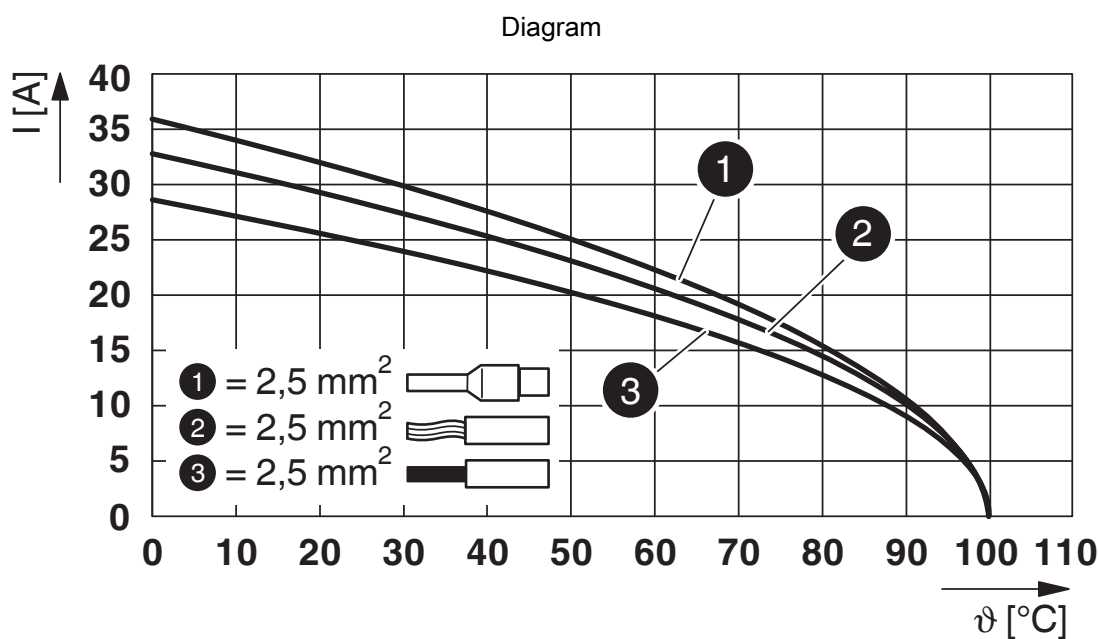

Derating diagram for 2.5 mm²

IPD P 3P2,5 F BK - Connector

1088665

<https://www.phoenixcontact.com/gb/products/1088665>



Approvals

To download certificates, visit the product detail page: <https://www.phoenixcontact.com/gb/products/1088665>

**VDE Zeichengenehmigung**
Approval ID: 40059408

 cULus Listed Approval ID: E468743				
	Nominal voltage U_N	Nominal current I_N	Cross section AWG	Cross section mm^2
Only rigid conductors	600 V	20 A	- 14	-
multi-stranded with ferrule	600 V	20 A	- 14	-

IPD P 3P2,5 F BK - Connector

1088665

<https://www.phoenixcontact.com/gb/products/1088665>



Classifications

ECLASS

ECLASS-13.0	27440605
-------------	----------

ETIM

ETIM 9.0	EC002560
----------	----------

UNSPSC

UNSPSC 21.0	39121400
-------------	----------

IPD P 3P2,5 F BK - Connector



1088665

<https://www.phoenixcontact.com/gb/products/1088665>

Environmental product compliance

EU RoHS

Fulfills EU RoHS substance requirements	Yes, No exemptions
---	--------------------

China RoHS

Environment friendly use period (EFUP)	EFUP-E
	No hazardous substances above the limits

EU REACH SVHC

REACH candidate substance (CAS No.)	No substance above 0.1 wt%
-------------------------------------	----------------------------

Phoenix Contact 2025 © - all rights reserved
<https://www.phoenixcontact.com>

PHOENIX CONTACT Ltd
Halesfield 13, Telford
Shropshire, TF7 4PG
01952 681700
info@phoenixcontact.co.uk