

Key-operated switch O.M.R, 22 mm, round, metal, shiny, lock number 73038, blue, with 2 keys, 2 switch positions O<I, momentary contact type, Actuating angle 45°, 10:30h/12h, Key removal O







Figure similar

|                          |                             |
|--------------------------|-----------------------------|
| Product brand name       | SIRIUS ACT                  |
| Product designation      | Key-operated switches       |
| Design of the product    | Actuating/signaling element |
| Product type designation | 3SU1                        |

| Actuator                                    |                                                                   |
|---------------------------------------------|-------------------------------------------------------------------|
| Manner of function of the actuating element | momentary contact, 45° (10:30 h/12 h), return from center to left |
| Product extension optional Light source     | No                                                                |
| Color                                       |                                                                   |
| • of the actuating element                  | Light blue                                                        |
| Material of the actuating element           | metal                                                             |
| Shape of the actuating element              | Key                                                               |
| Outer diameter of the actuating element     | 29.5 mm                                                           |
| Number of switching positions               | 2                                                                 |
| Switch position for key distraction         | O                                                                 |
| Actuating angle                             |                                                                   |
| • clockwise                                 | 45°                                                               |
| Lock make                                   | O.M.R.                                                            |

|                                                           |                                                                     |
|-----------------------------------------------------------|---------------------------------------------------------------------|
| <b>Key number</b>                                         | 73038                                                               |
| <b>Front ring</b>                                         |                                                                     |
| <b>Product component front ring</b>                       | Yes                                                                 |
| <b>Design of the front ring</b>                           | Standard                                                            |
| <b>Material of the front ring</b>                         | Metal, high gloss                                                   |
| <b>Color of the front ring</b>                            | silver                                                              |
| <b>General technical data</b>                             |                                                                     |
| <b>Protection class IP</b>                                | IP66, IP67, IP69(IP69K)                                             |
| • of the terminal                                         | IP20                                                                |
| <b>Degree of protection NEMA rating</b>                   | NEMA 1, 2, 3, 3R, 4, 4X, 12, 13                                     |
| <b>Shock resistance</b>                                   |                                                                     |
| • acc. to IEC 60068-2-27                                  | Sinusoidal half-wave 50 g / 11 ms                                   |
| <b>Vibration resistance</b>                               |                                                                     |
| • acc. to IEC 60068-2-6                                   | 10 ... 500 Hz: 5g                                                   |
| <b>Operating frequency maximum</b>                        | 1 800 1/h                                                           |
| <b>Mechanical service life (switching cycles)</b>         |                                                                     |
| • typical                                                 | 300 000                                                             |
| <b>Ambient conditions</b>                                 |                                                                     |
| <b>Ambient temperature</b>                                |                                                                     |
| • during operation                                        | -25 ... +70 °C                                                      |
| • during storage                                          | -40 ... +80 °C                                                      |
| Environmental category during operation acc. to IEC 60721 | 3M6, 3S2, 3B2, 3C3, 3K6 (with relative air humidity of 10 ... 95 %) |
| <b>Installation/ mounting/ dimensions</b>                 |                                                                     |
| <b>Height</b>                                             | 29.5 mm                                                             |
| <b>Width</b>                                              | 29.5 mm                                                             |
| <b>Shape of the installation opening</b>                  | round                                                               |
| <b>Mounting diameter</b>                                  | 22.3 mm                                                             |
| <b>Positive tolerance of installation diameter</b>        | 0.4 mm                                                              |
| <b>Mounting height</b>                                    | 51.7 mm                                                             |
| <b>Installation width</b>                                 | 29.5 mm                                                             |
| <b>Installation depth</b>                                 | 25.4 mm                                                             |
| <b>Certificates/approvals</b>                             |                                                                     |

| General Product Approval                                                                                                                                                      | Declaration of Conformity                                                                                                                                                           | Test Certificates                                                                              |
|-------------------------------------------------------------------------------------------------------------------------------------------------------------------------------|-------------------------------------------------------------------------------------------------------------------------------------------------------------------------------------|------------------------------------------------------------------------------------------------|
|  CSA<br> UL |  EAC<br> EG-Konf. | <a href="#">Special Test Certificate</a><br><a href="#">Type Test Certificates/Test Report</a> |

**other**

[Confirmation](#)

**Further information**

**Information- and Downloadcenter (Catalogs, Brochures,...)**

<http://www.siemens.com/industrial-controls/catalogs>

**Industry Mall (Online ordering system)**

<https://mall.industry.siemens.com/mall/en/en/Catalog/product?mlfb=3SU1050-4GC01-0AA0>

**Cax online generator**

<http://support.automation.siemens.com/WW/CAXorder/default.aspx?lang=en&mlfb=3SU1050-4GC01-0AA0>

**Service&Support (Manuals, Certificates, Characteristics, FAQs,...)**

<https://support.industry.siemens.com/cs/ww/en/ps/3SU1050-4GC01-0AA0>

**Image database (product images, 2D dimension drawings, 3D models, device circuit diagrams, EPLAN macros, ...)**

[http://www.automation.siemens.com/bilddb/cax\\_de.aspx?mlfb=3SU1050-4GC01-0AA0&lang=en](http://www.automation.siemens.com/bilddb/cax_de.aspx?mlfb=3SU1050-4GC01-0AA0&lang=en)

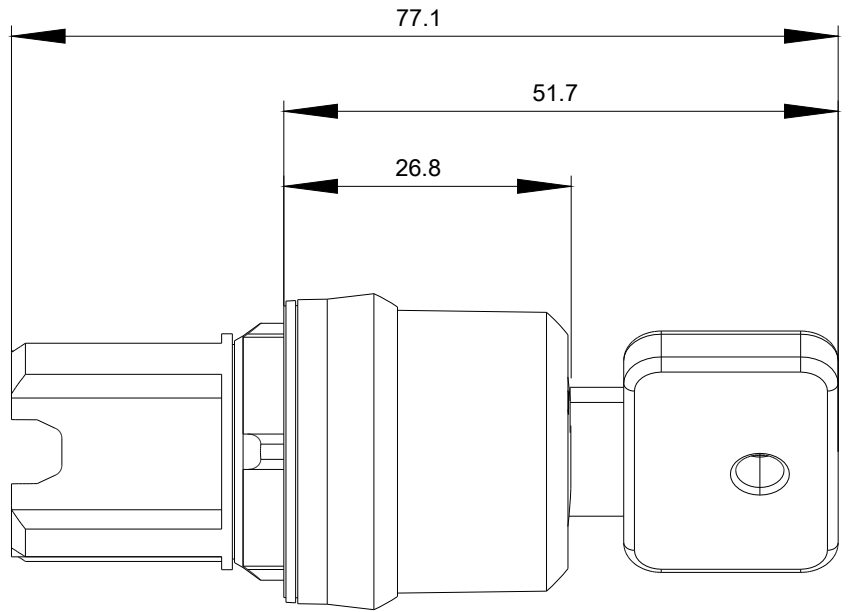
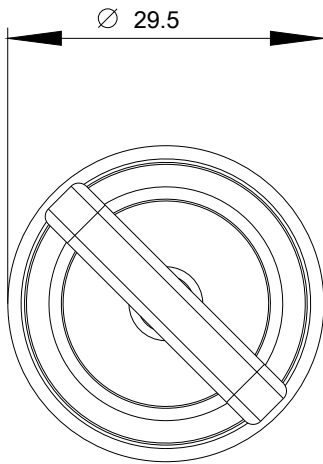

last modified:

10/31/2018