

THIS DOCUMENT IS SUBJECT TO CHANGE WITHOUT NOTICE. IT IS CONFIDENTIAL AND A PROPERTY OF AMPHENOL LTW. DISCLOSURE TO THIRD PARTY HAS TO BE AUTHORIZED BY AMPHENOL LTW.

REV.	ECN NO.	DATE	SIGN	DESCRIPTION

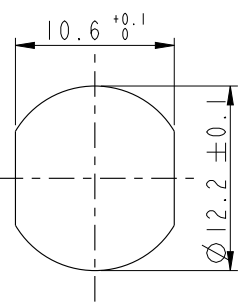

Recommended
Panel Cut-Out

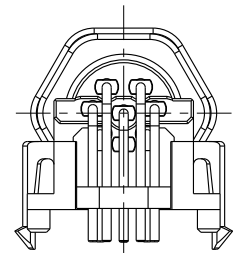
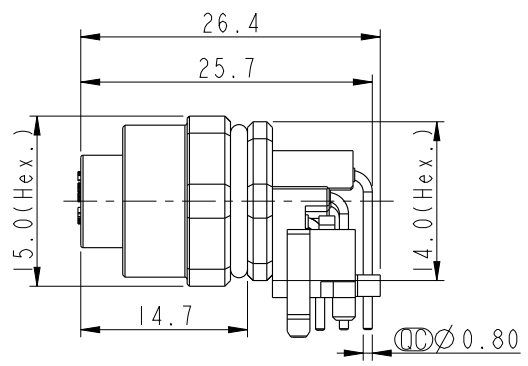
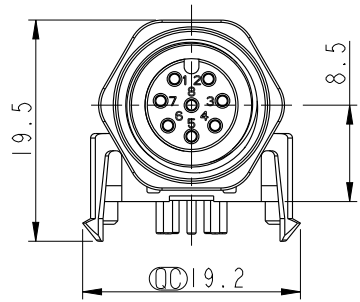
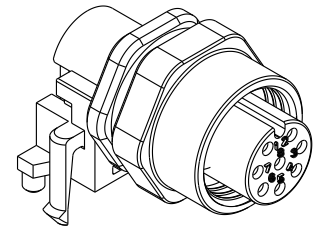
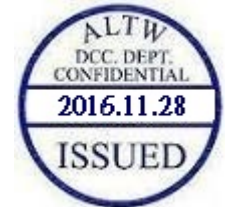
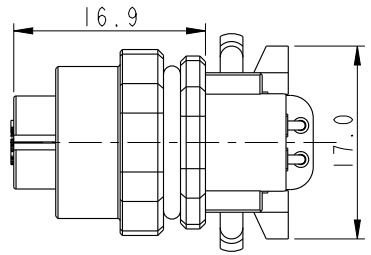
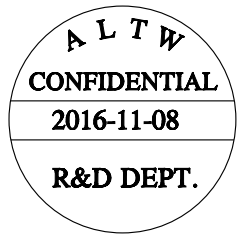

MI2A-03PFFR-SF7003
MI2A-04PFFR-SF7003
MI2A-05PFFR-SF7003
MI2A-08PFFR-SF7003
Item No.

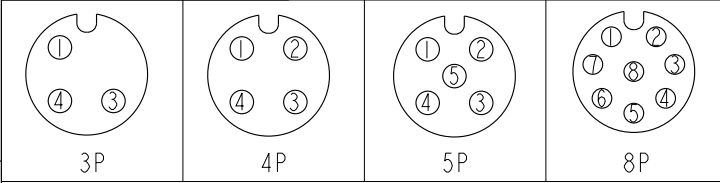

Pin Assignment Front View

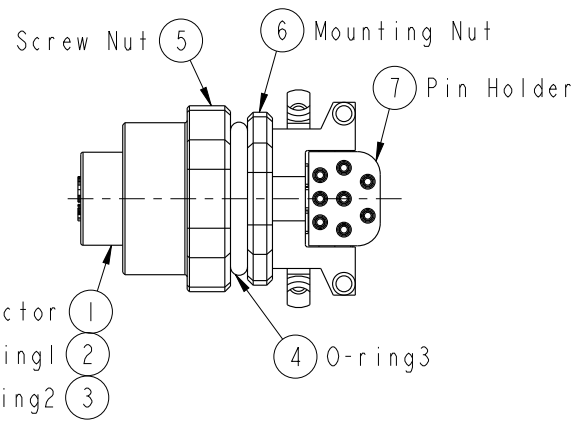

- Note:
- * \varnothing Important Dimension To Check.
 - * Waterproof Rating: IP67(Mated Waterproof)
 - * Connector: PBT+PC, Black
 - * Female Pins: Copper Alloy, Gold Plated
 - * Mounting Nut: Zinc Alloy, Nickel Plated
 - * Screw Nut: Zinc Alloy, Nickel Plated
 - * O-ring1: Silicon, Black
 - * O-ring2: Silicon, Gray
 - * O-ring3: Silicon, Gray
 - * Pin Holder: PBT+PC, Black
 - * Rated Voltage: 3 & 4Pin 250V dc. or ac.
5Pin 60V dc. or ac.
8Pin 30V dc. or ac.
 - * Rated Current: 3~5Pin 4A
8Pin 2A
 - * For Panel Thickness Max. 3.0mm
 - * For PCB Thickness Max. 1.5mm

UNIT:mm		TITLE	MI2, 90° Panel FCONN. FPIN (Mated Waterproof)	
TOLERANCE	.X ±0.25 .XX ±0.1 .XXX ±0.05 ANGLES ±1°	SCALE	3:2	SIZE A4
		REV.	A	WC-REV. A.2
				SHEET 1 OF 2
				QC: Inspection item

Amphenol LTW
安費諾亮泰企業股份有限公司

ITEM NO.	DRAWN BY	DATE
	Yulong_wang	2016-11-08
DWG NO.	CHECKED BY	DATE
MI2A-XXPFFR-SF7003	Jinhai	2016-11-08
CUSTOMER	APPROVED BY	DATE
ALTW	Jerry	2016-11-08

THIS DOCUMENT IS SUBJECT TO CHANGE WITHOUT NOTICE. IT IS CONFIDENTIAL AND A PROPERTY OF Amphenol LTW. DISCLOSURE TO THIRD PARTY HAS TO BE AUTHORIZED BY Amphenol LTW.

ALTW
CONFIDENTIAL
 2016-11-08
R&D DEPT.

ALTW
 DCC. DEPT.
 CONFIDENTIAL
 2016.11.28
ISSUED

M 12A - XX P F F R - S F 7 003

12A: A-Code

03: 3Pin
 04: 4Pin
 05: 5Pin
 08: 8Pin

P: Panel (板端)

F: Female Connector (母座)

003: M12*1.0

7: IP67 (防水等級67)

F: Front Fasten (前鎖式/Enclosure Rear Mount)

S: Screw (螺紋式)

R: 90° PCB THT/DIP Type (90° 基板插件式)

F: Female Pin (母Pin)

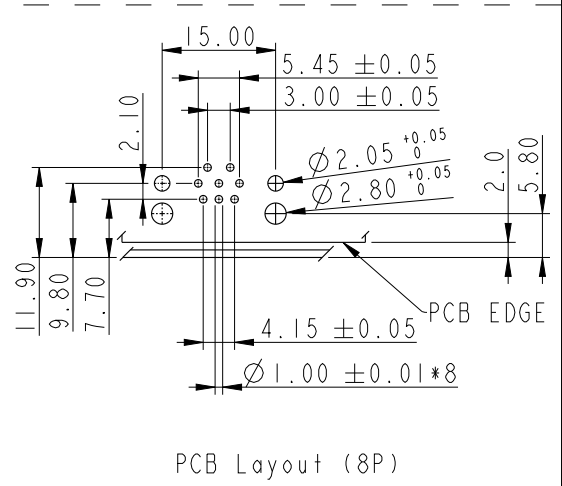
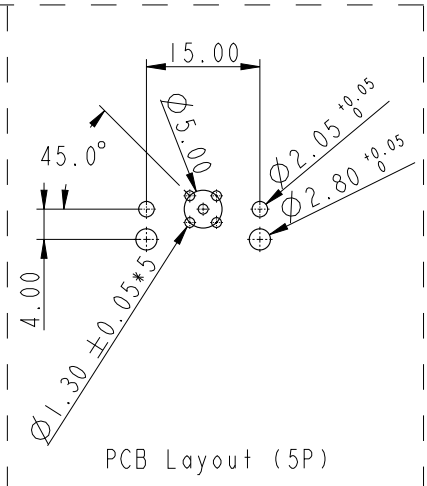
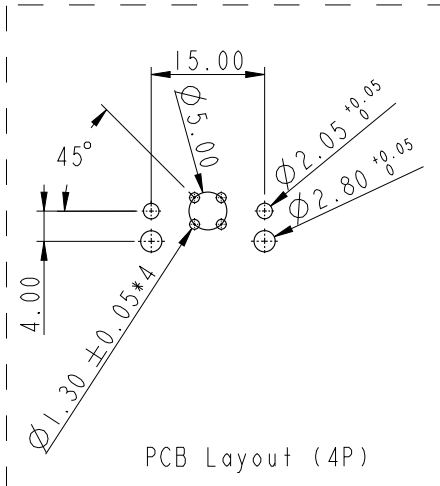
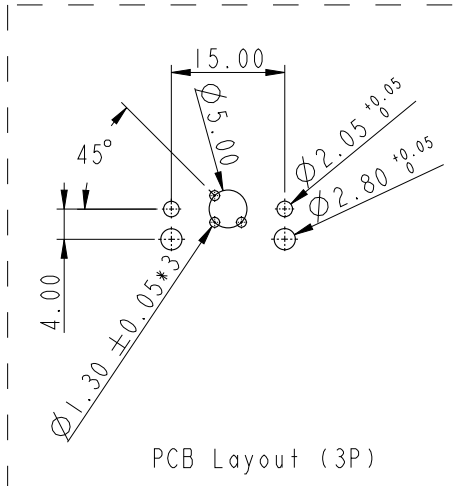

UNIT: mm		
TOLERANCE	.X ±0.25	
.XX ±0.1		
.XXX ±0.05		
ANGLES	±1°	

TITLE M12, 90° Panel FCONN. FPIN (Mated Waterproof)			
SCALE 3:2	SIZE A4	SHEET 2 OF 2	
REV. A	WC-REV. A.2	QC: Inspection item	

Amphenol LTW
 安費諾亮泰企業股份有限公司

ITEM NO	DWG NO	CUSTOMER
	M12A-XXPFFR-SF7003	ALTW

DRAWN BY Yulong_wang	CHECKED BY Jinhai	APPROVED BY Jerry
-------------------------	----------------------	----------------------

DATE 2016-11-08	DATE 2016-11-08	DATE 2016-11-08
--------------------	--------------------	--------------------