

Crimp Contacts for Socket Connectors (S)

AWG 28–20 0.08–0.56 mm²

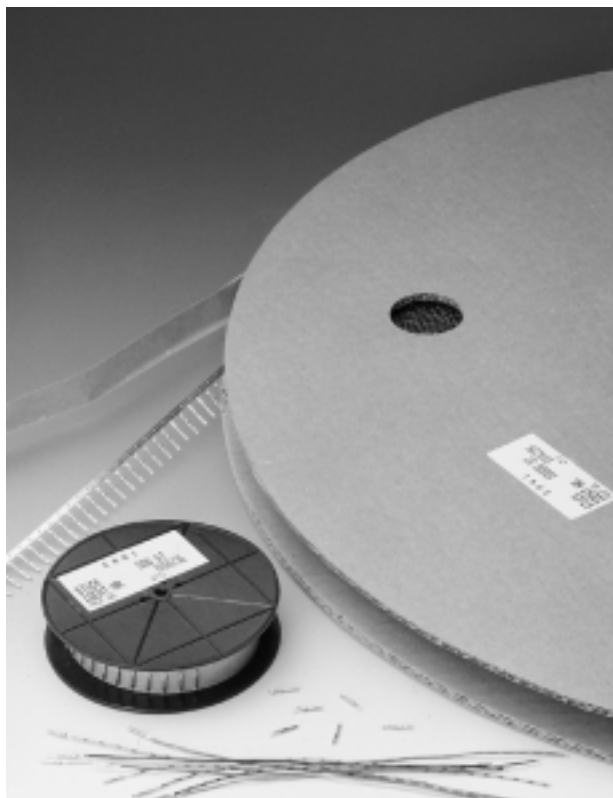

Delivered as:

Loose contacts

Reels with 500 contacts for hand crimping tool

Reels with 10.000 contacts for automatic crimper

Dimensional Drawings

Crimp contacts for Socket Connectors (S)

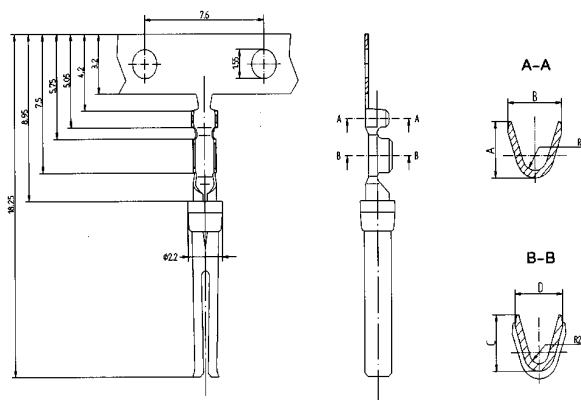

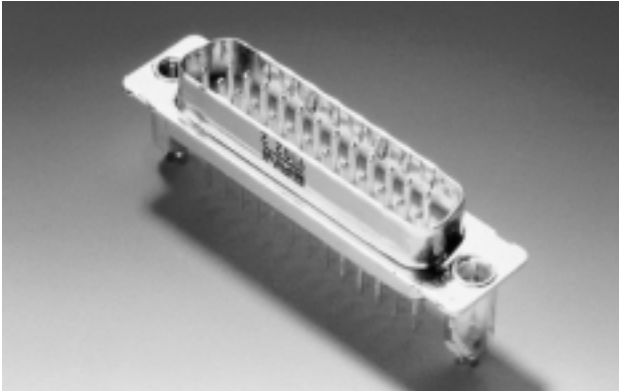

Tinned metal housings and laminated ground contacts

The metal housings on the TMC connectors (standard versions) from ERNI are tinned so as to achieve better contact for the chassis connection. Specially punched grooves on the metal protective collar of the male connectors ensure reliable contact. Together with the ERNI connector housings in the metallized version and grounding accessories on the connectors an optimal electromagnetically compatible application is achieved.

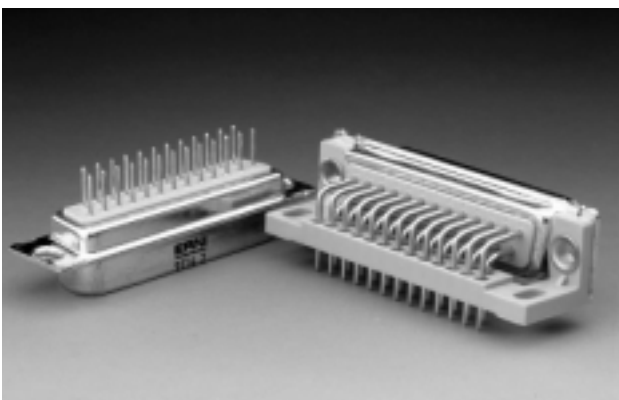

Solid punched male contacts

Due to a special manufacturing process we are in a position to offer solid punched male contacts. These versions have a tinned terminal zone and are suitable for a current-carrying capacity of up to 7.5 A.

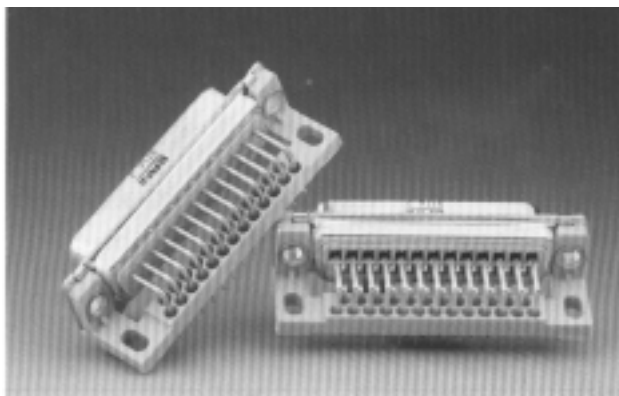

Guide frame for angled connectors

For mounting purposes and better guidance of angled TMC connectors with pins for dip-soldering the standard versions are equipped with a guide frame made of plastic.

With this guide frame the connectors can be screwed or riveted onto PC Boards.

Versions with a guide frame and mounting clip are clipped into the pc boards and soldered in place



Connector housings for TMC connectors

ERNI has also developed connector housings for Series TMC interface connectors.

- **KSG 183 housing with engagement locking**
- **KSG 184 housing with slide locking**
- **KSG 185 housing with engagement and/or screw locking, integrated coding**

These two-shell connector housings are also available in metallized versions. Together with the ERNI TMC connectors, which have laminated ground contacts, screening is optimized.