

## 2 Bolt Pillar bearings SL Series – Metric

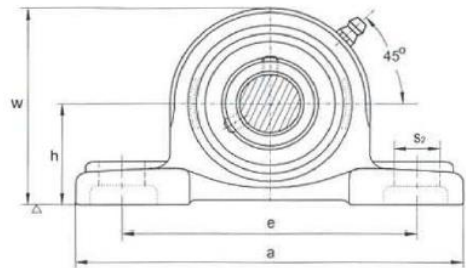
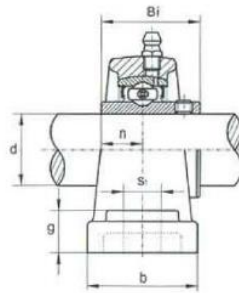

RS Article no.	Bearing unit No.	Shaft Dia.	Dimension (mm)											Bolt used (mm)	Bearing No.	Housing No.	Weight (kg)
		d (mm)	h	a	e	b	s <sub>2</sub>	s <sub>1</sub>	g	w	Bi	n					
7508933	UCP201	12	30.2	127	95	38	16	13	14	62	31.0	12.7	M10	UC 201	P 201	0.63	
7508936	UCP202	15	30.2	127	95	38	16	13	14	62	31.0	12.7	M10	UC 202	P 202	0.63	
7508949	UCP203	17	30.2	127	95	38	16	13	14	62	31.0	12.7	M10	UC 203	P 203	0.63	
7508946	UCP204	20	33.3	127	95	38	16	13	14	65	31.0	12.7	M10	UC 204	P 204	0.65	
7508952	UCP205	25	36.5	140	105	38	16	13	15	71	34.0	14.3	M10	UC 205	P 205	0.79	
7508964	UCP206	30	42.9	165	121	48	20	17	17	83	38.1	15.9	M14	UC 206	P 206	1.30	
7508977	UCP207	35	47.6	167	127	48	20	17	18	93	42.9	17.5	M14	UC 207	P 207	1.60	
7508974	UCP208	40	49.2	184	137	54	20	17	18	98	49.2	19.0	M14	UC 208	P 208	2.00	
7508983	UCP209	45	54.0	190	146	54	20	17	20	106	49.2	19.0	M14	UC 209	P 209	2.20	
7508986	UCP210	50	57.2	206	159	60	23	20	21	114	51.6	19.0	M16	UC 210	P 210	2.80	
7508999	UCP211	55	63.5	219	171	60	23	20	23	126	55.6	22.2	M16	UC 211	P 211	3.40	
7508992	UCP212	60	69.8	241	184	70	23	20	25	138	65.1	25.4	M16	UC 212	P 212	4.80	
7509009	UCP213	65	76.2	265	203	70	28	25	27	151	65.1	25.4	M20	UC 213	P 213	5.70	
7509002	UCP214	70	79.4	266	210	72	28	25	27	157	74.6	30.2	M20	UC 214	P 214	7.00	
7509006	UCP215	75	82.6	275	217	74	28	25	28	163	77.8	33.3	M20	UC 215	P 215	7.60	