**NKXR45-Z-XL**

## Needle roller/axial cylindrical roller bearing

Needle roller/axial cylindrical roller bearings  
NKXR...-Z, axial component, single direction,  
to DIN 5429, with end cap, for grease  
lubrication

**X-life**

## Technical information

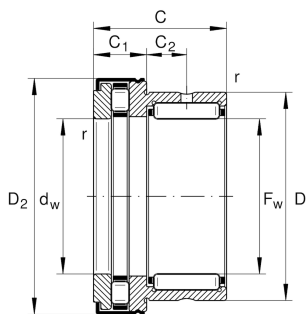
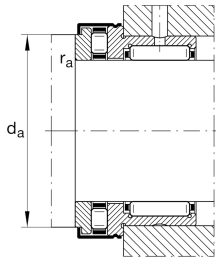

## Your current product variant

Sealing	Z	Bearing with end cap
Tolerance class	PN	Normal (PN)

## Main Dimensions &amp; Performance Data

$F_w$	45 mm	Bore diameter
D	58 mm	Outside diameter
C	32 mm	Height
$C_r$	31,000 N	Basic dynamic load rating, radial
$C_{0r}$	53,000 N	Basic static load rating, radial
$C_a$	59,000 N	Basic dynamic load rating, axial
$C_{0a}$	163,000 N	Basic static load rating, axial
$C_{ur}$	9,400 N	Fatigue load limit, radial
$C_{ua}$	16,300 N	Fatigue load limit, axial
$n_G$	5,000 1/min	Limiting speed
$n_{gr}$	1,900 1/min	Reference speed
$\approx m$	259.89 g	Weight

## Mounting dimensions

$d_a$	60.6 mm	Mounting dimension shaft shoulder
$r_{a \max}$	0.6 mm	Maximum recess radius



Dimensions

D 2 max	66.5 mm	Maximum outside diameter flange
C 1	14 mm	Width of the axial brearing component
C 2	9 mm	Distance to lubrication hole
d w	45 mm	Bore diameter of shaft washer
r min	0.6 mm	Minimum chamfer dimension

Temperature range

T min	-30 °C	Operating temperature min.
T max	120 °C	Operating temperature max.

Additional information

IR40X45X20-XL	Suitable inner rings IR
---------------	-------------------------

Characteristics

	Radial load
	Axial load in one direction
	Grease Lubrication
	Sealed on one side