

DOUBLE BOX END (METRIC)

PART NO.	SIZE MM	L MM	F1 MM	F2 MM			G.W. (kg)
42221	5.5x7	169.0	11.0	13.1	6	36	3.2
42213	6x7	170.0	10.5	12.8	6	36	3.3
42214	8x9	185.0	14.3	15.0	6	36	3.6
42201	8x10	185.0	14.3	16.3	6	36	3.4
42222	9x11	204.0	15.8	18.4	6	36	4.1
42215	10x11	195.0	16.3	18.4	6	36	4.5
42202	10x12	195.0	16.3	18.4	6	36	4.0
42203	11x13	205.0	18.4	20.8	6	36	4.4
42216	12x13	220.0	18.4	20.8	6	36	6.0
42204	12x14	220.0	19.8	21.8	6	36	5.4
42223	13x15	241.0	22.0	24.3	6	36	5.6
42224	13x16	243.0	22.2	24.4	6	36	5.7
42217	14x15	235.0	20.8	23.0	6	36	7.0
42205	14x17	235.0	21.8	25.8	6	36	6.0
42218	16x17	235.0	24.0	26.3	6	36	7.2
42219	16x18	260.0	26.1	27.1	6	36	7.0
42206	17x19	250.0	26.3	27.8	6	36	8.1
42207	19x21	270.0	27.8	30.8	4	24	7.2
42220	19x22	281.0	27.4	32.2	4	24	8.3
42208	21x23	290.0	30.8	33.3	4	24	8.3
42209	22x24	320.0	32.2	34.3	4	24	10.4
42210	23x26	360.0	34.1	37.3	4	24	12.1
42211	24x27	360.0	34.1	37.3	4	24	12.1
42225	27x30	397.0	38.8	42.9	4	24	15.6
42212	30x32	437.0	43.3	47.1	4	24	19.3

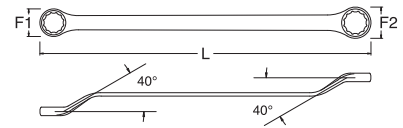

ANSI B107.9M DIN 838

QUICK COMBINATION (METRIC)

PART NO.	SIZE MM	L MM	A BOX END			G.W. (kg)
43401	8	140.0	13.0	6	96	4.8
43402	9	149.0	15.0	6	36	2.4
43403	10	159.0	16.0	6	36	2.7
43404	11	165.0	17.0	6	36	2.8
43405	12	171.0	18.0	6	36	3.2
43406	13	178.0	20.0	6	36	3.6
43407	14	190.0	21.0	6	36	4.1
43408	15	199.0	23.0	6	36	5.0
43409	16	208.0	24.0	6	36	5.5
43410	17	225.0	26.0	6	36	5.9
43411	18	236.0	27.0	6	36	6.6
43412	19	248.0	28.0	6	36	7.5

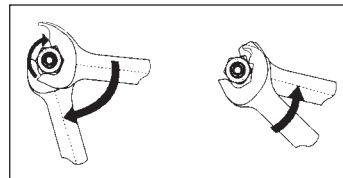

The special open end design of the Speedy Combination Wrench lets you quickly "ratchet" around a fastener to reposition without removing the wrench.

E-TORX®

PART NO.	SIZE	★ (MM)	L MM	F1 MM	F2 MM			G.W. (kg)
45201	E6 X E8	5.74X7.52	112	4.8	5.8	6	96	4.2
45202	E10 X E12	9.42X11.17	140	6.8	8.0	6	96	5.6
45203	E14 X E18	12.90X16.70	180	7.9	9.5	6	36	3.7
45204	E20 X E24	18.45X22.16	224	11.0	13.0	6	36	7.1

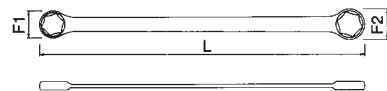

ADJUSTABLE WRENCH

PART NO.	SIZE INCH	L MM	a MM	T MM			G.W. (kg)
47201	4"	111.5	13	8.6	6	36	3.6
47202	6"	164.0	20	9.6	6	36	6.8
47203	8"	211.0	24	12.4	6	90	7.4
47204	10"	261.0	29	14.6	6	48	22.6
47205	12"	311.0	34	17.5	4	40	12.9
47206	15"	388.0	44	20.2	3	6	9.1
47207	18"	470.0	55	26.2	6	36	3.2
47208	24"	610.0	65	31.0	6	36	3.6



ANSI B107.8M
DIN 3117

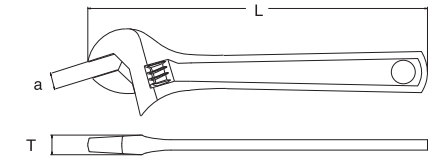

ADJUSTABLE WRENCH WITH DIPPING GRIP

PART NO.	SIZE INCH	L MM	a MM	T MM			G.W. (kg)
47221	4"	110.7	13	8.6	6	252	3.9
47222	6"	163.3	20	10.5	6	36	7.1
47223	8"	211.0	25	12.8	6	90	7.6
47224	10"	261.0	30	15.0	6	48	22.9
47225	12"	313.0	35	18.0	4	40	12.7
47226	15"	394.5	44	20.2	3	6	9.2



ANSI B107.8M
DIN 3117

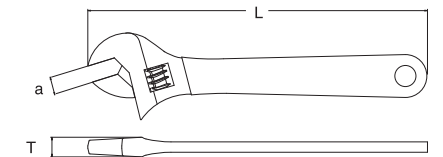

DOUBLE SOCKET RATCHET HANDLE (METRIC)

PART NO.	SIZE MM	D MM	d1 MM	d2 MM	T MM	e MM	L MM			G.W. (kg)
47301	10X12	32	14	16.5	15.7	38	235	2	12	3.2
47304	11X13	32	16.5	19.0	15.7	38	235	2	12	3.2
47305	12X14	32	16.5	19.0	15.7	38	235	2	12	3.2
47308	14X17	35	20	23.5	17.0	45	270	2	12	4.1
47309	17X19	42	24	26.0	18.8	50	312	2	12	5.7
47310	17X21	42	24	28.0	18.8	50	312	2	12	5.7
47312	19X21	42	26	28.0	18.8	50	312	2	12	5.7
47317	21X26	51	28	35.0	21.0	56	355	2	12	10.0
47319	22X24	51	30	32.5	21.0	56	355	2	12	10.0
47321	24X27	53	32.5	36.5	21.0	56	362	2	12	10.0

