

MRIG Series - Multi Role Industrial Gearhead

The MRIG series spur gearheads have been designed for use in heavy duty instrumentation or light duty industrial drive applications. The combination of a hardened metal spur gear train coupled with precision die-cast housing results in a robust design with a high torque transmission capability.

Key features:

- Suitable for use on a wide range of motors; AC synchronous, DC brushed or brushless, steppers and servos
- Low cost due to advanced design and optimised manufacturing techniques
- A wide range of gear ratios
- Heavy duty sleeve bearing as standard. Ball Race available if specified
- Steel gears and pinions with carefully selected hardness grades ensure a high torque transmission capacity
- The robust precision die cast housing provides long life and excellent durability in industrial installations

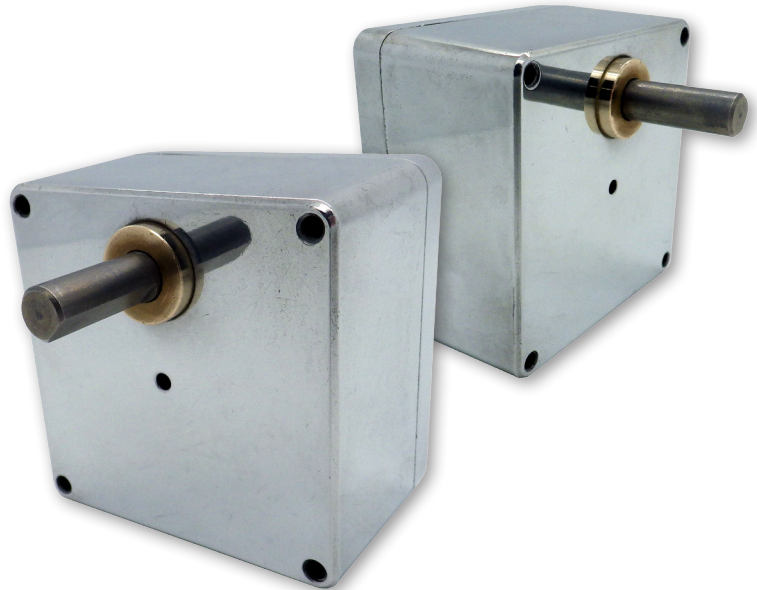

Standard Gear Ratios

| Order code | Gear ratio | Number of stages | Direction of rotation** | Maximum continuous output torque | Maximum intermittent output torque | Efficiency |
|------------|------------|------------------|-------------------------|----------------------------------|------------------------------------|------------|
| | | | | Nm | Nm | |
| MRIG02* | 5:1 | 3 | Opposite | 2 | 3 | 72 |
| MRIG06* | 25:2 | 3 | Opposite | 2 | 3 | 72 |
| MRIG11* | 25:1 | 4 | Same | 3 | 4.5 | 65 |
| MRIG17* | 50:1 | 4 | Same | 3 | 4.5 | 65 |
| MRIG22* | 100:1 | 5 | Opposite | 3 | 4.5 | 58 |
| MRIG23* | 125:1 | 5 | Opposite | 4 | 6 | 58 |
| MRIG27* | 250:1 | 6 | Same | 4 | 6 | 52 |
| MRIG34* | 500:1 | 6 | Same | 4 | 6 | 52 |

** Direction of rotation of Output compared to Input

Note*

Add 'S' for standard sleeve bearings on output shaft
Add 'B' for ball race option



Mechanical specification:

Outline dimensions (mm)

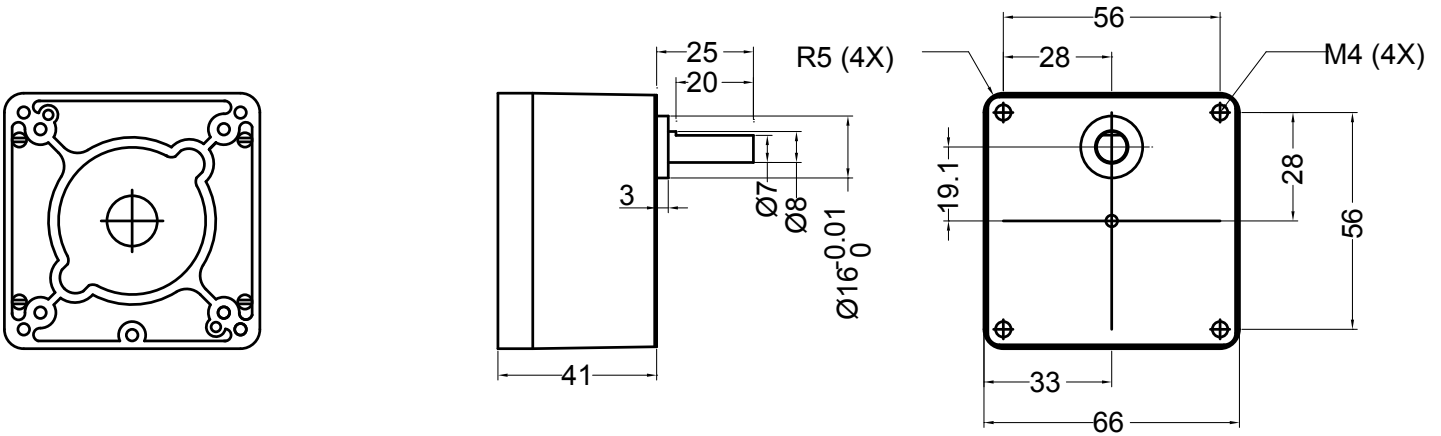

A Ballrace Bearing adds "B" to the part number.

Fitting kits for MRIG

| Motor types | Description | Part number |
|------------------------------------|---|-------------|
| Nema 16 & 17 Series | MRIG to 17 Adaptor kit | 400MAX00050 |
| Nema 23 Series | MRIG to 23 Adaptor kit | 400MAX00055 |
| 9904 120 15/16 Series | MRIG to 40mm Adaptor kit | 400MAX00073 |
| M66 Series BLDC58 Series | MRIG to M66/BLDC58 Adaptor kit | 400MAX00054 |
| BLDC48 Series | MRIG to BLDC48 Adaptor kit | 400MAX00064 |
| 57/60L Series | MRIG to 57/60L Adaptor Kit | 400MAX00071 |
| S57/S60L Series MV86 111 Series | MRIG to S57/S60L and MV86 111 Adaptor kit | 400MAX00072 |

| Pinion Code | Bore Diameter (mm) |
|-------------|--------------------|
| 202GMP00015 | 3 |
| 202GMP00016 | 4 |
| 202GMP00017 | 5 |
| 202GMP00018 | 6 |
| 202GMP00019 | 6.35 |

