

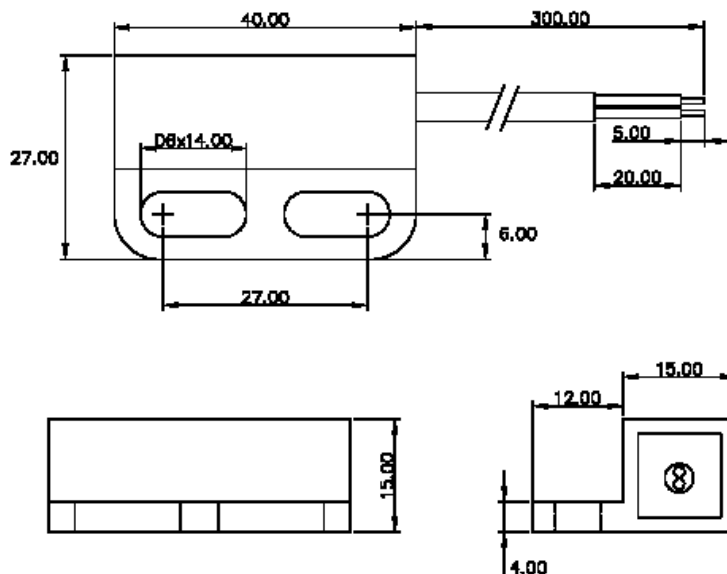

ENGLISH

Datasheet

RS Pro Ferrous Metal Sensor – Non powered



Specifications

- Normally open contacts that close in the presence of a ferrous metal
- 6mm activation distance (may vary depending on iron content)
- Switching voltage 140 Volts AC, 200 Volts DC
- Maximum switching load 10 Watts, 0.25 Amps
- Operating Temperature -40° to 85°C
- ABS housing material
- 2 x 0.14mm² Grey PVC insulated, brown/white cable
- Front Sensing Target