

Single-flash light element, w. built-in electronic flash, red, 230 V AC,  
Diameter 70 mm



Figure similar

General technical data	
Product brand name	SIRIUS
Product designation	Flashlight element
Design of the optical signal	flash light
Type of voltage of the operating voltage	AC
Operating voltage	
• 1 at AC at 50 Hz rated value	230 V
• 1 at AC at 60 Hz rated value	230 V
Relative positive tolerance of the operating voltage	10 %
Relative negative tolerance of the operating voltage	-10 %
Color	red
Mounting type	Bayonet
Reference code	
• acc. to DIN EN 61346-2	P
• acc. to DIN EN 81346-2	P
Mechanical data	
Outer diameter of the signal column element	70 mm

Lamp	
Product component Light source	Yes
Type of light source	Xenon gas discharge lamp
Flash frequency	1 Hz
Number of flashes of light element	4 000 000
Light intensity	12 265 cd

Ambient conditions	
Ambient temperature during operation	-20 ... +50 °C
Protection class IP	IP65
Height	65.5 mm
Width	70 mm

Certificates/approvals			
General Product Approval	EMC	Declaration of Conformity	other



[Confirmation](#)

### Further information

**Information- and Downloadcenter (Catalogs, Brochures,...)**

<http://www.siemens.com/industrial-controls/catalogs>

**Industry Mall (Online ordering system)**

<https://mall.industry.siemens.com/mall/en/en/Catalog/product?mlfb=8WD4450-0CB>

**Cax online generator**

<http://support.automation.siemens.com/WW/CAXorder/default.aspx?lang=en&mlfb=8WD4450-0CB>

**Service&Support (Manuals, Certificates, Characteristics, FAQs,...)**

<https://support.industry.siemens.com/cs/ww/en/ps/8WD4450-0CB>

**Image database (product images, 2D dimension drawings, 3D models, device circuit diagrams, EPLAN macros, ...)**

[http://www.automation.siemens.com/bilddb/cax\\_de.aspx?mlfb=8WD4450-0CB&lang=en](http://www.automation.siemens.com/bilddb/cax_de.aspx?mlfb=8WD4450-0CB&lang=en)

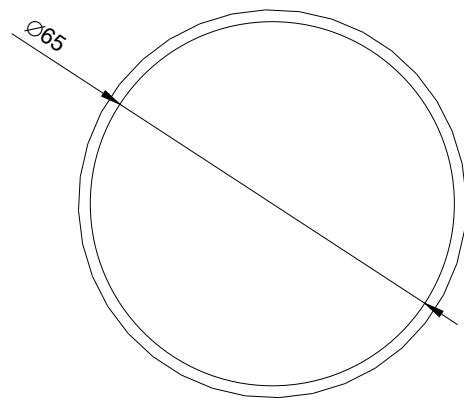
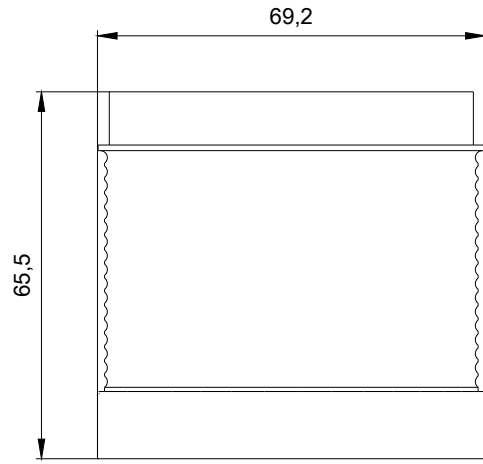

last modified:

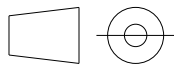

WS 4444;  
W6.8333; 8WD44...\_ALL  
11/13/2018