

# Datasheet

## High Pressure Two-way Ball Valves

### Carbon Steel

Two-way ball valves with yellow Zinc-passivated carbon steel body suitable for use with water or oil. The ball valves incorporate a brass ball, Nitrile stem seal, and are suitable for use with pressures ranging from 350 to 500 bar (refer to table for specific maximum pressure dependent on type).

#### Technical Features

- BSP parallel ("G") thread
- Carbon steel (11SMn28K) body; yellow Zinc-passivated
- Ball seal: POM-MoS2
- Stem seal: Nitrile rubber
- Suitable for temperature ranges from: -20 to +100°C

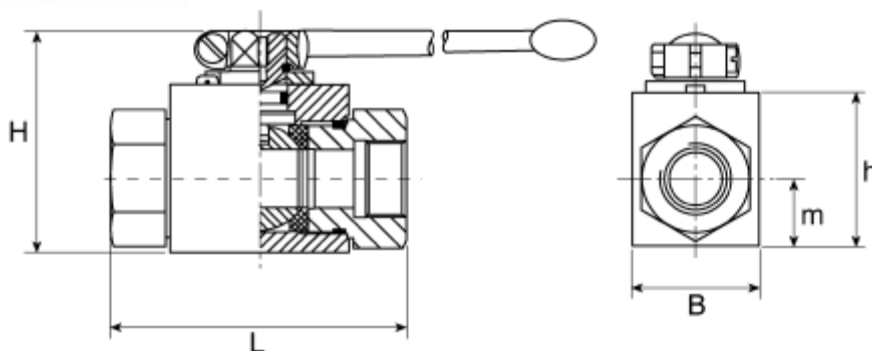
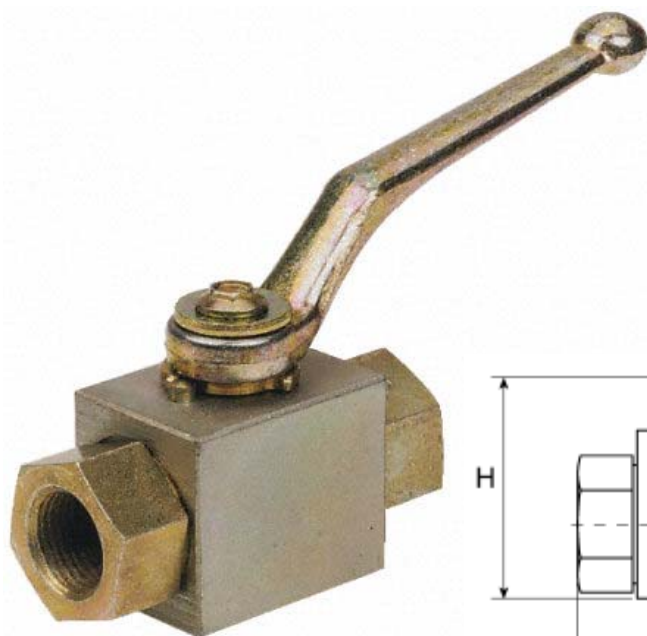

#### Pressures and Dimensions

RS Article Number:	Description	Maximum Pressure	H	L	B	m	h
297-5827	G 1/4 Two-way Steel Ball Valve	500 bar	47mm	69mm	26mm	13.5mm	33mm
297-5833	G 3/8 Two-way Steel Ball Valve	500 bar	52mm	72mm	32mm	17.5mm	38mm
297-5849	G 1/2 Two-way Steel Ball Valve	500 bar	54mm	83mm	35mm	19mm	40mm
297-5861	G 3/4 Two-way Steel Ball Valve	400 bar	75mm	95mm	49mm	24.5mm	57mm
297-5877	G 1 Two-way Steel Ball Valve	350 bar	83mm	113mm	58mm	29.5mm	65mm