

Features

- Double Shut Off
- Ball Lock
- Operating Temperature from -40 °C to +105 °C
- ISO 16028
- Stainless Steel 316
- Interchangeable:

Stucchi
Tema
ISO 16028

RS PRO Hydraulic Quick Connect Couplings

RS Stock No.: 0727366



RS PRO is the own brand of RS. The RS PRO Seal of Approval is your assurance of professional quality, a guarantee that every part is rigorously tested, inspected, and audited against demanding standards. Making RS PRO the Smart Choice for our customers.

Product Description

These RS PRO couplings are compliant with ISO 16028 are designed for demanding hydraulic applications where leak-free performance and contamination control are critical. These hydraulic flat face quick couplings are the most popular types of quick hydraulic couplings due to lack of fluid spillage after disconnection and ease of cleaning, both strictly related to the flat face design of the sealing valves; the connection and disconnection mode is also comfortable and user-friendly.

Sleeve: Hardened and solid barstock construction for a quality coupling giving maximum resistance to damage from hydraulic or mechanical shock. Performs as spring loaded “locking Latch”.

Safety Sleeve Lock: When the coupling is dragged along the ground to prevent accidental disconnection. Sleeve is rotated to engage the lock.

Locking Balls: A large number of locking balls distribute the workload evenly while providing alignment to reduce hose torque and prolong hose life.

Applications:

- Industrial manufacturing
- Mobile equipment
- Agricultural equipment
- Construction
- Oil and gas extraction and exploration
- HVAC applications
- And many other industrial processes

Interchangeability:

- Stucchi
- Tema
- EAS CQ
- ISO 16028

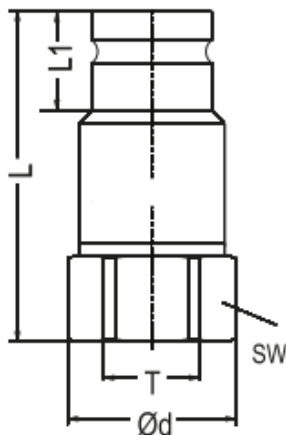

Female Threaded Plug

T Connection	SW (mm)	ØD (mm)	L (mm)
G 1"	46	24	84

Specifications

Manufacturer Series	72
Standards Met	ISO 16028
Compatible with	Stucchi Tema ISO 16028
Maximum Operating Pressure	270 Bar
Minimum Operating Temperature	-40 °C
Maximum Operating Temperature	+105 °C
Type	Coupling Plug
Locking Style	Ball Lock
Double Shut Off	Double Shut Off
Thread Size	1 in
Thread Standard	G
Thread Gender	Female
Coupling Gender	Male
Thread	G 1 in Female
Material	Stainless Steel 316
Finish	AISI 303
Seal Material	Nitrile Rubber
Sleeve Material	AISI 316
Valve Material	AISI 316
Spring Material	14310
Locking O Ring Material	Nitrile Rubber
Ball Material	AISI-316

