

VERDERFLEX[®]

OEM



M025 PERISTALTIC PUMP

MODEL: M025 d.c.

Combining a robust pump head design with a quality d.c. Gear motor provides 12vdc use with flow rates of up to 240 ml/min

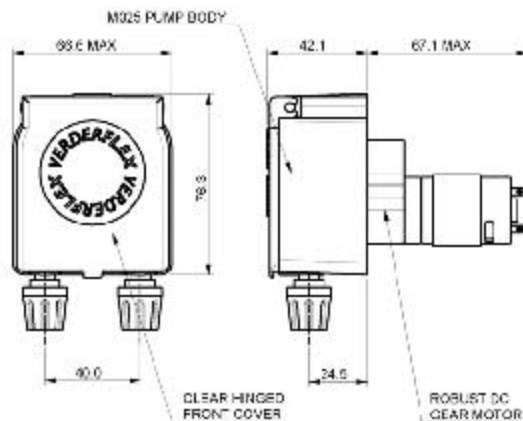

- Pump head : Polycarbonate/ABS blend Cycoloy with clear-hinged polycarbonate cover
- Gear motor : Permanent magnet with spur gearbox and ball race bearings on output shaft
- Rotor : 2 roller design with guide rollers
- Power Supply : 12 vdc 6VA
- Tube materials : Verderprene, Silicone
1.6, 3.2 & 4.8 x 1.6mm Wall
- Tube Connectors : Black food grade Polypropylene to suit:
4mm I/D x 6mm O/D (4x6)
6mm I/D x 9mm O/D (6x9)
External tubing
- Weight : 0.3Kg

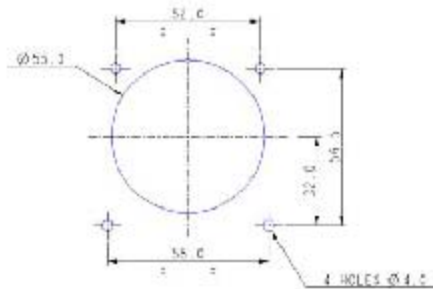

Panel cut-out detail
Use No.6 x 9.5 lg (plus panel)
Self tapping screw

M025 pump d.c.			
Nominal flow rate ml/min			
Tube	1.6mm	3.2mm	4.8mm
15 rpm	3.75 ml/min	9.25 ml/min	30 ml/min
30 rpm	7.5 ml/min	18.5 ml/min	60 ml/min
60 rpm	15 ml/min	37 ml/min	120 ml/min
120 rpm	30 ml/min	74 ml/min	240 ml/min

Verder Ltd
Unit 7 Carnival Park, Carnival Close, Basildon, SS14 3WN
Tel: +44 (0) 1288 862 450, Fax: +44 (0) 1288 862 459
Email: Basildon@verderflex.com

VERDER

www.verderflex.com