

Datasheet

RS PRO Bearing Tab Washer 10 Pack

Stock No: 1964190



Technical Specifications:

| | |
|-------------------|--------------|
| | |
| Id (mm) | 30 |
| Od (mm) | 49 |
| Width (mm) | 1.8 |
| Material | Steel |

Features & Benefits:

Locking washer engage a groove in the shaft and locknut in position.

Locking washers of the MB design are used when a washer with increased strength is needed.

The locking washers are made of deep drawn steel strip.

Dimensional line drawings

Dimensions

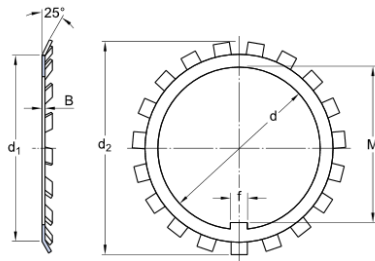

| | | |
|----------------|------|----|
| d | 30 | mm |
| d ₁ | 38 | mm |
| d ₂ | 49 | mm |
| B | 1.25 | mm |
| f | 5 | mm |
| M | 27.5 | mm |

Mass

Mass lock washer

0.008 kg