

## Features

- Small size, max height 76mm
- 1s transmission rate
- Bluetooth transmission greater than 20m
- CR2032 battery powered
- Typical battery life 12 months
- Secure screw cap for quick & easy battery changing
- $\pm 0.5\%$ FS accuracy
- 3 x 1.5Vdc AAA battery supply
- Compact and Rugged IP67
- Low cost, cable free pressure monitoring solution

## RS PRO Pressure Sensor

RS Stock No.: 0315690, 0315691, 0315693,  
0315694, 0315695



RS PRO is the own brand of RS. The RS PRO Seal of Approval is your assurance of professional quality, a guarantee that every part is rigorously tested, inspected, and audited against demanding standards. Making RS PRO the Smart Choice for our customers.

## Product Description

Watchlog Bluetooth compact pressure sensor

Cable-free pressure sensor with free monitoring and datalogging app available in the iOS App Store and Android Google Play store.

An extremely fast and easy way to add live pressure monitoring and datalogging to your system.

## Technical Specifications

<b>Pressure Ranges</b>	Negative/compound pressure	Vacuum to 16 bar
	Low pressure (on request)	0...0.1, 0...0.4, 0...0.6 bar
	Medium pressure	0...60, 0...250 bar
	High pressure	0...400, 0...700 bar
<b>Transmission rate</b>	1s	
<b>Overload capacity</b>	200% FS	
<b>Dimensions</b>	76 x 28 mm	
<b>Accuracy</b>	±0.5%FS	
<b>Long-term stability</b>	Typical ±0.25% FS/year	
<b>Operating temperature</b>	-20...65°C	
<b>Ambient temperature</b>	-40...80°C	
<b>Measuring medium</b>	Oil, water, gas and other stainless steel corrosion free medium	
<b>Pressure connection</b>	G1/4" BSP (alternative threads on request)	
<b>Connection material</b>	Sensor body 304L, wetted parts 316L	
<b>Shell material</b>	PA 66	
<b>Power supply voltage</b>	CR2032 battery fitted (12 months typical battery life)	
<b>Protection level</b>	IP65	
<b>Weight</b>	106g without CR2032 battery fitted	

## Dimensions

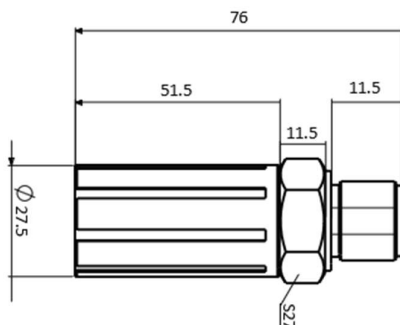

All dimensions in mm, +/-0.5mm

## Ordering Code

Article Number	Pressure Range
0315690	-1...16 bar
0315691	0...60 bar
0315693	0...250 bar
0315694	0...400 bar
0315695	0...700bar

## Electrical Specifications