

connectors for DIN rail profile

general

These components are analogous to the electric connectors found in control panels and used to rationalise cabling and trouble shooting.

Used alongside these electrical connectors the Legris DIN rail connectors provide similar facilities for pneumatic pipework mounted on the same profiled rail which allows electrics and pneumatics to run side by side. All tube connections are Legris push-in fittings for plastic tubing.

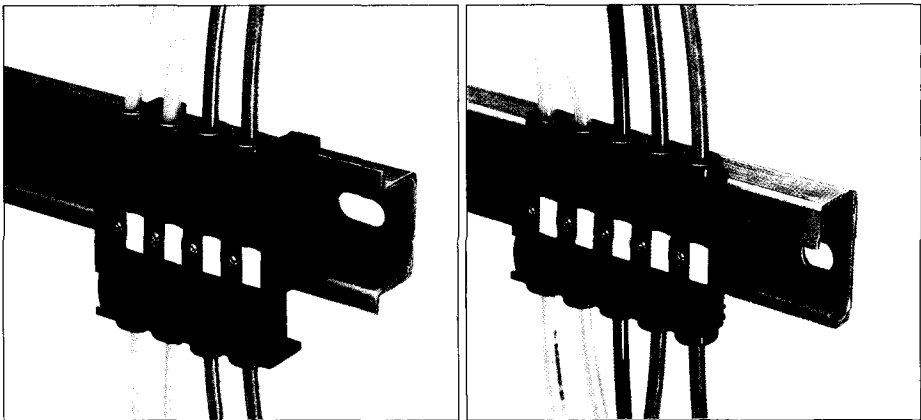

identification and trouble shooting

Tube identification

Channels or slots for labels are to be found on the visible faces of these connectors which allows air line tubes to be coded and identified to assist in trouble shooting.

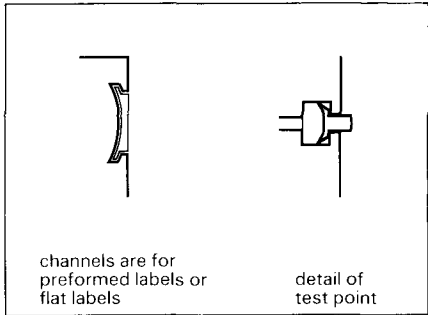

Testpoint facility

Being able to detect the presence of air is an important consideration when maintaining pneumatic control systems.

The Legris DIN rail connectors incorporate testpoints which pop out after being manually depressed, indicating the presence of air in that pipe.

3383 modular connectors for DIN rail profile

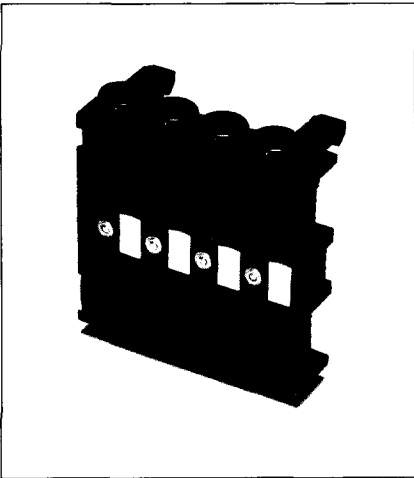

plastic body

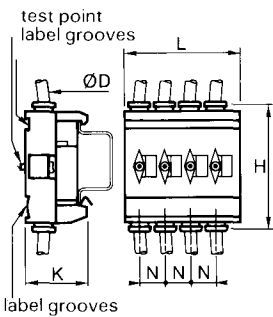

4 by 4 mm o.d.
2 by 6 and 8 mm o.d.

Ø D	H	K	L	N	kg
4	53	22,5	50	11	0,052
6	53	26	30	13,5	0,040
8	54	28	35	16	0,050

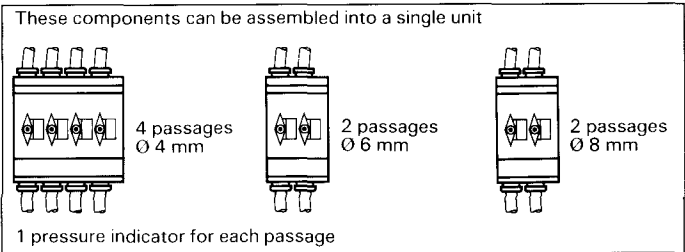

connectors for DIN rail profile \mathcal{L} or Ω

3379 connector for 2 tubes in line

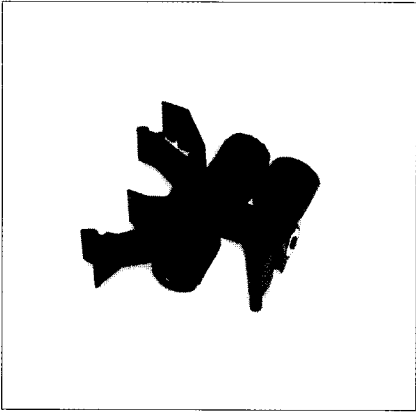

plastic body.

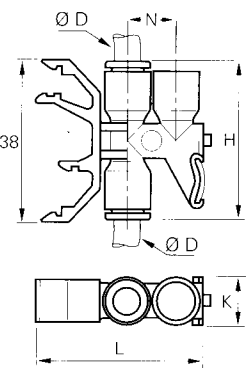

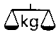
ØD	H	K	L	N	
4	34,5	11	39,5	11,5	0,029
6	34,5	11	39,5	11,5	0,036
8	46	13	44,5	14,5	0,048

Fixing by clipping

3381 connector for 3 tubes

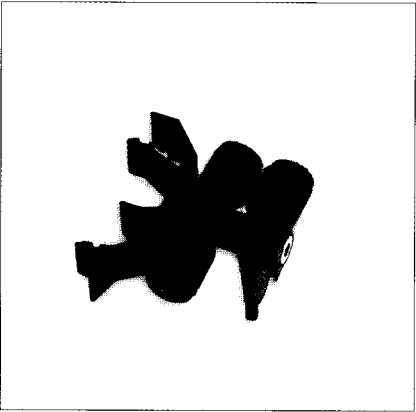

plastic body

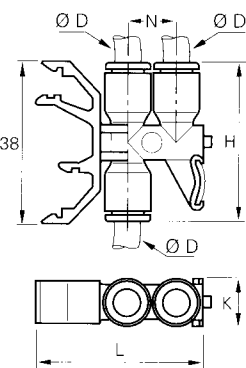

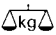
ØD	H	K	L	N	
4	36,5	11	39,5	11,5	0,027
6	36,5	11	39,5	11,5	0,033
8	46	13	44,5	14,5	0,043

Fixing by clipping

manifolds

Legris manifolds help to connect various components of a pneumatic system to single source of com-

pressed air. The centralized distribution assembly enables either the connection or maintenance of seve-

ral pneumatic circuits.

3310 manifold with LF 3000 push-in connection

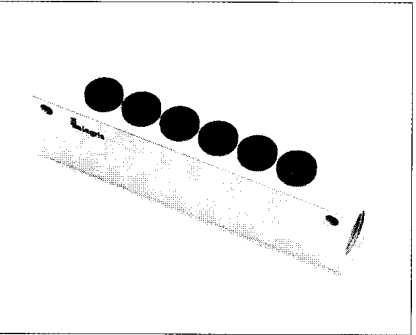

anodized aluminium

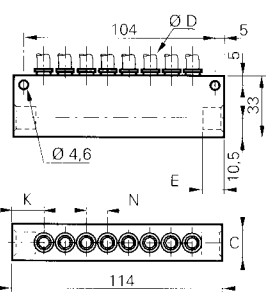

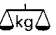
ØD C2	Number of outlets	E	K	N	
4 1/4	8	10	16,75	11,5	0,163
6 1/4	8	10	13,5	12,5	0,165
8 3/8	6	12	19	15	0,165

3311 manifold with threaded fitting

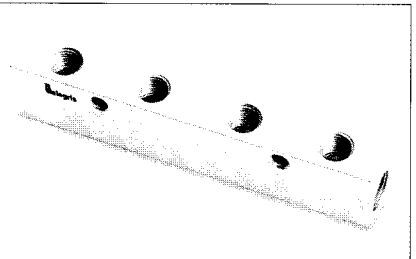

anodized aluminium

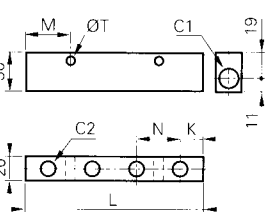

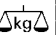
C1 C2	Number of outlets	K	L	M	N	T	
1/4 1/8	6	15	180	30	30	5,25	0,164
3/8 1/4	4	18	144	36	36	6,50	0,164