

Features

- Maximum operating pressure is 35 bar.
- Operating temperature range -20°C to +100°C.
- Material: Brass / Steel Nickel-Plated Finish
- Single Shut Off (One side is with valve)
- ISO 6150-B-12
- Industrial Interchangeable 1/4"
- US MIL STD. 4109 1/4"
- Flow 900 l/min
- Compatible with:
 - TST SWING COUPLING B1
 - Industrial interchange 1/4"
 - TST 024
 - PARKER - RECTUS 23
 - CEJN 310
 - HANSEN 3000
 - PARKER 20
 - ATLAS COPCO QIC 08
 - US-MIL-SPEC-C-4109

RS PRO Pneumatic Quick Connect Coupling

RS Stock No.: 0325553



RS PRO is the own brand of RS. The RS PRO Seal of Approval is your assurance of professional quality, a guarantee that every part is rigorously tested, inspected, and audited against demanding standards. Making RS PRO the Smart Choice for our customers.

Product Description

RS PRO Series 23 Quick Connect Couplings

Pneumatic quick-connect coupling connectors are found across industry in pneumatic systems as diverse as robotic assembly lines and other equipment.

- Maximum operating pressure is 35 bar.
- Operating temperature range -20°C to +100°C.
- Material: Brass / Steel Nickel-Plated Finish
- Single Shut Off (One side is with valve)
- ISO 6150-B-12
- Industrial Interchangeable 1/4"
- US MIL STD. 4109 1/4"
- Flow 900 l/min

Compatible with:

TST SWING COUPLING B1

TST 024

CEJN 310

PARKER 20

Industrial interchange 1/4"

PARKER - RECTUS 23

HANSEN 3000

ATLAS COPCO QIC 08

US-MIL-SPEC-C-4109

Specifications

Manufacturer Series	023
Coupling Type	Quick Connect Coupling Plug
Connection Standard	DN 5.5 ISO 6150-B-12 & Industrial Interchange 1/4"
Connection Standard Compatible With	TST SWING COUPLING P; INDUSTRIAL INTERCHANGE 1/4"; TST 024; PARKER-RECTUS 23; CEJN 310; HANSEN 3000; PARKER 20, ATLAS COPCO QIC 08; US-MIL-SPEC-C-4109
Minimum Operating Temperature	-20°C
Maximum Operating Temperature	+100°C
Maximum Operating Pressure	35bar
Flow	900 l/min
Flow Direction & Sealing	Through Type Coupling
Material	Steel
Finish	Nickel Plated
Connection Type	Hose Barb
Thread Size	N/A
Thread Standard	N/A
Thread Gender	N/A
Coupling Gender	Male
Threaded Connection	N/A
Seal material	N/A
Hose Barb Connection	13 mm

Specifications

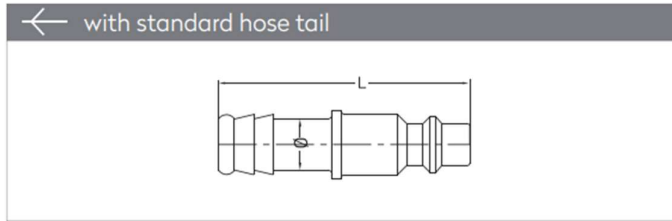

Dimensions (mm)		
SW	L	ØD
-	50	12

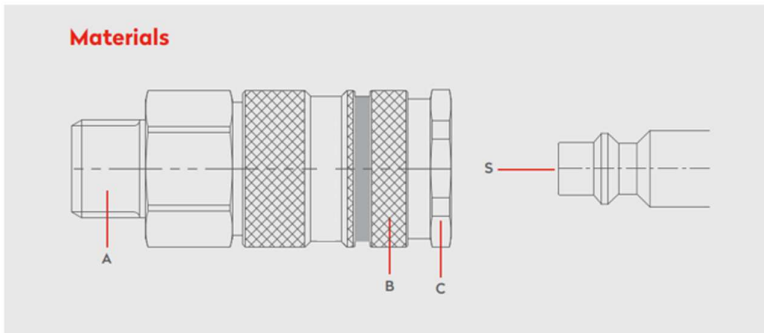

Material Code

A = Brass Nickel Plated

B = Steel Nickel Plated

C = Brass Nickel Plated

S = Steel Nickel Plated

Plug Profile Serie 023

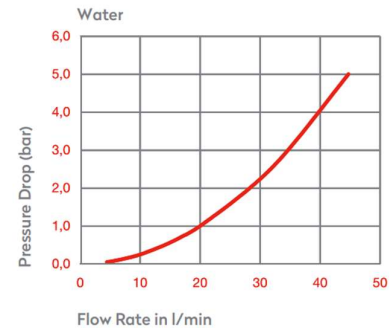
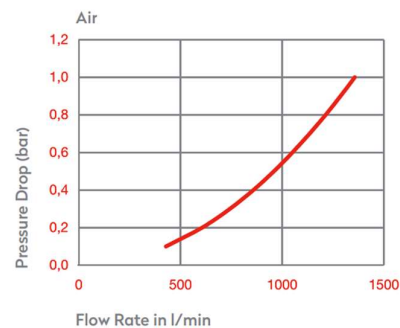
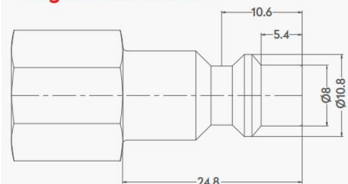

Series 23 Quick Connect Couplings

	0 - 35 bar (0-508 PSI)		-20° to +100°C (NBR) -4° to +212°F	Shut Off Type	
	OM 300 - 00750 OM 100 - 01000 OM 250 - 00500	FLOW	900 lt/min	DN	5.5 mm