

## Features

- Double Shut Off
- Screw to connect system
- Operating Temperature from -20 °C to +100 °C
- Free-cutting steel
- ISO 14540
- Interchangeable:

CEJN 230-PARK. 3000  
Faster PVVM  
Stucc IVHP  
Snap Tite 76

## RS PRO Hydraulic Quick Connect Couplings

RS Stock No.: 0727371



RS PRO is the own brand of RS. The RS PRO Seal of Approval is your assurance of professional quality, a guarantee that every part is rigorously tested, inspected, and audited against demanding standards. Making RS PRO the Smart Choice for our customers.

## Product Description

RS PRO 73 Series hydraulic quick connect couplings are designed for demanding hydraulic applications and typically feature a screw-to-connect design for high-pressure environments.

Here are the key features:

- Screw-to-Connect Design**  
 Provides a secure, leak-free connection even under high pressure and pulsating loads. Ideal for applications where accidental disconnection must be prevented.
- High Pressure Capability**  
 Suitable for heavy-duty hydraulic circuits.
- Robust Construction**  
 Manufactured from hardened steel with corrosion-resistant coatings
- Non-Spill Valve System**  
 Minimizes fluid loss during disconnection, reducing contamination and environmental hazards.
- Safety Locking Mechanism**  
 Screw connection ensures positive locking, preventing accidental release under load

Applications: **construction machinery, agricultural equipment, oil & gas, and industrial hydraulic systems** where high pressure and vibration resistance are critical.

Interchangeability:

- CEJN 230-PARK. 3000
- Faster PVVM
- Stucc IVHP
- Snap Tite 76
- ISO 14540

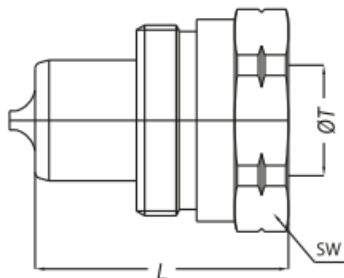

T Connection	SW (mm)	L (mm)
NPT 3/8"	32	40

## Specifications

<b>Manufacturer Series</b>	73
<b>Standards Met</b>	ISO 14540
<b>Compatible with</b>	CEJN 230-PARK. 3000 Faster PVVM Stucci IVHP Snap Tite 76 ISO 14540
<b>Maximum Operating Pressure</b>	700 Bar
<b>Minimum Operating Temperature</b>	-20 °C
<b>Maximum Operating Temperature</b>	+100 °C
<b>Type</b>	Coupling Plug
<b>Double Shut Off</b>	Double Shut Off
<b>Thread Size</b>	3/8 in
<b>Thread Standard</b>	NPT
<b>Thread Gender</b>	Female
<b>Coupling Gender</b>	Male
<b>Thread</b>	NPT 3/8 in Female
<b>Material</b>	Steel
<b>Finish</b>	Free-cutting steel
<b>Seal Material</b>	Nitrile Rubber
<b>Sleeve Material</b>	Free-Cutting Steel
<b>Valve Material</b>	36SMnPb14
<b>Spring Material</b>	14310
<b>Locking O Ring Material</b>	Nitrile Rubber