

# POWER-COMBICON Plugs, Pitch 7.62 mm

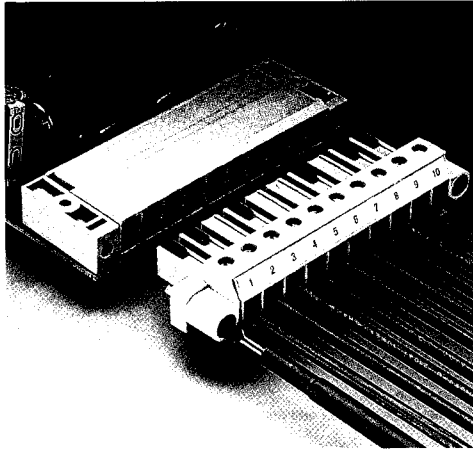

POWER-COMBICON is the new improved version of the "standard" COMBICON high-capacity plug connectors.

POWER-COMBICON features:

- a high current carrying capacity of 20 A with 400 VAC (surge voltage category III/contamination class 3),
- an extended conductor cross section of 4 mm<sup>2</sup> stranded, and
- the astonishingly small pitch of 7.62 mm.

PC plugs with plug-in direction parallel to the conductor axis and headers with vertical and horizontal plug-in direction (see page 160) are available with 2 to 12 positions.

The PC 4 HV/...-ST-7,62 variant with an operating voltage of up to 800 V (600 V according to UL) and 2, 3 and 4 positions is available (flange types on request).

The crimp plugs can be combined with all headers as an alternative to the screw connectors.

The highly resilient crimp contact (with steel overspring) is available in two versions:

- STG-MTN 0,5-1,0 for conductors from 0.5 to 1 mm<sup>2</sup> and
- STG-MTN 1,5-2,5 for conductors from 1.5 to 2.5 mm<sup>2</sup>.

PCC plugs are available with 2 to 12 positions.

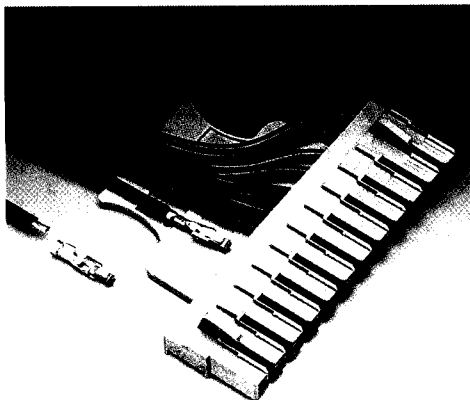

Further POWER-COMBICON variants, such as headers, cable housings, feed through housings and modular terminal blocks are documented on pages 160-161, 166-167, 190-191, 194-195.

Articles printed in bold can be delivered at short notice.

Products with black or gray housing available on request.

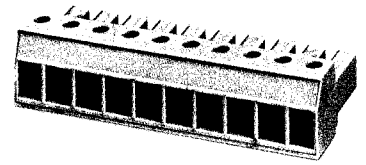

## PC 4/...-ST-7,62

Plug-in direction parallel to the conductor axis

Pitch 7.62

(IEC)	rigid	flexible	I	U
[mm <sup>2</sup> ]	solid	stranded	AWG	[A]
Connection data	0.2-4	0.2-4	24-10	20
Further technical data see page 226.				

### Note:

Only actuate COMBICON plug connectors when under no load condition. If for operating reasons small loads must be switched, experimental values are available on request.

Description	No. of positions	Dim a [mm]
<b>Plugs, 7.62 mm pitch,</b> color: green	2	7.62
	3	15.24
	4	22.86
	5	30.48
	6	38.10
	7	45.72
	8	53.34
	9	60.96
	10	68.58
	11	76.20
	12	83.82

### (1) Module socket contact,

is inserted into the plug after the conductor has been crimped, for conductors from 0.5 to 1.0 mm<sup>2</sup> ribbon contacts 0.5 to 1.0 mm<sup>2</sup> ribbon contacts 1.5 to 2.5 mm<sup>2</sup> ribbon contacts 1.5 to 2.5 mm<sup>2</sup> ribbon contacts



### (2) Crimping tool, for crimping conductors in the module socket contacts STG-MTN



### (3) Contact removal tool, for removing the module socket contacts STG-MTN



(4) **Strain relief**, for snapping into the locking chambers of the plug, can be labelled using ZB 6 (see catalog part 3: Marking/Mounting)



### (5) Coding section, is inserted into plug and header slots, red insulating material



CP-HCC 4

16 00 02 7

100

### (6) Marker card, with 12 pcs., 10-section marker strips, white, self-adhesive, for 120 terminal blocks

SK 7,62/3,8 (see page 211)

### (7) Screwdriver, blade: 0.6 x 3.5 x 100, length: 180 mm



SZS 0,6 x 3,5

12 05 05 3

10

The plug and header are coded with the CP-HCC 4 coding section.

SKS 7,62/3,8 are used for marking.

POWER-COMBICON plugs with knurled screws are available on request.

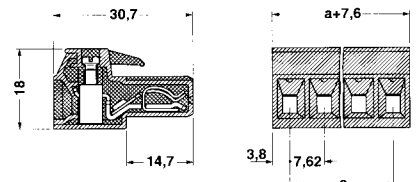

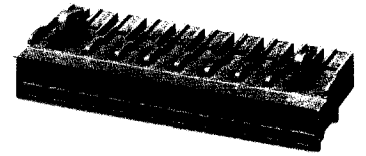
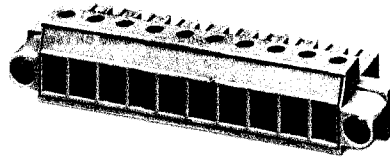
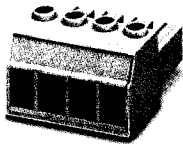

## PC 4 HV/...-ST-7,62

Plug for high operating voltages

## PC 4/...-STF-7,62

Plug with screw flange

## PCC 4/...-ST-7,62

Plugs with crimp connection

Pitch 7.62

(IEC) [mm <sup>2</sup> ]	rigid solid	flexible stranded	AWG	I [A]	U [V]
Connection data	0.2-4	0.2-4	24-10	20	800

Further technical data see page 226.

Pitch 7.62

(IEC) [mm <sup>2</sup> ]	rigid solid	flexible stranded	AWG	I [A]	U [V]
Connection data	0.2-4	0.2-4	24-10	20	400

Further technical data see page 226.

Pitch 7.62

Crimp connection	[mm <sup>2</sup> ]	AWG	I [A]	U [V]
STG-MTN 0,5-1,0	0.5-1.0	20-18	13,5*	400
STG-MTN 1,5-2,5	1.5-2.5	16-14	20*	400

\* See current carrying capacity diagram  
Further technical data see page 226.



Type	Order No.	Pcs. Pkt.
PC 4 HV/2-ST-7,62	18 48 89 2	50
PC 4 HV/3-ST-7,62	18 48 90 2	
PC 4 HV/4-ST-7,62	18 48 91 5	
CP-HCC 4	16 00 02 7	100
SK 7,62/3,8 (see page 211)		
SZS 0,6 x 3,5	12 05 05 3	10



Type	Order No.	Pcs. Pkt.
PC 4/2-STF-7,62	18 28 24 9	50
PC 4/3-STF-7,62	18 28 25 2	
PC 4/4-STF-7,62	18 28 26 5	
PC 4/5-STF-7,62	18 28 27 8	
PC 4/6-STF-7,62	18 28 28 1	
PC 4/7-STF-7,62	18 28 29 4	
PC 4/8-STF-7,62	18 28 30 4	
PC 4/9-STF-7,62	18 28 31 7	
PC 4/10-STF-7,62	18 28 32 0	
PC 4/11-STF-7,62	18 28 33 3	
PC 4/12-STF-7,62	18 27 58 3	
CP-HCC 4	16 00 02 7	
SK 7,62/3,8 (see page 211)		
SZS 0,6 x 3,5	12 05 05 3	10



Type	Order No.	Pcs. Pkt.
PCC 4/2-ST-7,62	18 40 19 1	50
PCC 4/3-ST-7,62	18 40 18 8	
PCC 4/4-ST-7,62	18 40 17 5	
PCC 4/5-ST-7,62	18 40 16 2	
PCC 4/6-ST-7,62	18 40 15 9	
PCC 4/7-ST-7,62	18 40 14 6	
PCC 4/8-ST-7,62	18 40 13 3	
PCC 4/9-ST-7,62	18 40 12 0	
PCC 4/10-ST-7,62	18 40 11 7	
PCC 4/11-ST-7,62	18 40 10 4	
PCC 4/12-ST-7,62	18 40 09 4	
STG-MTN 0,5-1,0	31 90 43 8	
STG-MTN 0,5-1,0 BA	31 90 62 9	4000
STG-MTN 1,5-2,5	31 90 50 6	100
STG-MTN 1,5-2,5 BA	31 90 63 2	4000
CRIMPFOX MT 2,5	12 04 03 8	1
STG-EW	31 90 44 1	1
STZ 2-PCC 4-7,62	18 40 21 4	50
STZ 3-PCC 4-7,62	18 40 22 7	
STZ 5-PCC 4-7,62	18 42 00 5	
STZ 8-PCC 4-7,62	18 40 23 0	
CP-HCC 4	16 00 02 7	100
SK 7,62/3,8 (see page 211)		

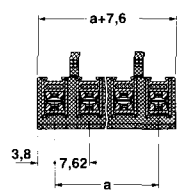
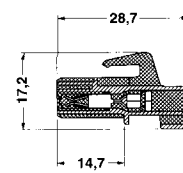
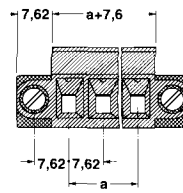
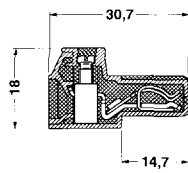
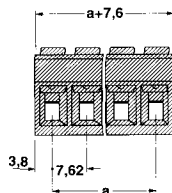
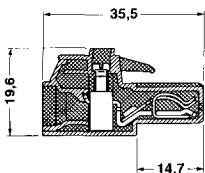

# POWER-COMBICON Headers, Pitch 7.62 mm

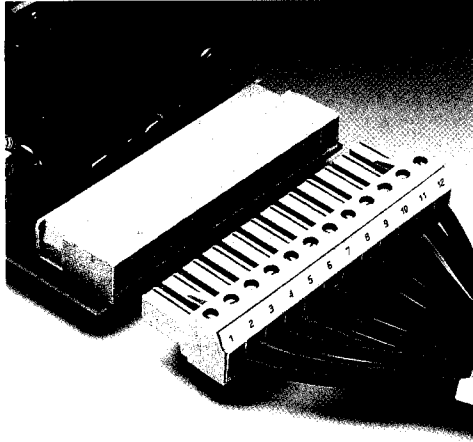

POWER-COMBICON is the new improved version of the "standard" COMBICON high-capacity plug connectors.

The PC headers are available for vertical and horizontal plug-in direction with 2 to 12 positions.

In addition to the normal PC plugs, the plug with screw flange PC 4/...-STF-7,62 (see page 159) is available. The mounting ear BF-PC 4 is snapped onto the left and right hand side of the standard PC basic strips. The basic strip with threaded flange for vibration-resistant connection to the PC 4/...-STF-7,62 is now ready.

The plugs and headers are coded with the CP-HCC 4 coding section.

Labelling is done with SK 7,62/3,8.

POWER-COMBICON plugs see pages 158 and 159.  
Articles printed in bold can be delivered at short notice.  
Products with black or gray housing available on request.

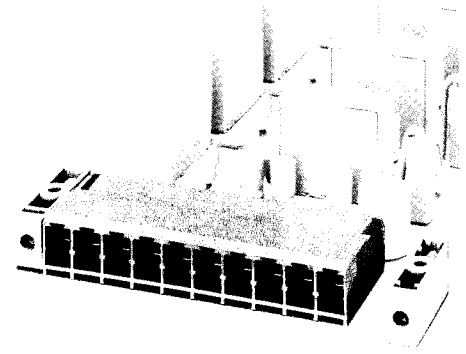

## PC 4/...-G-7,62

Plug-in direction **parallel** to the p.c.b.

Pitch 7.62

Connection data  
Further technical data see page 227.

I	U
[A]	[V]
20	400

**Note:**  
Only actuate COMBICON plug connectors when under no load condition. If for operating reasons small loads must be switched, experimental values are available on request.

Description	No. of positions	Dim a [mm]
<b>Headers, 7.62 mm pitch, color: green</b>	2	7.62
	3	15.24
	4	22.86
	5	30.48
	6	38.10
	7	45.72
	8	53.34
	9	60.96
	10	68.58
	11	76.20
	12	83.82

BV/RMRS/LR/NV

Type	Order No.	Pcs. Pkt.
<b>PC 4/2-G-7,62</b>	18 04 79 7	50
<b>PC 4/3-G-7,62</b>	18 04 80 7	
<b>PC 4/4-G-7,62</b>	18 04 81 0	
<b>PC 4/5-G-7,62</b>	18 04 82 3	
<b>PC 4/6-G-7,62</b>	18 04 83 6	
<b>PC 4/7-G-7,62</b>	18 04 84 9	
<b>PC 4/8-G-7,62</b>	18 04 85 2	
<b>PC 4/9-G-7,62</b>	18 04 86 5	
<b>PC 4/10-G-7,62</b>	18 04 87 8	
<b>PC 4/11-G-7,62</b>	18 04 88 1	
<b>PC 4/12-G-7,62</b>	18 04 89 4	
<b>BF-PC 4</b>	18 27 57 0	
<b>CP-HCC 4</b>	16 00 02 7	100

SK 7,62/3,8 (see page 211)

- Mounting ear**, is snapped onto the left and right of the header, for screw connection to the PC 4/...-STF-7,62
- Coding section**, is inserted into plug and header slots, red insulating material
- Marker card**, with 12 pcs., 10-section marker strips, white, self-adhesive, for 120 terminal blocks

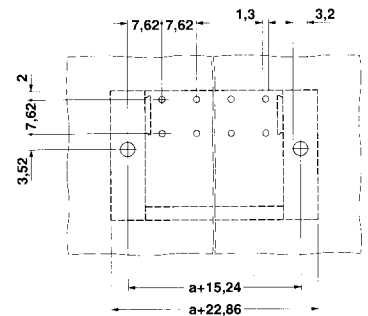

Drilling diagram PC 4/...-G (with BF-PC 4)

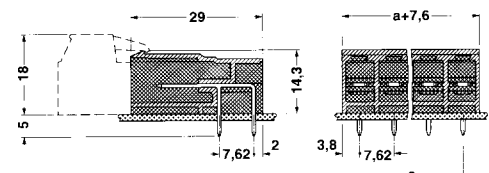

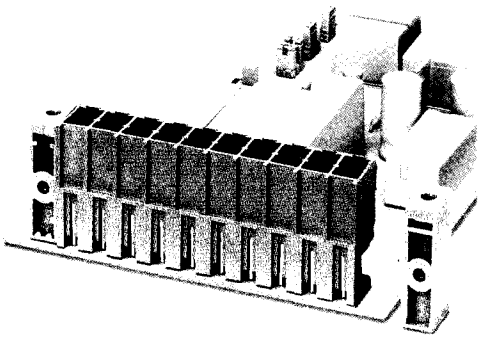

## PCV 4/...-G-7,62

Plug-in direction **vertical** to the p.c.b.

Pitch 7.62

I	U
[A]	[V]
20	400

Connection data

Further technical data see page 227.

BV/RMRS/LR/NV

Type	Order No.	Pcs. Pkt.
PCV 4/2-G-7,62	18 04 68 7	50
PCV 4/3-G-7,62	18 04 69 0	
PCV 4/4-G-7,62	18 04 70 0	
PCV 4/5-G-7,62	18 04 71 3	
PCV 4/6-G-7,62	18 04 72 6	
PCV 4/7-G-7,62	18 04 73 9	
PCV 4/8-G-7,62	18 04 74 2	
PCV 4/9-G-7,62	18 04 75 5	
PCV 4/10-G-7,62	18 04 76 8	
PCV 4/11-G-7,62	18 04 77 1	
PCV 4/12-G-7,62	18 04 78 4	
BF-PC 4	18 27 57 0	
CP-HCC 4	16 00 02 7	100
SK 7,62/3,8 (see page 211)		

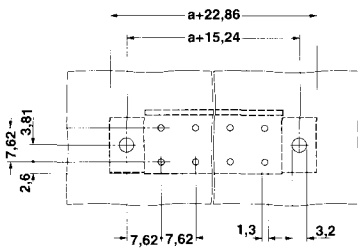

Drilling diagram PCV 4/...-G (with BF-PC 4)

