

# PF-600E-ASB-FF-603



SCAN OR  
CLICK FOR:



QR-CAT-PAPR

PAPR Catalogue  
Section



QR-CAT-FULL

Full Personal  
Safety Division  
Catalogue

## PF-600E-ASB-FF-602 includes

- PF-602E-ASB blower
- FF-603 Full face respirator
- PF-972 Airflow Indicator
- SC-BT-56-ASB Breathing tube
- PF-630 internal battery
- PF-641E battery charger
- PF-653 Shower plugs
- SC-327 Easy Clean Belt
- 2 x DT-1135E PAPR-P3 Particulate DT-Series Filters
- SS-6601 Prefilter pack (2 x SS-6602 Prefilter holders & 6 x SS-6600 Prefilters)
- Stackable storage tubs

SAP ID	Legacy ID	Availability		Model #	Description
		AUS	NZ		
7100293328	UU012118202	•		PF-600E-ASB-FF-603	FF-603 Medium/Large PF-600E-ASB Ready-Pak. Comes with PF-602E-ASB blower, PF-972 Airflow Indicator, SC-BT-56-ASB Breathing tube, PF-630 internal battery, PF-641E battery charger, PF-653 Shower plugs, SC-327 Easy Clean Belt, 2 x DT-1135E PAPR-P3 Particulate DT-Series Filters, SS-6601 Prefilter pack (2 x SS-6602 Prefilter holders & 6 x SS-6600 Prefilters) and stackable tubs



**3M Australia Pty Ltd**  
Personal Safety Division  
Bldg A, 1 Rivett Road  
North Ryde NSW 2113  
Customer Service: 1300 363 565  
Email: 3msupport.safety.au@mmm.com  
Web: www.3M.com/au/ppesafety

**3M New Zealand Ltd**  
Personal Safety Division  
94 Apollo Drive, Rosedale  
Auckland 0632  
Customer Service: 0800 252 627  
Email: 3msupport.safety.nz@mmm.com  
Web: www.3M.com/nz/ppesafety

3M and Versaflo are trademarks of 3M Company.  
© 3M 2025. All rights reserved.

# 3M™ PF-600E-ASB (Proflow SC160) Powered Air Respirator

## Description

The 3M™ PF-600E-ASB (Proflow SC160) incorporates a waist mounted blower unit supplying filtered air to the face piece through a breathing hose. A NiMH battery is encased in a polyurethane casing with a microcontrolled charger for charging.

Approved DT-Series (Pro2000) filters include:

- DT-1135E PAPR-P3
- DT-4045E Combined Filter PAPR-B1E1K1P3

Approved Headtops / Facepieces include:

- S-333 Headtop
- S-533 Headtop
- M-200 Headtop
- M-300 Headtop
- 3M™ FF-300 (Promask Single/FM3) Full Facepiece
- 3M™ FF-600 (Vision RFF4000/FM4) Full Facepiece<sup>1</sup>

The blower unit features a DC motor powered radial fan. A microprocessor calculates the power required to maintain the set flow rate and automatically adjusts the air supply. If the airflow rate falls below the minimum 160 l/min, an audible warning sounds.

To facilitate load tracking and servicing, the 3M PF-600E-ASB (Proflow SC160) incorporates a data-logging function, which automatically records information about the usage and performance of the blower unit. Tracking of the history of each individual model and reliable product identification is available through the Service Centre.

The rechargeable battery is safely enclosed within the casing. The service life of the battery is extended by the electronic control of recharging. A single charge allows the user to work for a full shift. Operation time for the PF-600E-ASB (Proflow SC160) and approved respirator/filter, will vary dependant on the loading of the filter, the air temperature and relative humidity.

The 9.6V NiMH battery takes 6 hours to charge from flat. Recharging should always take place at a room temperature of about 20°C. The battery technology does not exhibit “memory” effect, there is no need for complete discharge before recharging.

---

<sup>1</sup>. Available only in Australia



The Microprocessor-controlled charger features an automatic recharging system including signal lights. The signal lamp on the charger indicates charging status. A fully-charged battery can stay connected to the charging device without damage. The power pack can be left on standby charge and taken into use whenever needed. The charger features internal over current protection and temperature protection.

An automatic monitoring feature checks that the blower is operating correctly, warns the user of low battery and quickly compensates for changes in airflow. A self-diagnostic test on start-up shows the current status of the respirator on the digital display.

On the digital display a P number indicates the condition of the particle filter. A P9 shows that less resistance is present in the filter and a lower P number shows that the resistance in the filter has increased. An increase in resistance usually indicates the clogging of the filter medium or a throttled breathing hose.

A9 shown on the digital display indicates the battery is fully charged and A1-A0 indicates the battery capacity has dropped below the required level. There is an audible warning of battery and filter status.

## Standards

The PF-600E-ASB (Proflow SC160) air powered respirator complies with AS/NZS 1716:2012.

## Service/Training

Users need to be trained in the safe operation of this equipment. Routine checks must be carried out in accordance with the user instructions. Cleaning should also only be carried out as specified in the user instructions.

For training requirements in Australia, please contact 3M Customer Services: 1300 363 565.

For training requirements in New Zealand, please contact 3M Customer Services: 0800 252 627.

All servicing must be carried out by trained personnel who have been trained and are deemed competent by the manufacturer and hold a current 3M Scott Safety technician's certificate.

For Annual Servicing requirements in Australia, please contact 3M Scott Fire & Safety Service department on Phone: 131 772 or Email: [scbaservice@mmm.com](mailto:scbaservice@mmm.com).

For annual servicing requirements in New Zealand, please contact 3M Customer Services: 0800 252 627.

## Specifications

The following specifications for the PF-600E-ASB (Proflow SC160) Powered Air Respirator apply to PF-619E-ASB and PF-619E-ASB-PF-949 Starter Kit:

- ▶ **Blower Body:** Polyurethane (PU) - good chemical & impact resistance
- ▶ **Motor Body:** Polyamide (PA 12) - good resistance to abrasion & impact
- ▶ **Body Tensioner:** Stainless Steel
- ▶ **Inhalation Valve Body:** Polyamide (PA)
- ▶ **Breathing Hose:** Ethylene Propylene Diene Monomer (EPDM) Rubber
- ▶ **Air flow:** Minimum 160 l/min, automatic adjustment
- ▶ **Belt:** Fully adjustable, washable PVC for easy decontamination
- ▶ **Operating Time:** 6 - 7 hours from a single charge, depending on workload
- ▶ **Battery:** NiMH 9.6V nominal 4.5Ah rechargeable battery
- ▶ **Battery Life:** About 400 charging cycles (@4h daily running time)
- ▶ **Charger:** 6-7 hours recharging time - automatic trickle charging
- ▶ **Recharging Temperature:** Recommended 20°C
- ▶ **Power Pack Status Indication:** Visual display of battery status (A) Filter Blockage (P) Audible warning of low battery and filter status
- ▶ **Sound Level:** <70dB(A)
- ▶ **Operating Temperature:** -10°C to +30°C
- ▶ **Operating Humidity:** <95%
- ▶ **Ingress Protection:** IP54
- ▶ **Warranty:** PF-600E-ASB (Proflow SC160): 36 months or 1800 hours (excluding battery) Battery: 12 months  
Warranty runs from the date of purchase by the end user and is only valid if serviced and maintained according to the manufacturers recommendations
- ▶ **Approvals:** AS/NZS 1716:2012

## Filters

The 3M™ PF-600E-ASB (Proflow SC160) is approved for use with PAPR DT-Series (Pro2000) PAPR-P3 particulate filter and PAPR-B1E1K1P3 Combination filters. 3M™ PF-600E-ASB (Proflow SC160) is approved with a range of facepieces, hoods and headtops. These combinations are compliant to AS/NZS 1716: 2012. Please refer to the relevant facepiece, hood and headtop datasheet for individual technical specifications.

The following DT-Series (Pro2000) filters are approved for use with the 3M PF-600E-ASB (Proflow SC160):

Filters	Code	Description
DT-Series PF10 PAPR-P3	DT-1135E (052670)	Solid & liquid particles, radioactive & toxic particles, fumes and mists
DT-Series CF22 PAPR-B1E1K1P3	DT-4045E (042799)	Inorganic gases/vapours, acid gases/vapours, ammonia & ammonia derivatives, solid & liquid particles

## Headtops/Facepieces

The 3M™ PF-600E-ASB (Proflow SC160) is approved for use with specific headtop/facepiece combinations. The manufacturer identifies the headtop combination to be tested. Each combination is compliant to AS/NZS 1716: 2012. Please refer to relevant datasheets for individual technical specifications.

## Approved Combinations and PAPR Classifications

According to AS/NZS 1716:2012 an approved PAPR unit always consists of a blower + facepiece/hood + filters. The following combinations are compliant to AS/NZS 1716: 2012. The manufacturer does not accept responsibility for any other combination of components. Use of unapproved combinations may lead to ill health.

### Hoods and Headtops

- S-333 Versaflo Half hood
- S-533 Versaflo Full hood
- M-200 Headtop
- M-300 Headtop

See [Figure 1](#).

### **i** IMPORTANT NOTE

M-200 & M-300 with PF-600E-ASB-PF-949 combinations are PAPR-P1 rated. Suitable for contaminants up to 10x the Workplace Exposure Standard (WES) for particulate and gas/vapour contaminants.

### **i** IMPORTANT NOTE

S-333 & S-533 with PF-600E-ASB-PF-949 combinations are PAPR-P3 rated. Suitable for contaminants up to 100x the Workplace Exposure Standard (WES) for particulate contaminants and up to 10x the WES for gas/vapour contaminants.

### Facepieces

FF-300 & FF-600 with DT-1135E PAPR-P3 particulate filter combinations are PAPR-P3 rated. Suitable for particulate contaminants up to 100+ the Workplace Exposure Standard (WES) for particulate contaminants and up to 10x the WES for gas/vapour contaminants.

- FF-300 (Promask Single/FM3)
- FF-600 (Vision RFF4000/FM4)<sup>2</sup>

See [Figure 2](#).

## Weight

Combination	Weight	Weight with 2 x DT-1135E Filter	Weight with 2 x DT-4045E Filters
PF-600E-ASB (Proflow SC160) with battery	1.65kg	1.75kg	2.4kg
Battery	448g		
Charger	660g		

<sup>2</sup> Available only in Australia

## Headtop/Facepiece, Hose and Filter Options

Headtop or Facepiece	Compatible Hoses	Compatible Filters
S-333 S-533 M-200 M-300  See <a href="#">Figure 1</a> .	BT-30: Self-adjustable Polyurethane Breathing Tube L=525-850mm (comes standard with PF-619E-ASB-PF-949 Starter Kit and PF-600E-ASB-M-307 Kit)  BT-20S: Fixed length lightweight Polyurethane Breathing Tube L=735mm  BT-20L*: Fixed length lightweight Polyurethane Breathing Tube L=965mm  BT-40: Fixed length Heavy Duty Neoprene Breathing Tube L=840mm  See <a href="#">Figure 1</a> .	DT-1135E (052670) DT-Series (Pro2000) PAPR-P3  DT-4045E (042799) DT-Series (Pro2000) CF32 PAPR-B1E1K1P3  See <a href="#">Figure 3</a> .
3M FF-300 (Promask Single/ FM3) Full Facepiece**  FF-600 (Vision RFF4000/ FM4) Full Facepiece***  See <a href="#">Figure 2</a> .	SC-BT-56-ASB (063799) EPDM Hose (comes standard with PF-619E-ASB Starter Kit, PF-600E-ASB-FF-302 & PF-600E-ASB-FF-603 Ready-Paks)  See <a href="#">Figure 2</a> .	DT-1135E (052670) DT-Series (Pro2000) PAPR-P3  DT-4045E (042799) DT-Series (Pro2000) CF32 PAPR-B1E1K1P3  See <a href="#">Figure 3</a> .
* BT-20L available only in Australia.		
** Export controlled product document required to be signed on purchase.		
*** Available only in Australia		

Figure 1: Headtops compatible with PF-619E-ASB- PF-949 Starter Kit: 1) S-333, 2) S-533, 3) M-200, 4) M-300.  
Compatible hoses: 1) BT-30, 2) BT-20S/L [BT-20L available only in Australia], 3) BT-40



**ⓘ IMPORTANT NOTE**

M-200 & M-300 with PF-600E-ASB-PF-949 Combinations PAPR-P1 rated. Suitable for contaminants up to 10x the Workplace Exposure Standard (WES).

---

Figure 2: Facepieces and hoses compatible with PF-619E-ASB Starter Kit: 1) 3M FF-300 (Promask Single/FM3) Full Facepiece and 2) FF-600 (Vision RFF4000/ FM4) Full Facepiece [available only in Australia] 3) SC-BT-56-ASB. Compatible hose: UU011534342



Figure 3: Filters: 1) DT-1135E (052670) DT-Series (Pro2000) PF 10 PAPR-P3 and 2) 042799/DT-4045E DT-Series (Pro2000) CF32 PAPR-B1E1K1P3



## Ready-Paks Complete Packages for PF-600E-ASB (Proflow SC160) PAPR Unit

The 3M PF-600E-ASB (Proflow SC160) Ready-Paks, provides a “ready-to-go” system containing all you need to get started.



**PF- 600E-ASB-FF-602 FF-602 (Vision RFF4000) PF-600EASB (Proflow SC1 60) Ready-Pak<sup>3</sup>** . Comes with PF-602E-ASB blower, PF-972 Airflow Indicator, SC-BT-56- ASB Breathing tube, PF-630 internal battery, PF-641E battery charger, PF-653 Shower plugs, SC-327 Easy Clean Belt, 2 x DT-1135E P3 Particulate DT-Series (Pro2000) Filters, SS-6601 Prefilter pack (2 x SS-602 Prefilter holders & 6 x SS-6600 Prefilters) and stackable tubs. Order ID UU012118202.

<sup>3</sup>. Available only in Australia



**PF- 600E-ASB-FF-302 FF-302 (Promask Single/FM3) PF- 600E-ASB (Proflow SC1 60) Ready-Pak.** Comes with PF-602E-ASB blower, PF-972 Airflow Indicator, SC-BT-56-ASB Breathing tube, PF-630 internal battery, PF-641E battery charger, PF-653 Shower plugs, SC-327 Easy Clean Belt, 2 x DT- 1135E P3 Particulate DT-Series (Pro2000) Filters, SS-6601 Prefilter pack (2 x SS-602 Prefilter holders & 6 x SS-6600 Prefilters) and stackable tubs. Export controlled product. Document required to be signed on purchase. Order ID UU012187892.



**M-307 Headtop with reflective tape PF-600E-ASB (Proflow SC160) Ready-Pak.** Comes with PF-602E-ASB blower with PF-949 breathing tube adaptor attached PF-972 Air Flow Indicator, BT-30 Breathing tube, PF-630 internal battery, PF-641E battery charger, PF-653 Showerplugs, SC-327 Easy Clean Belt, 2 x DT-1135E PAPR-P3 Particulate DT-Series (Pro2000) Filters, SS-6601 Prefilter pack (2 x SS-602 Prefilter holders & 6 x SS-6600 Prefilters) and S1303-0166 storage bag. P/N AT019501447.

## Maintenance/Cleaning

**Maintenance:** The blower device shall be serviced at least once a year by a Service Centre. After use the respirator must be checked, cleaned and disinfected. Replace damaged parts. Replace worn filters. Always replace filters at the same time. Check that the breathing hose is undamaged. Use only original parts. Maintenance of the respirator is described in the respective instructions for use.

**Cleaning:** Clean with a damp cloth or sponge. Use lukewarm water and mild detergent (neutral pH 6-8). Do not use solvents (like turpentine, acetone), hot water or bleaching agents (like Perborate, Percarbonate). Never clean with compressed air or compressed water. Do not allow water to enter the breathing hose. After cleaning disinfect. Do not use radiant heat or artificial heating for drying purposes, as this may cause damage. Allow to dry at room temperature.

## Storage

The 3M PF-600E-ASB (Proflow SC160) should be protected from direct sunlight, grease and oil. The store should be dry and cool.

**Storage of the respirator:** -10°C to +50°C, and relative humidity (RH) under 75%. A properly stored, unused respirator stays in good condition for a long storage period.

**Storage of the Blower Unit:** -10°C to +30°C, and at less than 75% RH.

**Storage and maintenance of a filter:** The filters are sealed in plastic bags by the manufacturer. Store the filters unopened in a clean place at an even temperature. Most appropriate is 0°C to +30°C with relative humidity below 75%. Sealed filters tolerate conditions of -10°C to +50°C and below 95% RH. The storage period (month and year) for filters is marked on the filter tape. Do not try to regenerate the filters. Never clean the filters with compressed air or compressed water. An opened gas/vapour filter must be sealed tightly if they are to be reused and must be replaced within 6 months after opening at the latest, as per AS/NZS 1716:2012. After use, the filters are special refuse. Make sure that they are disposed of in accordance with current waste treatment regulations.

## Disposal

If the product is to be disposed of, it should be disassembled and disposed of as solid waste. Please see local authority regulations for disposal advice and locations. Discarded batteries are hazardous waste. Make sure they are disposed of according to correct regulations.

## Ordering Information

### Starter Kits

3M Code	Model #	Description
UU012121842	PF-619E-ASB (064580)	PF-619E-ASB (Proflow SC160) Starter Kit. Comes with PF-602E-ASB blower, PF-972 Airflow Indicator, SC-BT-56-ASB Breathing tube, PF-630 internal battery, PF-641E battery charger, PF-653 Shower plugs, SC-327 Easy Clean Belt. 2 x DT-1135E PAPR-P3 particulate filters, SS-6601 Prefilter pack (2 x SS-602 Prefilter holders & 6 x SS-6600 Prefilters). Compatible only with FF-300 & FF-600 tight fitting full facepieces.
AT019501454	PF-619E-ASB-PF-949	PF-619E-ASB-PF-949 (Proflow SC160) Starter Kit. Comes with PF-602E-ASB blower with PF-949 breathing tube adaptor attached, PF-972 Airflow Indicator, BT-30 Breathing tube, PF-630 internal battery, PF-641E battery charger, PF-653 Shower plugs, SC-327 Easy Clean Belt. 2 x DT-1135E PAPR-P3 particulate filters, SS-6601 Prefilter pack (2 x SS-602 Prefilter holders & 6 x SS-6600 Prefilters). Compatible only with S-333, S-533, M-200 & M-300 headtops.

# 3M Personal Safety Division

## Ready-Paks

3M Code	Model #	Description
UU012187892	PF-600E-ASB-FF-302 (5064594)	FF-302 (Promask Single/FM3) PF-600E-ASB (Proflow SC160) Ready-Pak. Comes with PF-602E-ASB blower, PF-972 Airflow Indicator, SC-BT-56-ASB Breathing tube, PF-630 internal battery, PF-641E battery charger, PF-653 Shower plugs, SC-327 Easy Clean Belt, 2 x DT- 1135E P3 Particulate DT-Series (Pro2000) Filters, SS-6601 Prefilter pack (2 x SS-602 Prefilter holders & 6 x SS-6600 Prefilters) and stackable tubs. Export controlled product. Document required to be signed on purchase
UU012118202*	PF-600E-ASB-FF-602 (5564593)	FF-602 (Vision RFF4000) PF-600E-ASB (Proflow SC160) Ready-Pak. Comes with PF-602E-ASB blower, PF-972 Airflow Indicator, SC-BT-56-ASB Breathing tube, PF-630 internal battery, PF-641E battery charger, PF-653 Shower plugs, SC-327 Easy Clean Belt, 2 x DT- 1135E P3 Particulate DT-Series (Pro2000) Filters, SS-6601 Prefilter pack (2 x SS-602 Prefilter holders & 6 x SS-6600 Prefilters) and stackable tubs. Export controlled product. Document required to be signed on purchase.
AT019501447	PF-600E-ASB-M-307	M-307 Headtop with reflective tape PF-600E-ASB (Proflow SC160) Ready-Pak. Comes with PF-602E-ASB blower with PF-949 breathing tube adaptor attached PF-972 Air Flow Indicator, BT-30 Breathing tube, PF-630 internal battery, PF-641E battery charger, PF-653 Showerplugs, SC-327 Easy Clean Belt, 2 x DT-1135E PAPR-P3 Particulate DT-Series (Pro2000) Filters, SS-6601 Prefilter pack (2 x SS-602 Prefilter holders & 6 x SS-6600 Prefilters) and S1303-0166 storage bag.
* Available only in Australia		

## Loose Fitting Hoods & Headtops

3M Code	Model #	Description
52000045865	S-333SG	S-333 Versaflo Head Cover 1/Box
52000045881	S-333LG	SG = Small LG = Large
52000045949	S-533S*	S-533 Versaflo Full Hood 1/box
52000045964	S-533L	S = Small L = Large
UU011469986	M-206*	Faceshield with Comfort face seal
70071673779	M-207	Faceshield with flame-resistant face seal
UU011469960	M-306*	M-306 Versaflo Helmet with coated visor and Comfort face seal
70071562006	M-307	M-307 Versaflo Helmet with coated visor and flame resistant face seal
* Available only in Australia.		

# 3M Personal Safety Division

## Full Facepiece Options

3M Code	Model #	Description
UU010978961	FF-301 (012670)	3M FF-301 (Promask Single/FM3) PAPR full facepiece (S), no hose Export Controlled Product Document required to be signed on purchase.
UU010978953	FF-302 (012681)	3M FF-302 (Promask Single/FM3) PAPR full facepiece (M/L), no hose. Export Controlled Product Document required to be signed on purchase.
UU010979498	FF-601 (RFF4000S)*	3M FF-601 (RFF4000S/FM4) Silicon PAPR Side mounted full facepiece (Small), no hose
UU10979480	FF-602 (RFF4000)*	3M FF-601 (RFF4000M/FM4) Silicon PAPR Side mounted full facepiece (Medium)
UU010979332	FF-603 (RFF4000)*	3M FF-603 (RFF4000/FM4) Silicon PAPR Side mounted full facepiece (Medium/Large), no hose
* Available only in Australia.		

## Filters, Pre-filters, and Filter Accessories

3M Code	Model #	Description
UU011502539	DT-1135E (052670)	DT-Series (Pro2000) PF 10 PAPR-P3 - Solid/liquid/radioactive particulates, bacteria, fumes/mist
UU011534342	DT-4045E (042799)	DT-Series (Pro2000) CF 32 PAPR-B1E1K1P3 Inorganic and acid gases/vapours, ammonia + solid & liquid particulates
UU010979753	SS-6601/SC-6601	Pre-filter pack for DT-Series Filters. Includes 6 x SS-6600 pre-filters and 2 x SS-6602 pre-filter holders
UU010979779	SS-6600/SC-660	DT-Series Pre-filter 20EA/Pack
UU010979761	SS-6607/SC-6607	DT-Series Filter Covers Orange Polyethylene 2/EA/Pack

## 3M PF-600E-ASB (Proflow SC160) Breathing Tube Options

3M Code	Model #	Description
UU011534342	SS-BT-56-ASB (063799)	EPDM hose (angle & DIN) 80cm for use with FF-300 and FF-600 (comes standard with PF-619E-ASB Starter Kit, PF-600E-ASB-FF-302 & PF-600E-ASB-FF-603 Ready-Paks)
70071533015	BT-20L*	Fixed length lightweight Polyurethane Breathing Tube L=965mm for use with PF-600E-ASB with PF-949 adaptor
70071533023	BT-20S	Fixed length lightweight Polyurethane Breathing Tube L=735mm for use with PF-600E-ASB with PF-949 adaptor
XA007706584	BT-30	Self-adjustable Polyurethane Breathing Tube L=525-850mm for use with PF-600E-ASB with PF-949 adaptor. (Come standard with PF-600E-ASB-PF-949 starter kit)
UU003085113	BT-40	Fixed length Heavy Duty Neoprene Breathing Tube L=840mm for use with PF-600E-ASB with PF-949 adaptor
* Available only in Australia.		

# 3M Personal Safety Division

## FF-300 & FF-600 Accessories

3M Code	Model #	Description
UU010979506	FF-600-926 (VCP1000)*	FF-600 visor covers/tear offs
XP100544145	FF-300-926 (012698)	FF-300 visor covers/ tear offs
XP100544160	FF-300-20 (0129790)	FF-300 Prescription Spectacle frame Storage poly bag (PVC) - head tops
UU010979514	FF-600-20 (2015082)*	FF-600 & FF-600F Prescription Spectacle frame
* Available only in Australia.		

## Spare Parts & Accessories

3M Code	Model #	Description
UU010979811	PF-641E (063791)	Universal Charging Kit
UU011535331	SC-327 (2015430)	Belt With Buckle PVC
UU010979738	PF-653 (2023305)	Shower plugs blower caps to suit PF-600E-ASB

## Important Notice

To the extent permitted by law, 3M shall not be liable for any loss or damage including any loss of business, loss of profits, or for any indirect, special, incidental or consequential loss or damage arising from reliance upon any information herein provided by 3M. Nothing in this statement will be deemed to exclude or restrict 3M's liability for death or personal injury arising from its negligence.



### 3M Australia Pty Ltd Personal Safety Division

Bldg A, 1 Rivett Road  
North Ryde NSW 2113  
TechAssist Helpline 1800 024 464  
Customer Service 1300 363 565  
Email: techassist@mmm.com  
Web: www.3M.com/au/ppesafety

### 3M New Zealand Ltd Personal Safety Division

94 Apollo Drive, Rosedale  
Auckland 0632  
TechAssist Helpline 0800 364 357  
Customer Service 0800 252 627  
Email: techassist@mmm.com  
Web: www.3M.com/nz/ppesafety

© 3M 2025. All rights reserved.  
3M and Scott are trademarks  
of 3M Company.

# 3M™ Full Facepiece Reusable Respirator, FF-600 Series

## Technical Data Sheet

### Description

The 3M™ Full Facepiece Reusable Respirator FF-600 Series can be used with approved 3M™ DT-Series filters\* with a 40mm thread, or they can be used as part of an approved powered air respirator system using the appropriate breathing tube. Both combinations protect against gases, vapours and/or particulates depending on your individual needs.

Please note, the 3M™ Full Facepiece Reusable Respirator FF-600 Series, was previously named the Scott™ Vision™ Reusable Full Mask, RFF4000 or the Scott™ Vision™ Reusable Full Mask, FM4 for the PAPR version.

\*Filters previously from the Scott Safety Pro2000 range.

The visor is moulded in polycarbonate and hard coated to offer excellent scratch resistance.

The face seal is silicone, which provides a highly flexible seal making it easy to rapidly achieve an efficient and comfortable fit.

The inner mask is an essential part of the respirator airflow management system which directs inhaled air onto the visor to prevent misting and directs exhaled air through the exhalation valve. It is moulded in TPE with a matt finish which prevents reflective glare on the inside of the visor.

The respirator also features 2 inhalation valves, a 5-point adjustable rubber harness with quick release moulded buckles, a standard 40mm thread side filter fitting and a speech diaphragm.

### Key features

- Speech diaphragm
- Side port filter or breathing tube attachment
- Three sizes FF-601 (Small) FF-602 (Medium) FF-603 (Large)
- Spectacle kit available
- Facepiece weight: approx. 550 grams

Compatible with PF-600E-ASB Powered Air Purifying Respirator (PAPR)

### Standards

The Protector FF-600 full face respirator is certified to AS/NZS 1716:2012.



### Materials

Component	Material
Facemask	Silicone
Inner Mask	Thermoplastic Elastomer
Head Harness	EPDM
Visor	Polycarbonate

### Filters

The FF-600 has a side filter connection with a standard 40mm filter thread. FF-600 accepts gas & vapour, particle and combined filters from the comprehensive DT-Series filter range.



### Compatible with:



PF-600E-ASB

Refer to Powered Air Purifying Respirator Catalogue Section for more information

## Key use limitation

1. This respirator does not supply oxygen. Do not use in atmospheres containing less than 19.5% oxygen.
2. Do not use for respiratory protection against atmospheric contaminants that have poor warning properties or are unknown or immediately dangerous to life and health (IDLH) or against contaminants which generate high heats of reaction with chemical filters.
3. Do not misuse, alter, modify or repair this product.
4. Do not use with beards or other facial hair that prevent direct contact between face and edge of the respirator.
5. Do not use with unknown concentrations of contaminants.
6. Leave the work area immediately and check the integrity of the respirator and replace face mask if:
  - a. Damage has occurred or is apparent
  - b. Breathing becomes difficult or increased breathing resistance occurs
  - c. Dizziness or other distress occurs
  - d. You taste or smell the contaminant or an irritation occurs
7. Use strictly in accordance with respirator and filter user instruction leaflet.

For full use limitations please refer to the product user instructions.

## Protection Factors

According to AS/NZS 1715.

Combination	Required Min Protection Factor AS/NZS 1715*	Maximum Gas/Vapour Concentration Present In The Air In Ppm (Volume)
Full Face Respirator with Particulate P3 Filter	Up to 100	
Full Face Respirator with Gas & Vapour Filter Class 1	Up to 50	1000 ppm
Full Face Respirator with Gas & Vapour Filter Class 2	Up to 100	5000 ppm
Full Face Respirator with PF-600E-ASB PAPR-P3	Up to 100+	
Full Face Respirator with PF-600E-ASB PAPR-1 Gas & Vapour Filter	Up to 10	1000 ppm

\*Refer AS/NZS 1715: Selection use and maintenance of respiratory protective equipment.

## Cleaning and storage

Cleaning is recommended when necessary

If during use the equipment may have become contaminated by hazardous substances, the contamination must be identified and properly removed or the contaminated components must be replaced before next use.

Disposal of the contaminated components must be carried out in accordance with local regulatory requirements.

1. Inspect the equipment for worn or ageing or damaged components.
2. Carefully wipe the facemask clean with a warm water solution containing a mild detergent. The facemask may also be wiped with 3M™ Cleaning Wipes, 504.
3. If necessary, wash the outside of the breathing hose carefully using warm water solution containing a mild detergent. Ensure the breathing hose connections are free from all dirt or debris that could prevent an effective seal with the blower.
4. Once clean all components must be left to dry naturally.

## Storage & Transportation

Device must be protected from damage during transportation.

When not in use the equipment should be stored in a clean, dry environment, away from direct heat sources between -10°C and +50°C and at a humidity of less than 75% RH.

## Shelf life

Shelf life: 5 year from production date when stored at storage conditions described on packaging.

The shelf life as defined above remains a indicative and maximum data, subject to many external and non-controllable factors.

It may never be interpreted as a warranty. Always check that all mask components are in good condition before use

## Disposal

Disposal of the components must be carried out in accordance with local and national regulatory requirements.

## Ordering Information

SAP ID	Legacy ID	Availability		Model #	Description
		AUS	NZ		
7100236942	UU010979498	•	•	FF-601	3M™ Reusable Full Face Mask FF-601-S, Small, 4 ea/Case
7100236941	UU010979480	•	•	FF-602	3M™ Reusable Full Face Mask FF-602-M, Medium, 4 ea/Case
7100236885	UU010979332	•	•	FF-603	3M™ Reusable Full Face Mask FF-603-L, Large, 4 ea/Case



## Filters

SAP ID	Legacy ID	Availability		Model #	Description
		AUS	NZ		
7100260622	UU011502539	•	•	DT-1135E	3M™ Particulate Filter PF10 P3 & PAPR-P3 DT-1135E, 10 ea/Case
7100264834	UU011546916	•	•	DT-4001E	3M™ Gas & Vapour Filter GF22 A2 DT-4001E, 10 ea/Case
7100260646	UU011502554	•	•	DT-4031E	3M™ Combination Filter DT-4031E, CF22 A2P3, 10 ea/Case
7100260644	UU011502570	•	•	DT-4035E	3M™ Combination Filter DT-4035E, CF22 A2B2P3, 10 ea/Case
7100260627	UU011507462	•	•	DT-4036E	3M™ Combination Filter CF22 A2B2E1P3 DT-4036E, 10 Each/Case
7100260628	UU011502596	•	•	DT-4045E	3M™ Combination Filter DT-4045E, CF32 A2B2E2K2P3 and PAPR-B1E1K1P3, 10 ea/Case
7100260645	UU011502588	•	•	DT-4046E	3M™ Combination Filter CF32 A2B2E2K2HgP3 DT-4046E, 10 Each/Case
7100264837	UU011546965	•	•	DT-4047E	3M™ Combination Filter CF32 AXP3 DT-4047E, 10 ea/Case
7100236853	UU010979753	•	•	SS-6601/SC-6601	3M™ Prefilter and Prefilter Holder SS-6601, 5 ea/Case
7100236854	UU010979779	•	•	SS-6600/SC-6600	3M™ Prefilter SS-6600, 100 ea/Case
7100237883	XP100544442	•	•	SS-6607/SC-6607	3M™ Filter Cover SS-6607, 10 ea/Case
7012917340	XP100218930	•	•	SS-6603 (5052694)	3M™ Scott™ Filter Shower Cover SS_6603/5052694

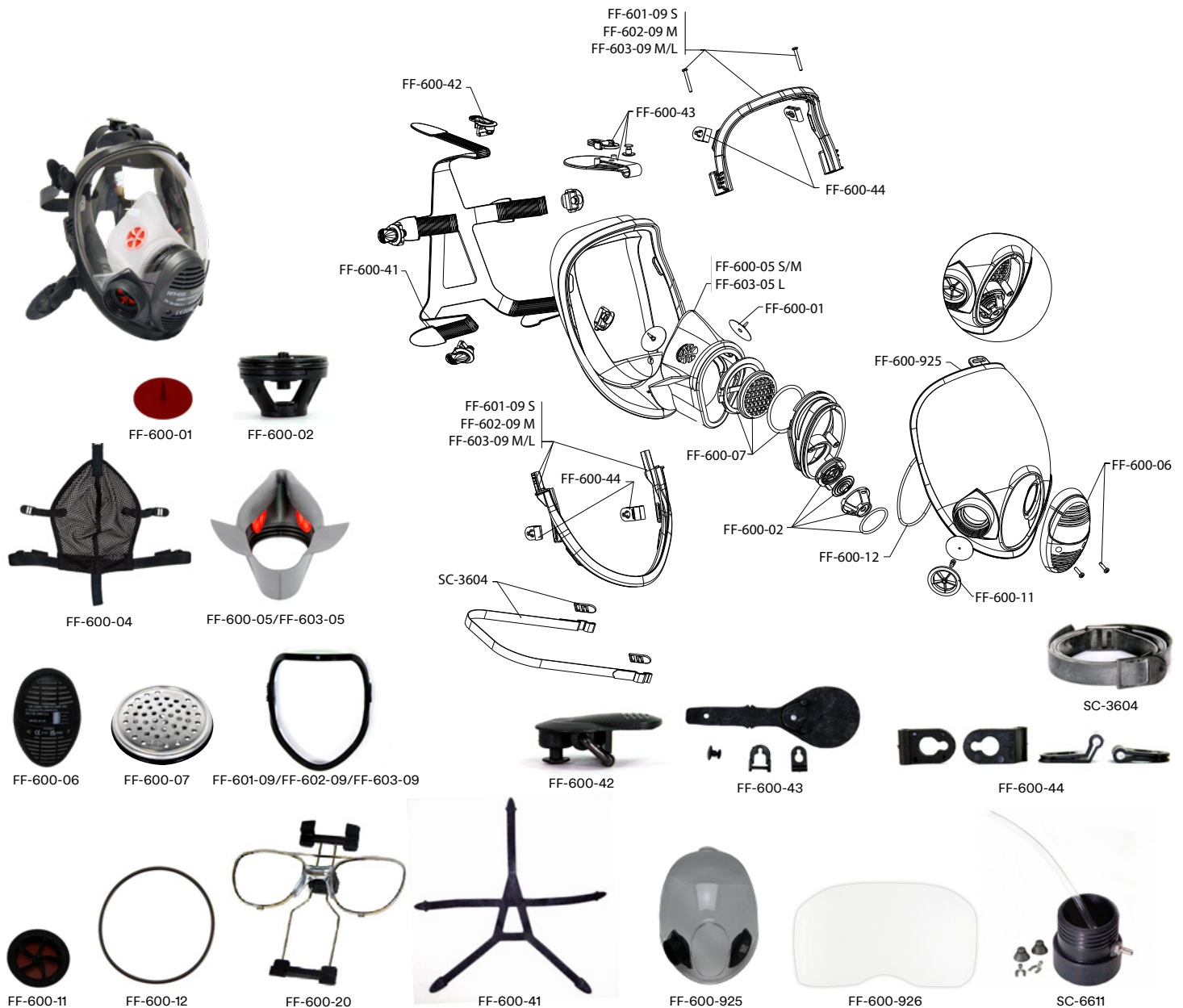

## Spare Parts

SAP ID	Legacy ID	Availability		Model #	Description
		AUS	NZ		
7100265031	XP100544756	•	•	FF-600-01	3M™ Scott™ Inhalation Valve for FF-600/FF-600F, FF-600-01, 50 ea/Case
7100266046	UU011589072	•	•	FF-600-02	3M™ Scott™ Exhalation Valve Assembly for FF-600, FF-600-02 5 ea/Case
7100236819	UU010979548	•	•	FF-600-04	3M™ Scott™ Polynet Head Harness FF-600/FF-600F, FF-600-04
7100265027	UU011544549	•	•	FF-600-05	3M™ Scott™ Nose Cup Assembly Small/Medium for FF-600/FF-600F, FF-600-05 1 ea/Case
7100265233	UU011544556	•	•	FF-603-05	3M™ Scott™ Nose Cup Assembly Large for FF-600/FF-600F, FF-603-05, 1 ea/Case
7012917485	XP100065596	•	•	FF-600-06	3M™ Scott™ Front Fitting For for FF-600, 1033085/FF-600-06
7100266047	UU011589130	•	•	FF-600-07	3M™ Scott™ Speech Diaphragm Assembly for FF-600/FF-600F, FF-600-07, 10 ea/Case
7100265057	UU011565809	•	•	FF-601-09	3M™ Scott™ Visor Frame Assembly Small for FF-600/FF-600F, FF-601-09
7100265059	UU011565775	•	•	FF-602-09	3M™ Scott™ Visor Frame Assembly Medium for FF-600/FF-600F, FF-602-09
7100265047	UU011565759	•	•	FF-603-09	3M™ Scott™ Visor Frame Assembly Medium/Large for FF-600/FF-600F, FF-603-09

SAP ID	Legacy ID	Availability		Model #	Description
		AUS	NZ		
7100265046	UU011565742	•	•	FF-600-11	3M™ Scott™ Inhalation Valve Seat Set for FF-600/FF-600F, FF-600-11
7100236822	UU010979126	•	•	FF-600-12	3M™ Scott™ Front Fitting Gasket for FF-600/FF-600F, FF-600-12, 20 ea/Case
7100236821	UU010979514	•	•	FF-600-20	3M™ Scott™ Spectacle Kit for FF-600/FF-600F, FF-600-20 4 ea/Case
7100265053	UU011565734	•	•	FF-600-41	3M™ Scott™ Head Harness Assembly for FF-600/FF-600F, FF-600-41 2 ea/Case
7100265077	UU011566047	•	•	FF-600-42	3M™ Scott™ Buckle And Roller Pack for FF-600/FF-600F, FF-600-42
7100265241	UU011565767	•	•	FF-600-43	3M™ Scott™ Head Harness Clips for FF-600/FF-600F, FF-600-43
7012917510	XP100065638	•	•	FF-600-44	3M™ Scott™ Hinge Pack For FF-600/FF-600F, 1033128/FF-600-44, 5 Pack/Case
7100236997	UU011589148	•	•	FF-600-925	3M™ Scott™ Standard Visor for FF-600, FF-600-925 4 ea/Case
7100236084	XP100545068	•	•	FF-600-926	3M™ Scott™ Visor Peel Offs for FF-600/FF-600F, FF-600-926 20 ea/Case
7100265981	UU011600176	•	•	SC-3604	3M™ Neck Strap Assembly SC-3604, 1 ea/Case
7100265515	UU011580360	•	•	SC-6611/RXFTA/STAN	3M™ Fit Test Adapter SC-6611 DIN40, QNFT-CNC 1 ea/Case

## Important Notice

To the extent permitted by law, 3M shall not be liable for any loss or damage including any loss of business, loss of profits, or for any indirect, special, incidental or consequential loss or damage arising from reliance upon any information herein provided by 3M. Nothing in this statement will be deemed to exclude or restrict 3M's liability for death or personal injury arising from its negligence.

**SCAN OR CLICK FOR:**



QR-CAT-PAPR  
PAPR Catalogue Section



QR-CAT-RR  
Reusable Respirator Catalogue Section



QR-CAT-FULL  
Full Personal Safety Division Catalogue

## Technical Statement

**Technical Information:** The technical information, guidance, and other statements contained in this document or otherwise provided by 3M are based upon records, tests, or experience that 3M believes to be reliable, but the accuracy, completeness, and representative nature of such information is not guaranteed. Such information is intended for people with knowledge and technical skills sufficient to assess and apply their own informed judgment to the information. No license under any 3M or third party intellectual property rights is granted or implied with this information.

**Product Selection and Use:** Many factors beyond 3M's control and uniquely within user's knowledge and control can affect the use and performance of a 3M product in a particular application. As a result, customer is solely responsible for evaluating the product and determining whether it is appropriate and suitable for customer's application, including conducting a workplace hazard assessment and reviewing all applicable regulations and standards. Failure to properly evaluate, select, and use a 3M product in accordance with all applicable instructions and with appropriate safety equipment, or to meet all applicable safety regulations, may result in injury, sickness, death, and/or harm to property.



**3M Australia Pty Ltd**  
**Personal Safety Division**  
 Bldg A, 1 Rivett Road  
 North Ryde NSW 2113  
 Customer Service: 1300 363 565  
 Email: 3msupport.safety.au@mmm.com  
 Web: www.3M.com/au/ppesafety

**3M New Zealand Ltd**  
**Personal Safety Division**  
 94 Apollo Drive, Rosedale  
 Auckland 0632  
 Customer Service: 0800 252 627  
 Email: 3msupport.safety.nz@mmm.com  
 Web: www.3M.com/nz/ppesafety

3M is a trademark of 3M Company.  
 © 3M 2025. All rights reserved.

# 3M™ DT-Series Particulate Filter PF-10 DT-1135E P3 & PAPR-P3

## Technical Data Sheet

### Description

The 3M™ DT-Series DT-1135E PF10 Particulate filter is approved for use only with the 3M FF-300, FF-600, FF-600F full face and PF-600E-ASB Powered Air Purifying Respirator.

3M™ DT-Series filters have a 40mm thread connection.

3M™ DT-Series formerly known as Scott Safety Pro2000 Series Filters.



### Cleaning and Storage

The product **MUST NOT** be immersed in water/liquid during cleaning. After use, an opened filter must be sealed tightly in an airtight container if it is to be reused.

For filters in the manufacturer's packing, under normal conditions, you can store the filters for the recommended storage period that is marked on the filter. Store this sealed package between -10 to 50 °C and below 75% RH.

The storage period (month and year) for filters is marked on the filter. Never clean the filters with compressed air or compressed water.

After use, the filters are special refuse. Make sure that they are disposed of according to the filtered substance (gases or particles) in accordance with current waste treatment regulations.

### Disposal

If the product is to be disposed of, it should be dismantled from the respirator and disposed of as solid waste. Please see local authority regulations for disposal advice and locations.

### Materials

#### Colour Code

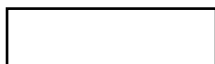

#### Protect against

**P3 & PAPR-P3**

Solid & liquid, radioactive & toxic particles & microorganisms eg, bacteria, enzymes

### Use Limitations

Replace 3M™ Particulate Filters when it becomes difficult to breathe comfortably (this will vary from individual to individual) or the filter becomes dirty or physical damage occurs.

### Standard

Certified to AS/NZS 1716:2012.

### Suitable facepieces for DT-Series Filters and Cartridges



FF-300



FF-600



FF-600F

Export controlled product.  
Document required to be signed upon purchase.

### Compatible with:



PF-600E-ASB

Refer to Powered Air Purifying Respirator catalogue section for more information

## Specifications

Feature	DT-1135E P3 & PAPR-P3	AS/NZS 1716 Requirement
Typical Weight	96g	max 500g with full face respirator
<b>Dimensions</b>		
Height	60mm	
Diameter	110mm	
Volume	110ml	
Thread	40mm	
<b>Other Data</b>		
Composition	Polypropylene - reinforced Micro glass fibre filtration media	
Shelf Life	10 years from production date when stored at storage conditions described on packaging.	
Storage temperature	-10°C to +50°C (factory sealed) and below 75%RH	

See limitations of use 3M™ instructions of use for DT-Series filters.

The shelf life indicates the maximum period of time during which the product can be stored before use. It must be stored in accordance with manufacturer's instructions (as stated in the UI and on the packaging).

## Ordering Information

SAP ID	Legacy ID	Availability		Model #	Description
		AUS	NZ		
7100260622	UU011502539	•	•	DT-1135E	3M™ Particulate Filter PF10 P3 & PAPR-P3 DT-1135E, 10 ea/Case



SS-6601



SS-6600



SS-6607



SS-6603

## Pre-filters and Accessories

SAP ID	Legacy ID	Availability		Model #	Description
		AUS	NZ		
7100236853	UU010979753	•	•	SS-6601/SC-6601	3M™ Prefilter and Prefilter Holder SS-6601, 5 ea/Case
7100236854	UU010979779	•		SS-6600/SC-6600	3M™ Prefilter SS-6600, 100 ea/Case
7100237883	XP100544442	•		SS-6607/SC-6607	3M™ Filter Cover SS-6607, 10 ea/Case
7012917340	XP100218930	•		SS-6603 (5052694)	3M™ Scott™ Filter Shower Cover SS-6603/5052694

## Important Notice

To the extent permitted by law, 3M shall not be liable for any loss or damage including any loss of business, loss of profits, or for any indirect, special, incidental or consequential loss or damage arising from reliance upon any information herein provided by 3M. Nothing in this statement will be deemed to exclude or restrict 3M's liability for death or personal injury arising from its negligence.



## Technical Statement

**Technical Information:** The technical information, guidance, and other statements contained in this document or otherwise provided by 3M are based upon records, tests, or experience that 3M believes to be reliable, but the accuracy, completeness, and representative nature of such information is not guaranteed. Such information is intended for people with knowledge and technical skills sufficient to assess and apply their own informed judgment to the information. No license under any 3M or third party intellectual property rights is granted or implied with this information.

**Product Selection and Use:** Many factors beyond 3M's control and uniquely within user's knowledge and control can affect the use and performance of a 3M product in a particular application. As a result, customer is solely responsible for evaluating the product and determining whether it is appropriate and suitable for customer's application, including conducting a workplace hazard assessment and reviewing all applicable regulations and standards. Failure to properly evaluate, select, and use a 3M product in accordance with all applicable instructions and with appropriate safety equipment, or to meet all applicable safety regulations, may result in injury, sickness, death, and/or harm to property.



**3M Australia Pty Ltd**  
Personal Safety Division  
Bldg A, 1 Rivett Road  
North Ryde NSW 2113  
Customer Service: 1300 363 565  
Email: [3msupport.safety.au@mmm.com](mailto:3msupport.safety.au@mmm.com)  
Web: [www.3M.com/au/ppesafety](http://www.3M.com/au/ppesafety)

**3M New Zealand Ltd**  
Personal Safety Division  
94 Apollo Drive, Rosedale  
Auckland 0632  
Customer Service: 0800 252 627  
Email: [3msupport.safety.nz@mmm.com](mailto:3msupport.safety.nz@mmm.com)  
Web: [www.3M.com/nz/ppesafety](http://www.3M.com/nz/ppesafety)

3M and Scott are trademarks of 3M Company. © 3M 2025. All rights reserved.