

OPU203

OPU-FPKG/AS

Photoelectric sensors

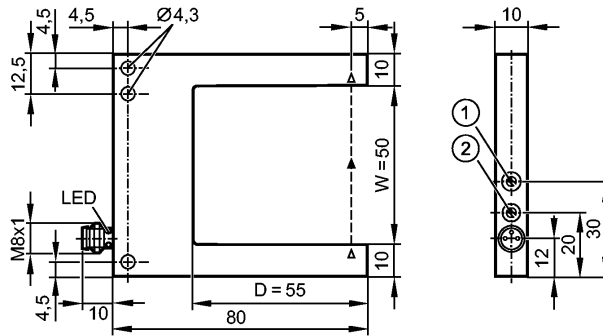

1: potentiometer sensitivity
2: output function switch



Product characteristics

Optical fork sensor

Connector

Electrical data

Electrical design	DC PNP
Operating voltage [V]	10...35 DC
Current consumption [mA]	< 30
Type of light	Red light 660 nm
Protection class	III
Reverse polarity protection	yes

Outputs

Output function	light-on/dark-on mode selectable
Voltage drop [V]	< 2.8
Current rating [mA]	200
Short-circuit protection	pulsed
Overload protection	yes
Switching frequency [Hz]	4000

Range

Smallest detectable object [mm]	0.5
---------------------------------	-----

Environment

Ambient temperature [°C]	-25...60
Protection	IP 67

Tests / approvals

EMC	EN 60947-5-2
MTTF [Years]	572

Mechanical data

Fork depth D [mm]	55
Fork width W [mm]	50
Housing materials	housing: diecast zinc black anodised; lens: glass
Weight [kg]	0.119

Displays / operating elements

Output status indication LED	yellow
------------------------------	--------

Electrical connection

OPU203

OPU-FPKG/AS

Photoelectric sensors

Connection

M8 connector

Wiring

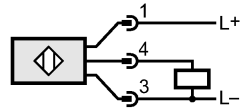
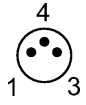

Remarks

Pack quantity

[piece]

1

ifm electronic gmbh • Friedrichstraße 1 • 45128 Essen — We reserve the right to make technical alterations without prior notice. — GB — OPU203 — 16.02.2009