



Plug-in relay complete unit 4 W, 24 V AC LED module red Socket with logic isolation Spring-type terminal (push-in)

product brand name	SIRIUS
product designation	Coupling relay with plug-in relay
product type designation	LZS
General technical data	
display version LED	Yes
percental drop-out voltage related to the input voltage	30 %
protection class IP	IP20
operating frequency without load	36 000 1/h
operating frequency with load	360 1/h
switching behavior	monostable
design of the switching function	changeover switch
design of the switching function positively driven	No
mechanical service life (operating cycles) typical	20 000 000
electrical endurance (operating cycles) at AC-15 at 230 V typical	250 000
thermal current	6 A
reference code according to IEC 81346-2	K
Substance Prohibitance (Date)	05/01/2012
Control circuit/ Control	
control supply voltage at AC	
• at 50 Hz rated value	24 V
• at 60 Hz rated value	24 V
control supply voltage frequency	
• 1 rated value	50 Hz
• 2 rated value	60 Hz
supply voltage frequency for auxiliary and control circuit rated value	50 ... 60 Hz
operating range factor control supply voltage rated value at AC at 50 Hz	
• initial value	0.9
• full-scale value	1.1
operating range factor control supply voltage rated value at AC at 60 Hz	
• initial value	0.9
• full-scale value	1.1
design of the relay operating mechanism	poled
product component plug-in socket	Yes
design of the snap-on socket base	Socket with logic isolation
Short-circuit protection	
design of the fuse link for short-circuit protection of the auxiliary switch required	fuse gG: 6 A

Auxiliary circuit		
type of switching contact	Changeover contact	
material of switching contacts	AgNi 90/10	
number of NC contacts for auxiliary contacts	0	
number of NO contacts for auxiliary contacts	0	
number of CO contacts for auxiliary contacts	4	
operational current of auxiliary contacts at AC-15 <ul style="list-style-type: none">at 250 V	2 A	
operational current at DC-13 at 24 V rated value	4 A	
operational current of auxiliary contacts at DC-13 <ul style="list-style-type: none">at 24 V	4 A	
Main circuit		
type of voltage	AC	
ampacity of the output relay at DC-13 <ul style="list-style-type: none">at 24 V	4 A	
Display		
display version as status display by LED	LED red	
Connections/ Terminals		
product function removable terminal	No	
type of electrical connection	spring-loaded terminals	
type of connectable conductor cross-sections <ul style="list-style-type: none">solidfinely stranded with core end processingfinely stranded without core end processingfor AWG cables solidfor AWG cables stranded	1x (0,75 ... 1,5), 2x (0,75 ... 1,0), 2x 1,5 1x (0,75 ... 1,5), 2x 0,75 1x (0,75 ... 1,5), 2x (0,75 ... 1,0), 2x 1,5 1x (18 ... 16), 2x (18 ... 16) 1x (18 ... 16), 2x (18 ... 16)	
connectable conductor cross-section <ul style="list-style-type: none">solidfinely stranded with core end processingfinely stranded without core end processing	0.75 ... 1.5 mm² 0.75 ... 1.5 mm² 0.75 ... 1.5 mm²	
AWG number as coded connectable conductor cross section <ul style="list-style-type: none">solidstranded	18 ... 16 18 ... 16	
Installation/ mounting/ dimensions		
mounting position	any	
fastening method	snap-on mounting	
height	98 mm	
width	28 mm	
depth	79 mm	
Ambient conditions		
ambient temperature <ul style="list-style-type: none">during operationduring storageduring transport	-40 ... +70 °C -25 ... +70 °C -25 ... +70 °C	
Approvals Certificates		
General Product Approval		Declaration of Conformity
		other

[Confirmation](#)



[Confirmation](#)

Further information

Siemens has decided to exit the Russian market (see here).

<https://press.siemens.com/global/en/pressrelease/siemens-wind-down-russian-business>

Siemens is working on the renewal of the current EAC certificates.

Please contact your local Siemens office on the status of validity of the EAC certification if you intend to import or offer to supply these products to an EAC relevant market (other than the sanctioned EAEU member states Russia or Belarus).

Information on the packaging

<https://support.industry.siemens.com/cs/ww/en/view/109813875>

Information- and Downloadcenter (Catalogs, Brochures,...)

<https://www.siemens.com/ic10>

Industry Mall (Online ordering system)

<https://mall.industry.siemens.com/mall/en/en/Catalog/product?mlfb=LZS:PT5D5R24>

Cax online generator

<http://support.automation.siemens.com/WW/CAXorder/default.aspx?lang=en&mlfb=LZS:PT5D5R24>

Service&Support (Manuals, Certificates, Characteristics, FAQs,...)

<https://support.industry.siemens.com/cs/ww/en/ps/LZS:PT5D5R24>

Image database (product images, 2D dimension drawings, 3D models, device circuit diagrams, EPLAN macros, ...)

http://www.automation.siemens.com/bilddb/cax_de.aspx?mlfb=LZS:PT5D5R24&lang=en

Characteristic: Derating

<https://support.industry.siemens.com/cs/ww/en/ps/LZS:PT5D5R24/manual>

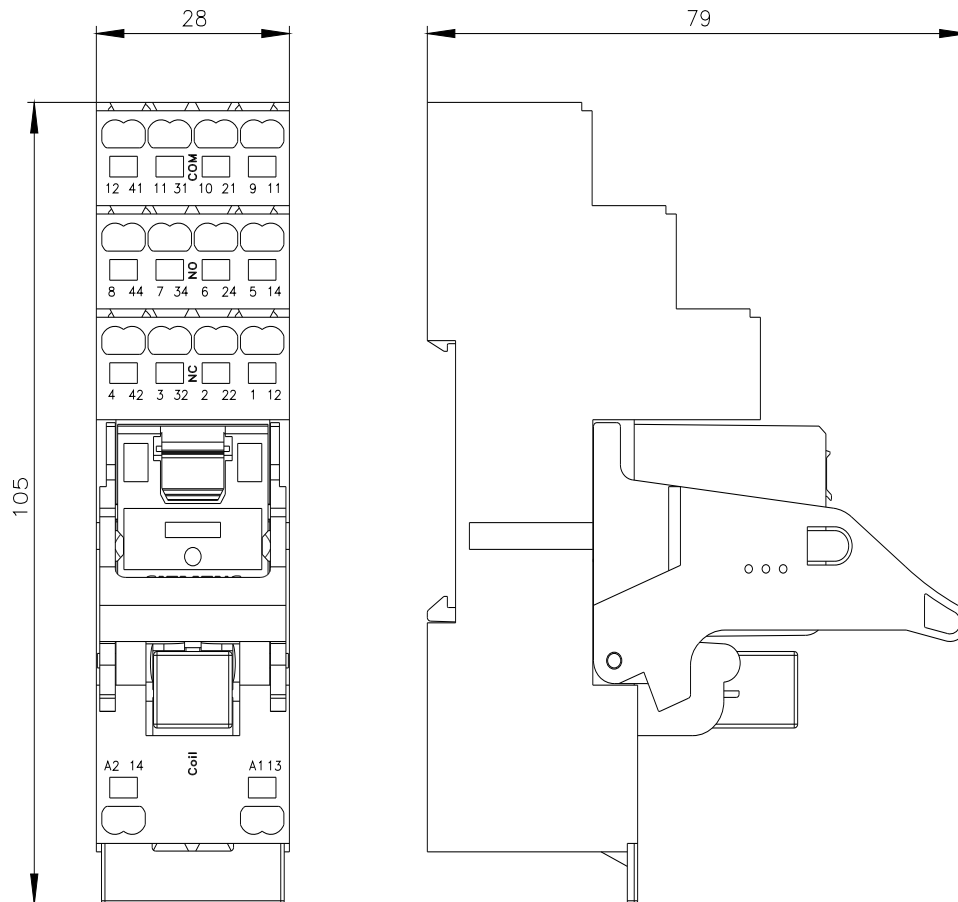

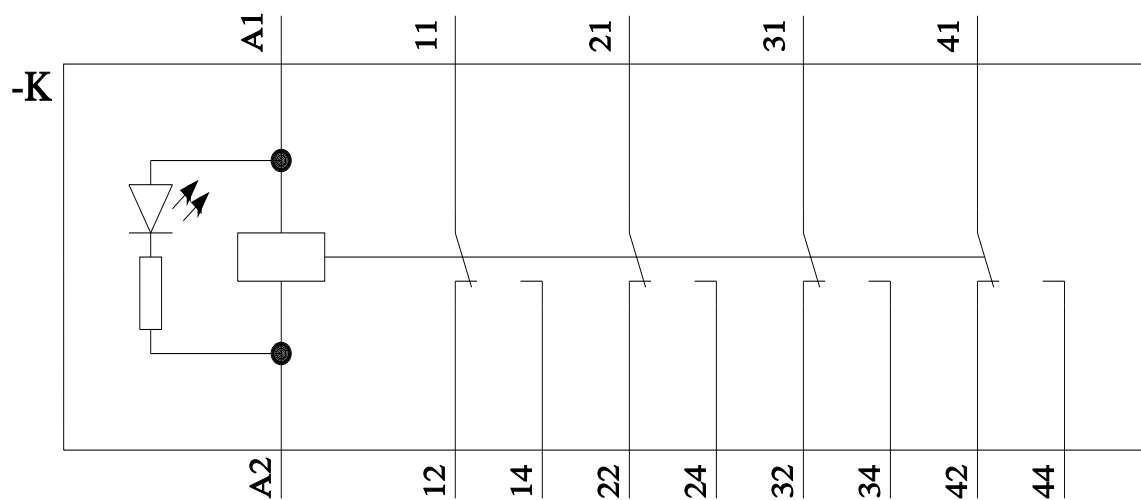

last modified:

10/13/2021 