

**Type Number**..... 370  
**Designation IEC**..... SR 69  
**System**..... Silver oxide/ Zinc /  
 NaOH - Electrolyte

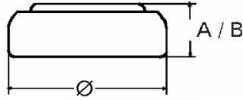

**Nominal Voltage**..... 1,55 V  
**Typical Capacity C**..... 30 mAh  
 Load 33 kOhm, at 20°C down to 1.2 V

**Weight (approx.)**..... 0,57 g  
**Volume**..... 0,14 ccm

**Temperature Ranges** min max.  
 Storage..... 10°C 30°C  
 Discharge..... -10°C 60 °C

**Dimensions** min max.  
 Diameter (A)..... 9,25 mm 9,5 mm  
 Height (A/B)..... 1,85 mm 2,1 mm

**Segment**..... Watch

**Typical Capacities (at 20°C)**

Discharge Type	Load	End Voltage:	1.2 V
Continuous 24h/d, 7d/w	33000 Ω	Time [h]:	710
		Capacity [mAh]:	30
		Energy [mWh]:	43

**No publication or circulation of data to third parties without consent of VARTA Consumer Batteries**

All Data contained herein is for single cells For battery applications, performance data may vary from single cell data, depending on specific battery configuration