



FAG

SES208-307-L

Plummer block housing

Split plummer block housing for various bearing designs. The SNV series will be replaced by the new SES series in 2022.

Technical information

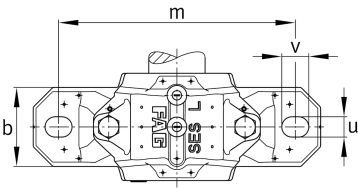

Main Dimensions & Performance Data

D	80 mm	Outside diameter bearing
a	205 mm	Length base
h ₁	108 mm	Height
g	85 mm	Width housing body
K	39 mm	Width bearing seat
≈m	2.85 kg	Weight

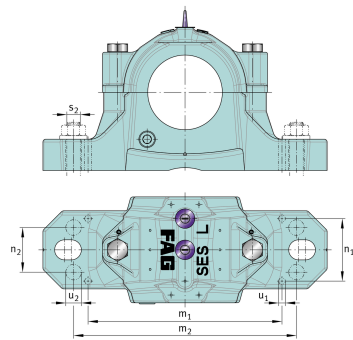
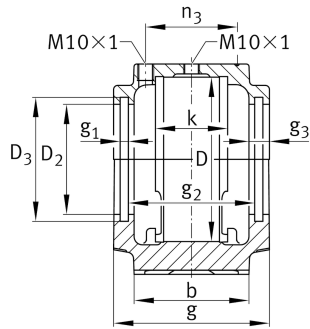
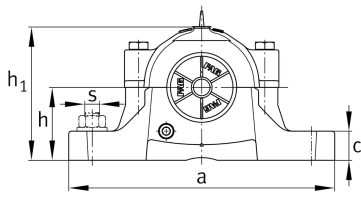

Dimensions

b	60 mm	Width base
c	25 mm	Height base
h	60 mm	Base to shaft centerline height
m	170 mm	Distance fixing bore
s	12.7 mm	Screw size
s	M12	Size of fixing screws
u	15 mm	Width slot
v	20 mm	Length slot
D 2	62 mm	Diameter sealing
D 3	70.5 mm	Diameter sealing groove
D 5	68.7 mm	Outside diameter sealing labyrinth
g 1	5 mm	Width sealing groove
g 2	69 mm	Distance sealing
g 3	11 mm	Wall thickness
g 4	28 mm	Distance oil lubrication
m 1	137 mm	Distance holes aligned pins m1
n 3	52 mm	Distance lubrication
n 4	71 mm	Distance lubrication sealing
u 1	4 mm	Bore diameter u1
u 2	11 mm	Bore diameter u2