

Locknuts & earthing locknuts

Technical specifications

Metallic - ISO threads

- Material: nickel-plated brass / stainless steel 316L on demand
- ISO threadforms to EN 60423

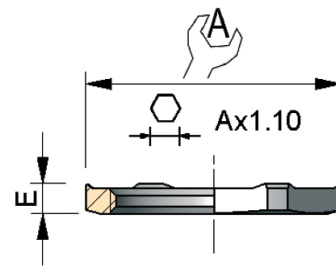
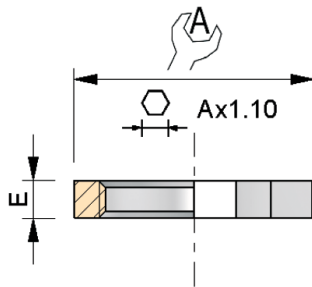

Locknut

THREAD SIZE	A	E	ORDER UNIT	CATALOG NUMBER
M8	10.0	2.5	20	CAP220894
M10	12.0	3.0	20	CAP221094
M12	23.0	3.0	20	CAP221294
M16	29.0	4.0	20	CAP221694
M20	35.0	4.0	20	CAP222094
M25	44.0	4.5	20	CAP222594
M32	60.0	4.8	10	CAP223294
M40	69.0	5.0	10	CAP224094
M50	87.0	6.5	1	CAP225094
M63	103.0	6.5	1	CAP226394
M75	104.0	8.0	1	CAP227594
M90	122.0	8.0	1	CAP229094
M110	132.0	9.0	1	CAP221104

Earthing Locknut

THREAD SIZE	A	E	ORDER UNIT	CATALOG NUMBER
M10	12.0	2.5	20	CAP229104
M12	14.0	3.0	20	CAP229124
M16	18.0	3.0	20	CAP229164
M20	23.0	3.0	20	CAP229204
M25	28.0	3.0	20	CAP229254
M32	36.0	3.5	10	CAP229324
M40	44.0	4.0	10	CAP229404
M50	54.0	5.0	1	CAP229504
M63	70.0	6.0	1	CAP229634

Metallic - Pg threads

- Material: nickel-plated brass / stainless steel 316L on demand
- Pg electrical threadforms-guide: UTE C 68-312 and DIN40430

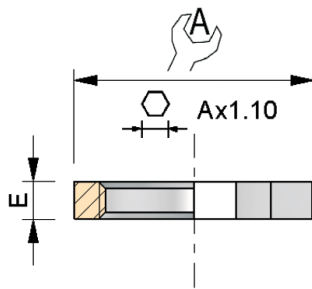

Locknut

THREAD SIZE	A	E	ORDER UNIT	CATALOG NUMBER
Pg7	15.0	3.0	20	CAP280704
Pg9	18.0	3.0	20	CAP280904
Pg11	21.0	3.0	20	CAP281104
Pg13	23.0	3.0	20	CAP281304
Pg16	26.0	3.0	20	CAP281604
Pg21	32.0	3.5	20	CAP282104
Pg29	41.0	4.0	10	CAP282904
Pg36	51.0	5.0	10	CAP283604
Pg42	58.0	5.0	1	CAP284204
Pg48	64.0	6.0	1	CAP284884
N°48 NFC	64.0	6.0	1	CAP284804

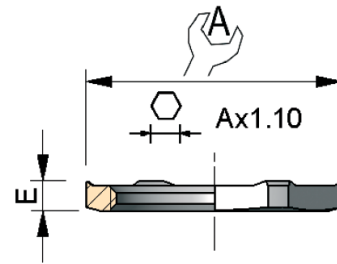

Earthing Locknut

THREAD SIZE	A	E	ORDER UNIT	CATALOG NUMBER
Pg7	15.0	3.0	20	CAP280794
Pg9	18.0	3.0	20	CAP280994
Pg11	21.0	3.0	20	CAP281194
Pg13	23.0	3.0	20	CAP281394
Pg16	26.0	3.0	20	CAP281694
Pg21	32.0	3.5	20	CAP282194
Pg29	41.0	4.0	10	CAP282994
Pg36	51.0	5.0	10	CAP283694
Pg42	58.0	5.0	5	CAP284294
Pg48	64.0	6.0	5	CAP284994
N°48 NFC	64.0	6.0	1	CAP284894

Polyamide - ISO threads

- Material: polyamide 6/6, colour grey
- ISO threadforms to EN 60423

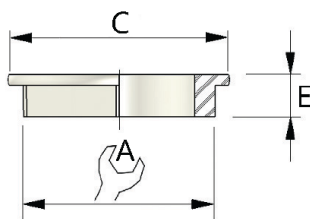

Locknut

THREAD SIZE	A	C	E	SMALL PACKAGING		LARGE PACKAGING	
				ORDER UNIT	CATALOG NUMBER	ORDER UNIT	CATALOG NUMBER
M12	18.0	19.5	5.0	20	CAP261273	500	CAP261277
M16	22.0	24.3	5.0	20	CAP261673	500	CAP261677
M20	26.0	28.5	6.0	20	CAP262073	500	CAP262077
M25	32.0	35.3	6.0	20	CAP262573	500	CAP262577
M32	41.0	46.0	7.0	10	CAP263273	100	CAP263277
M40	50.0	55.5	7.0	10	CAP264073	100	CAP264077
M50	60.0	66.0	8.0	5	CAP265073	100	CAP265077
M63	75.0	82.2	8.0	5	CAP266373	-	-

Polyamide - Pg threads

- Material: polyamide 6/6, colour grey
- Pg electrical threadforms-guide: UTE C 68-311 and DIN40430

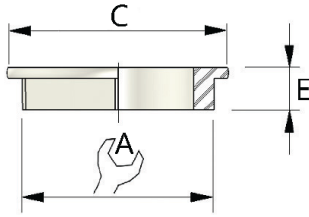

Locknut

THREAD SIZE	A	C	E	SMALL PACKAGING		LARGE PACKAGING	
				ORDER UNIT	CATALOG NUMBER	ORDER UNIT	CATALOG NUMBER
Pg7	15.0	17.3	4.5	20	CAP260770	1 000	CAP260710
Pg9	19.0	21.9	4.5	20	CAP260970	1 000	CAP260910
Pg11	22.0	25.4	5.0	20	CAP261170	1 000	CAP261110
Pg13	24.0	27.7	5.5	20	CAP261370	1 000	CAP261310
Pg16	27.0	31.1	6.0	20	CAP261670	500	CAP261610
Pg21	32.0	36.9	6.5	20	CAP262170	500	CAP262110
Pg29	41.0	45.2	7.5	10	CAP262970	100	CAP262910
Pg36	54.0	59.5	9.0	10	CAP263670	100	CAP263610
Pg42	60.0	66.0	9.0	5	CAP264270	100	CAP264210
Pg48	67.0	73.5	9.5	5	CAP264878	-	-
N ^o 48 NFC	67.0	73.5	9.5	1	CAP264870	-	-