



ENGLISH

Datasheet

RS Pro Oval Gear Flow Meter

Stock Number: 447-4449



The compact rugged OG2 oval gear flowmeter is designed to give high performance with a low cost of ownership. It has a standard flow range from 0.03 to 4 L/min on 30 cSt oil and 0.15 to 4 L/min on water like liquids. It can have totally non-metallic wetted components, PEEK™, ceramic and an elastomer which makes this the ideal choice for the metering of aggressive chemicals. The standard inlet and outlet are 1/4" female threads. For OEM use alternatives, including manifold mountings, are available. The standard model is 316 St St with Viton™ 'O' ring seal.

At the heart of the meter are a pair of toothed oval gears one of which contains chemically resistant magnets. Rotation is detected through the chamber wall by a Hall effect detector or a reed switch giving approximately 1100 pulses per litre passed. The output is an NPN pulse or a voltage free contact closure either of which is readily interfaced with most electronic display or recording devices. This combination of materials and technology ensures a long-life product with reliable, accurate operation throughout.



IDEAL FOR

- Engine test
- Oil flow
- High viscosity fluids
- OEM equipment
- Hazardous areas



FEATURES

- Excellent chemical resistance
- Rugged construction
- Individual calibration
- High viscosity capability
- Low pressure loss
- No flow conditioning required
- Compact meter assembly
- Hall, reed switch or Namur sensor
- Accuracy 1.0% FSD water
0.75% FSD oil

- ±0.5% reading *
- 0.1% repeatability
- IP67/NEMA 4 protection
- Models to 700 Bar
- Non-metallic option

* When used with our metra-smart instrument

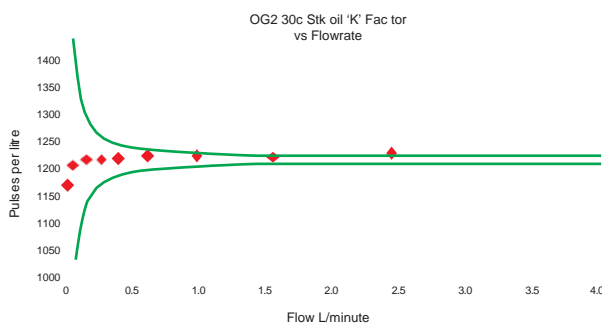



Ordering codes

Model
OG2
Body material
S = 316 St St 50 bar std
P = PEEKTM 10 Bar max
H = Hastelloy C
Temprating
S = 80°C / 158°F
T = 100°C / 212°F
U = 150°C / 300°F
Pressure rating
S/5 = 50 Bar 750 PSI (St St)
1 = 10 Bar 150 PSI (Al /PEEKTM)
4 = 400 Bar 5880 PSI (St St)
7 = 700 Bar 10150 PSI (St St)
SealMaterial
S/V = Viton®
N = Nitrile
E = EPDM
P = PTFE (50 Bar max)
K = Kalrez
DetectorType
S/H = Hall effect
R = Reed switch & Resistor
N = Namur
X = Reed switch (Hazardous area)
Pipe Thread
Q = 1/4" (OG2std)
Connections
B = BSPF
N = NPTF
F = Flanged (specify)

e.g. **OG2-SSS-SSQ-B** is a stainless steel meter rated at 80°C, 50 Bar, Viton™ seal, Hall effect detector and a 1/4" BSP thread.



TECHNICAL SPECIFICATIONS

Sample product codes **	Stainless standard
	OG2-SSS-SSQ-B
Flow range	-Water 0.15 -- 4.0 L/min - 30 cSt Oil 0.03 -- 4.0 L/min
Weted matls	- Body 316 St St - Gears Carbon filled PEEK™ - Seal Viton™ - Magnet Ceramic
Accuracy	-Water ± 1.0% Reading - 30 cSt oil ± 0.75% Reading
Repeatability	± 0.1%
Detector Type	Hall effect
Terminations	M12 instrument socket
Approx 'K' factor - Pulses/Litre	1100

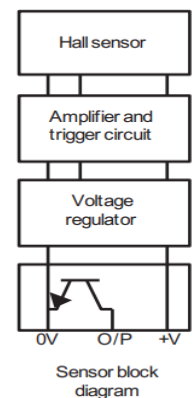
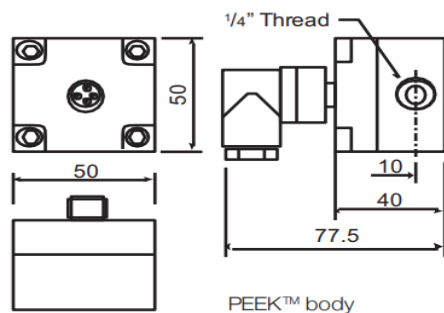
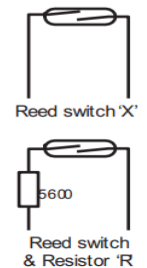
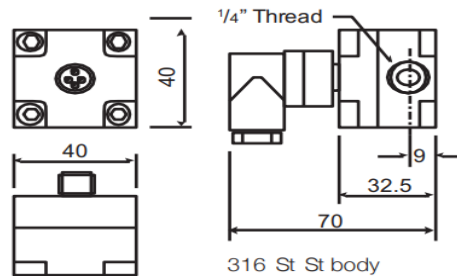

Weight(kg)

St St	50 Bar	0.36
PEEKTM	10 Bar	0.184
St St	400 Bar	3000