

Continuous light element, with integrated LED, yellow, 230 V AC,  
Diameter 70 mm



General technical data	
Product brand name	SIRIUS
Product designation	Continuous light element
Design of the optical signal	continuous light
Type of voltage of the operating voltage	AC
Operating voltage	
• 1 at AC at 50 Hz rated value	230 V
• 1 at AC at 60 Hz rated value	230 V
Relative positive tolerance of the operating voltage	10 %
Relative negative tolerance of the operating voltage	-10 %
Consumed current maximum	35 mA
Service life of LED	100 000 h
Color	yellow
Mounting type	Bayonet
Reference code	
• acc. to DIN EN 61346-2	P
• acc. to DIN EN 81346-2	P

### Mechanical data

Outer diameter of the signal column element	70 mm
---	-------

### Lamp

Product component Light source	Yes
Type of light source	LED
Light intensity	0.91 cd
Light intensity	0.62 ... 1.29 cd

### Ambient conditions

Ambient temperature during operation	-20 ... +50 °C
Protection class IP	IP65
Height	65.5 mm
Width	70 mm

### Certificates/approvals

General Product Approval	EMC	Declaration of Conformity	other
--------------------------	-----	---------------------------	-------



[Confirmation](#)

### Further information

**Information- and Downloadcenter (Catalogs, Brochures,...)**

<http://www.siemens.com/industrial-controls/catalogs>

**Industry Mall (Online ordering system)**

<https://mall.industry.siemens.com/mall/en/en/Catalog/product?mlfb=8WD4450-5AD>

**Cax online generator**

<http://support.automation.siemens.com/WW/CAXorder/default.aspx?lang=en&mlfb=8WD4450-5AD>

**Service&Support (Manuals, Certificates, Characteristics, FAQs,...)**

<https://support.industry.siemens.com/cs/ww/en/ps/8WD4450-5AD>

**Image database (product images, 2D dimension drawings, 3D models, device circuit diagrams, EPLAN macros, ...)**

[http://www.automation.siemens.com/bilddb/cax\\_de.aspx?mlfb=8WD4450-5AD&lang=en](http://www.automation.siemens.com/bilddb/cax_de.aspx?mlfb=8WD4450-5AD&lang=en)

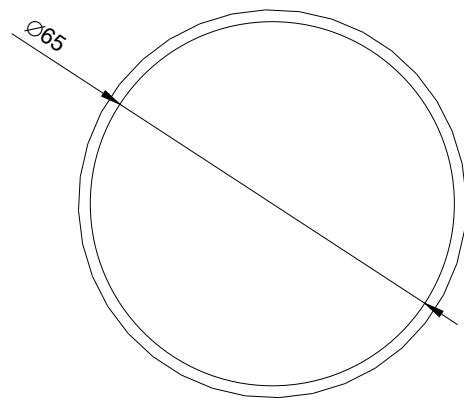
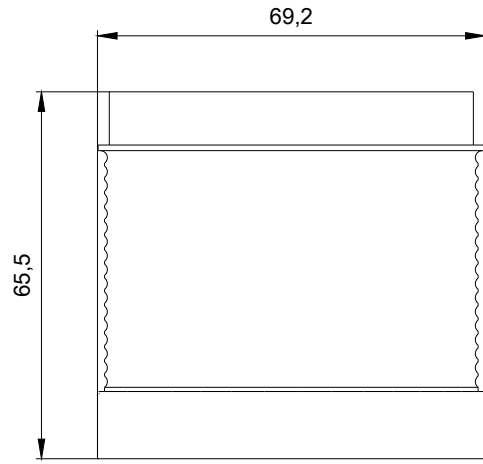

last modified:

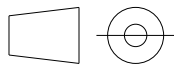

WS 4444;  
 W6.8333; 8WD44...\_ALL  
 11/13/2018