

Self-aligning clip bearing: ECLM-HD

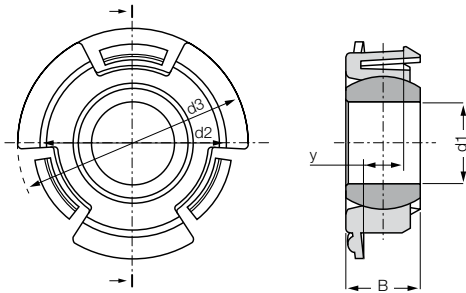

Order key

ECLM-10-05-HD

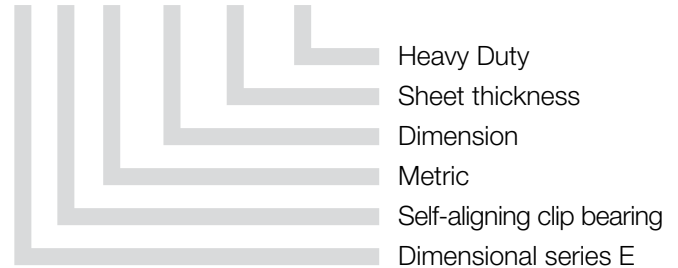

Material:

Housing: **igumid G** ▶ page 1127

Spherical balls: **iglidur® W300** ▶ page 729

Other spherical balls on request ▶ page 725

- High axial and radial loads
- Adjustment of axial and radial clearance by preloading

- Easily clips into sheet metal
- No additional axial fastening necessary
- For sheet thickness 4 to 8 mm

Technical Data

Part number	Max. static compressive strength (short term)		Max. static compressive strength (long term)		Weight [g]
	radial [N]	axial [N]	radial [N]	axial [N]	
ECLM-08-04-HD New!*	1,750	125	875	60	2.0
ECLM-10-05-HD	2,500	150	1,250	75	3.1
ECLM-12-06-HD New!*	3,500	175	1,750	85	3.8
ECLM-20-08-HD New!*	6,000	330	3,000	165	12.0

Dimensions [mm]

Part number	d1 E10	B	d2 ±0.15	d3	y ±0.1	Max. pivot angle
ECLM-08-04-HD New!*	8.0	8.0	18.0	25	4.0	28°
ECLM-10-05-HD	10.0	9.0	22.0	28	5.0	24°
ECLM-12-06-HD New!*	12.0	10.0	24.0	32	6.0	24°
ECLM-20-08-HD New!*	20.0	16.0	36.0	44	8.0	21°

* in this catalog

Spherical bearing materials to choose ▶ page 725



REM:
low-cost



JEM: low
moisture
absorption



J4EM: low-
cost and
low moisture
absorption



J4VEM:
clearance-free
preloaded
spherical ball



delivery from stock
time



prices price list online

www.igus.co.uk/en/eclm-hd