



CIRCUIT-BREAKER, SIZE S0,  
FOR MOTOR PROTECTION, CLASS 10,  
A REL.17...22 A, N REL.286 A,  
SCREW CONNECTION,  
STANDARD BREAKING CAPACITY

### General technical data:

product brand name		SIRIUS
product designation		circuit breaker
Size of the circuit-breaker		S0
Trip class		CLASS 10
Degree of pollution		3
Installation altitude / at a height over sea level / maximum	m	2,000
Protection class IP / on the front		IP20
Ambient temperature		
• during storage	°C	-50 ... +80
• during operating	°C	-20 ... +70
• during transport	°C	80 ... -50
Resistance against shock		25g / 11 ms
Insulation voltage / rated value	V	690
Impulse voltage resistance / rated value	V	6,000
Active power loss / total / typical	W	8
Item designation		
• according to DIN 40719 extendable after IEC 204-2 / according to IEC 750		Q
• according to DIN EN 61346-2		Q

<b>Mechanical operating cycles as operating time / of the main contacts / typical</b>		100,000
<b>Design of the auxiliary switch</b>		transverse
<b>Type of the driving mechanism / motor drive</b>		No
<b>Design of the operating mechanism</b>		selector switch
<b>Product function</b>		
• overload protection		Yes
• phase disturbance recognition		Yes
<b>Product component</b>		
• auxiliary switch		Yes
• undervoltage release mechanism		No
• trip indicator		Yes
<b>Product extension / optional / motor drive</b>		No

Main circuit:		
<b>Number of poles / for main current circuit</b>		3
<b>type of voltage</b>		AC/DC
<b>Operating voltage / at AC-3 / rated value / maximum</b>	V	690
<b>Operating current / at AC-3 / at 400 V / rated value</b>	A	22
<b>Service power / at AC-3</b>		
• at 400 V / rated value	kW	11
<b>Frequency of operation / at AC-3 / according to IEC 60947-6-2 / maximum</b>	1/h	15
<b>Arrangement of electrical connectors / for main current circuit</b>		front side
<b>Adjustable response current</b>		
• of the non-delayed short-circuit release	A	286 ... 286
<b>Adjustable response current</b>		
• of the current-dependent overload release	A	17 ... 22
<b>Continuous current / rated value</b>	A	22
<b>Product extension / auxiliary switch</b>		Yes

Auxiliary circuit:		
<b>Number of NC contacts / for auxiliary contacts / instantaneous switching</b>		1
<b>Number of NO contacts / for auxiliary contacts / instantaneous switching</b>		1
<b>Number of change-over switches / for auxiliary contacts</b>		0
<b>Operating current / of the auxiliary contacts</b>		
• at AC-15		
• at 24 V	A	2
• at 230 V	A	0.5
• at DC-13		

- at 24 V
- at 60 V

A	1
A	0.15

#### Inputs/ Outputs:

##### Number of digital inputs

0

#### Short-circuit:

##### Breaking capacity limit short-circuit current (I<sub>cu</sub>)

- at 400 V / rated value
- at 500 V / rated value
- at 690 V / rated value

kA	50
kA	10
kA	4

##### Design of the electrical connection / for auxiliary and control current circuit

screw-type terminals

##### Design of the overcurrent release and short-circuit release

thermomagnetic

#### Installation/mounting/dimensions:

##### Built in orientation

any

##### Type of mounting

screw and snap-on mounting onto 35 mm standard mounting rail according to DIN EN 50022

##### Width

mm 45

##### Height

mm 97

##### Depth

mm 96

##### Distance, to be maintained, to the ranks assembly

- backwards
- sideways

mm	0
mm	0

##### Product function / removable terminal for auxiliary and control circuit

No

#### Connections:

##### Design of the electrical connection

- for main current circuit

screw-type terminals

##### Type of the connectable conductor cross-section

- for main contacts
  - solid
  - stranded
  - finely stranded
    - with conductor end processing
- for AWG conductors / for main contacts
- for auxiliary contacts
  - solid
  - finely stranded / with conductor end processing
- for AWG conductors / for auxiliary contacts

2x (1 ... 2.5 mm <sup>2</sup> ), 2x (2.5 ... 6 mm <sup>2</sup> )
2x (1 ... 2.5 mm <sup>2</sup> ), 2x (2.5 ... 6 mm <sup>2</sup> )
2x (1 ... 2.5 mm <sup>2</sup> ), 2x (2.5 ... 6 mm <sup>2</sup> )
2x (14 ... 10)
2x (0.5 ... 1.5 mm <sup>2</sup> ), 2x (0.75 ... 2.5 mm <sup>2</sup> )
2x (0.5 ... 1.5 mm <sup>2</sup> ), 2x (0.75 ... 2.5 mm <sup>2</sup> )
2x (18 ... 14)

<b>Conductor cross section that can be connected / for main contacts</b> <ul style="list-style-type: none"> <li>• solid</li> <li>• stranded</li> <li>• stranded wire</li> <li>• with conductor end processing</li> </ul>	mm <sup>2</sup>	1 ... 6
	mm <sup>2</sup>	1 ... 6
	mm <sup>2</sup>	1 ... 6
<b>AWG number / as coded connectable conductor cross-section</b> <ul style="list-style-type: none"> <li>• for main contacts</li> </ul>		14 ... 10
<b>Conductor cross-section that can be connected / for auxiliary contact</b> <ul style="list-style-type: none"> <li>• solid</li> <li>• stranded wire</li> <li>• with conductor end processing</li> </ul>	mm <sup>2</sup>	0.5 ... 2.5
	mm <sup>2</sup>	0.5 ... 2.5
<b>AWG number / as coded connectable conductor cross-section</b> <ul style="list-style-type: none"> <li>• for auxiliary contact</li> </ul>		18 ... 14

#### Certificates/approvals:

##### General Product Approval



[KETI](#)

[ROSTEST](#)



For use in  
hazardous  
locations

[DEKRA EXAM,  
DMT](#)

Test Certificates

[Manufacturer](#)

##### Shipping Approval



GL



LRS



RMRS

##### other

[Manufacturer](#)

[other](#)

#### Safety:

Protection against electrical shock

finger-safe

#### Further information:

Information- and Downloadcenter (Catalogs, Brochures,...)

<http://www.siemens.com/industrial-controls/catalogs>

Industry Mall (Online ordering system)

<http://www.siemens.com/industrial-controls/mall>

CAX-Online-Generator

<http://www.siemens.com/cax>

Service&Support (Manuals, Certificates, Characteristics, FAQs,...)

<http://support.automation.siemens.com/WW/view/en/3RV1021-4CA15/all>

Image database (product images, 2D dimension drawings, 3D models, device circuit diagrams, ...)

[http://www.automation.siemens.com/bilddb/cax\\_en.aspx?mlfb=3RV1021-4CA15](http://www.automation.siemens.com/bilddb/cax_en.aspx?mlfb=3RV1021-4CA15)

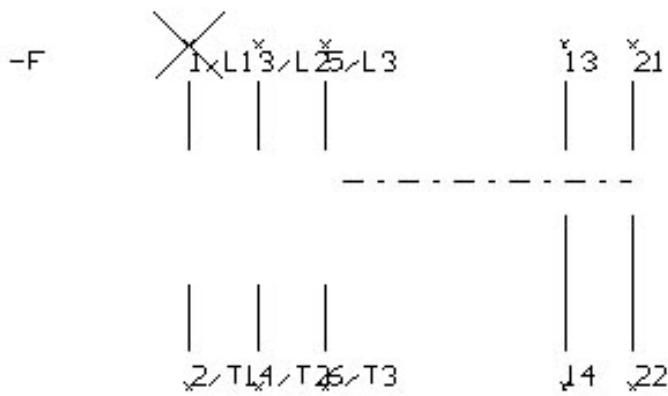
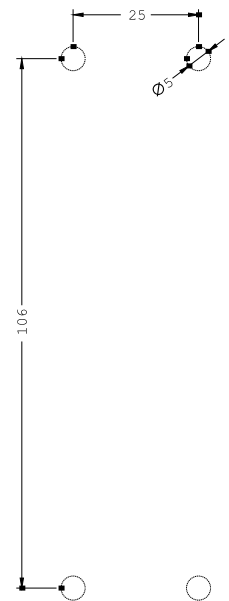
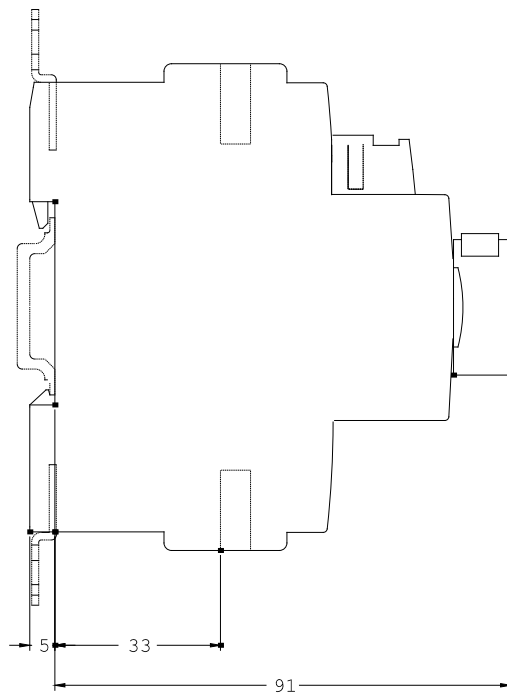
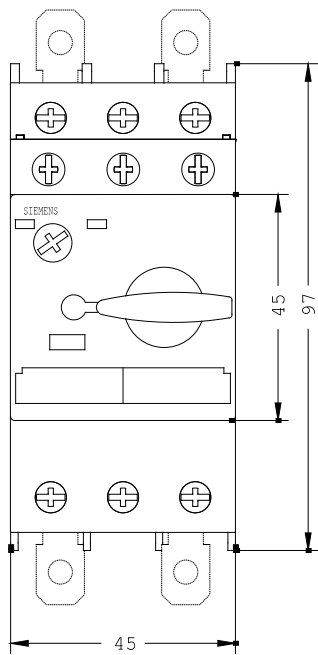

last change:

Feb 6, 2012