

NEW

Compact Push-pull Circular Connector

JB5 Series

CONNECTOR

MB-0101-2

January 2004

Receptacle



Plug

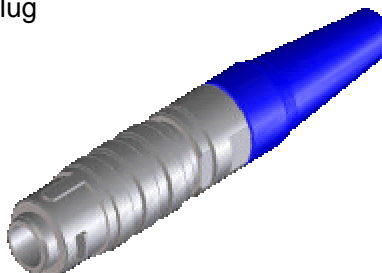

<<Outline>>

The JB5 Series connectors are compact circular connectors with IP68 waterproof-rating and Push-Pull lock structures which enable easy insertion and removal. They have high environmental durability and user-friendly designs and can be widely used in medical, measurement and communication equipment as well as handheld PCs, scanners and other small equipment.

Features

- Waterproof rating: IP68 protection level (when mated and receptacle itself)
- Max. of 8 contacts for a max. connector outside diameter of 14.8mm dia.
(plug outside diameter: 11 dia.)
- Push-Pull lock structure enables easy one-handed insertion and removal.
- Audible and tangible “click” confirm secure locking when mating.
- Metal outer parts and ground terminal installed in receptacle ensure shield effect.
- Mis-mating can be visibly prevented with color variation of plug boots.
- Connector mating life: 5,000 times

General Specifications

- No. of contacts : 8 pos.
- Rated current: 2A per 1pos.
- Rated voltage: AC200Vr.m.s
- Operating temperature: -55 Deg. C to +85 Deg. C
- Water proof: IP68 (when mated and receptacle itself)
- Life time: 5000 times
- Applicable wire: AWG#28max. (outer dia. of cab tire cable 5mm dia. max.)

Materials and Finishes

<Receptacle>

Components	Materials and Finishes
Socket contact	Copper Alloy/ Au plating over Ni
Shell	Copper Alloy/ Chrome plating
Insulator	Glass filled PPS
Assembly nut	Copper Alloy/ Chrome plating
Gasket	Silicon rubber
“O”Ring	Nitrogen rubber
Ground pin	Copper Alloy/ Sn-Pb plating
Dust cap	EPDM rubber

<Plug>

Components	Materials and Finishes
Pin contact	Copper Alloy/ Au plating over Ni
Barrel	Zinc Alloy/ Ni plating over Cu
Insulator	Glass Filled PPS
Coupling nut	Copper Alloy/ Chrome plating
Spacer	Copper Alloy/ Ni plating
Lock spring	Copper Alloy/ Ni plating over Cu
Shield sleeve	Copper Alloy/ Ni plating
Bushing	EPDM rubber
Ground nut	Copper Alloy/ Chrome plating
Clamp	Copper Alloy/ Ni Plating
Boots	Polyester elastomer
Outer boots clamp	Polyacetal

Ordering Information

[Receptacle]

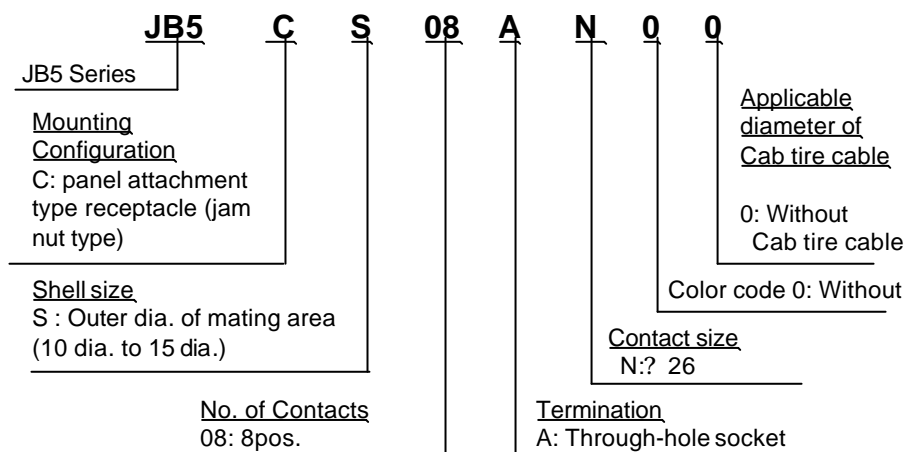

[Plug]

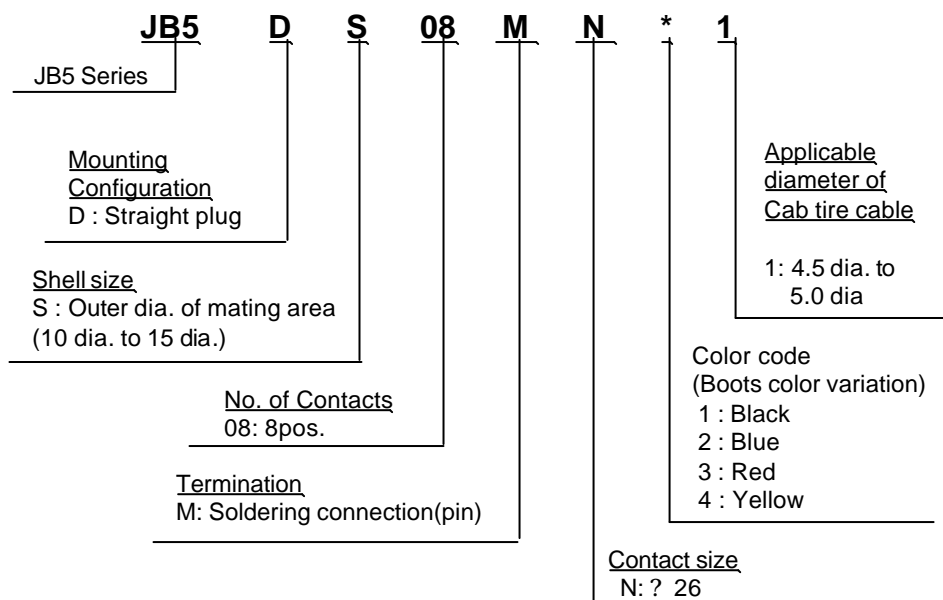

Receptacle

[Part Number: JB5CS08AN00]

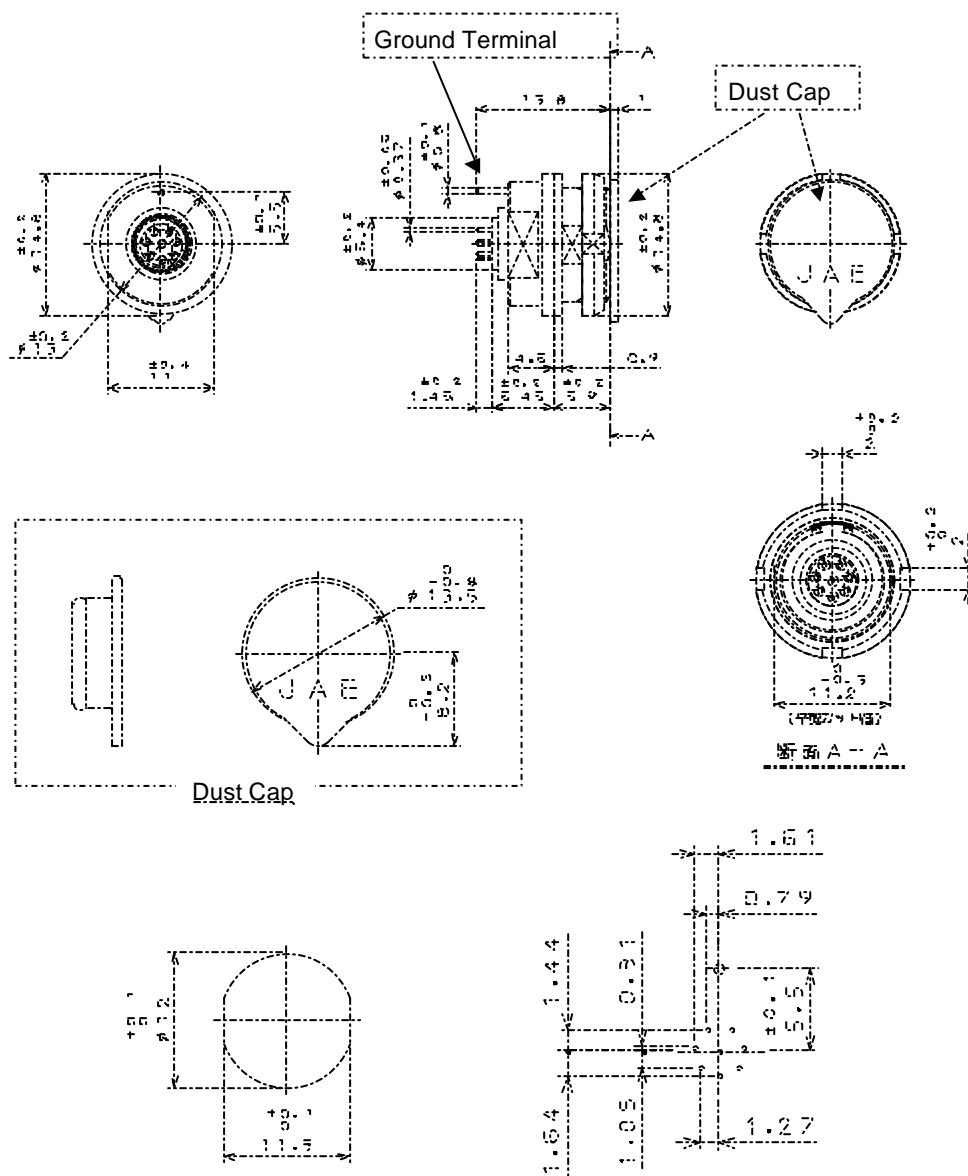

Panel dimension
(for reference)

Panel thickness: 2.5mm max.

Through-hole diameter of
board (for reference)

Plug

[Part Number: JB5DS08MN*1]

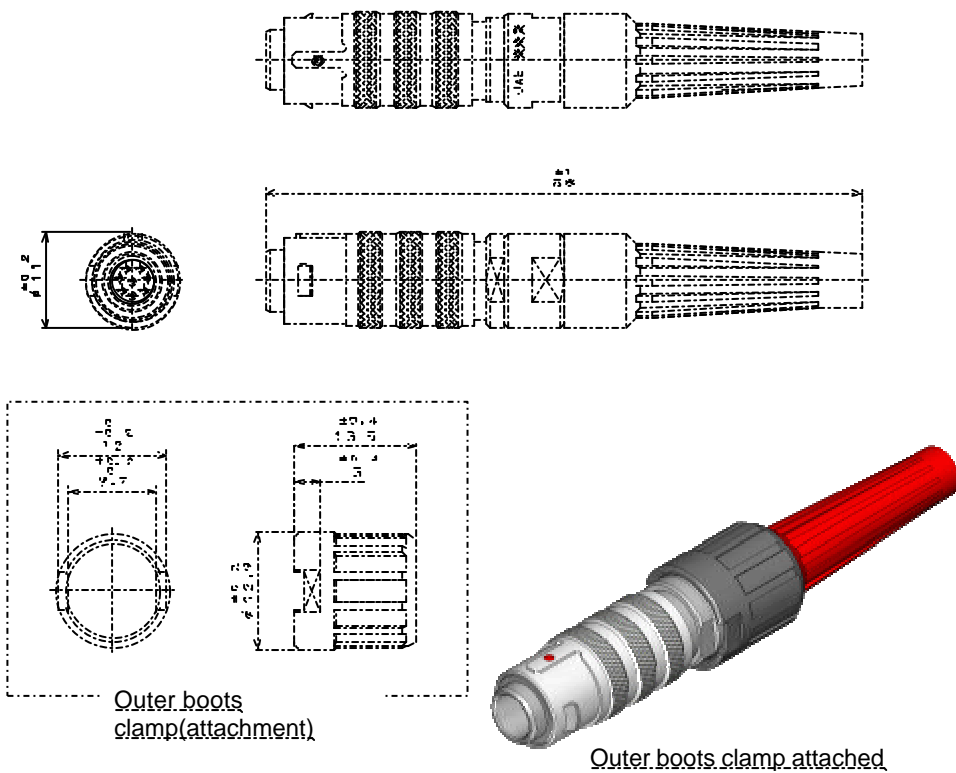

[Outer clamp (attachment)]

<Use>

The outer boot clamp can be used as a reinforcing part to prevent the rising or disengagement of the boot caused by severe cable bend, etc.

The customer may use this or not depending on the use conditions and purpose.

<Note>

Once the outer clamp is mounted in the connector, it cannot be unmounted.

[Boots color variation]

Black, Blue, Red, Yellow (4colors)

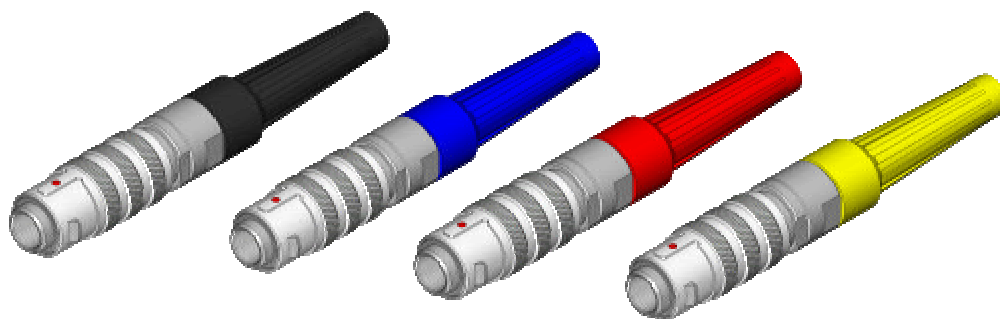

Technical Information

	Part Number	SJ Drawing	Specifications
Receptacle	JB5CS08A00	SJ100060 (2 nd version)	JACS-50001
Plug	JB5DS08MN*1	SJ100061 (2 nd version)	JACS-50001

Japan Aviation Electronics Industry, Limited

Product Marketing Division
 Aobadai Building, 3-1-19, Aobadai, Meguro-ku, Tokyo 153-8539
 Phone: +81-3-3780-2787 FAX: +81-3-3780-2946

Notice: Products shown in this leaflet are made for the applications listed below. However, if the abovementioned products are to be used in aerospace devices, marine cable-connection devices, atomic power control systems, medical equipment for life-support systems, or any other specific application requiring extremely high reliability, please contact JAE for further information.

Recommended applications: Computers, Office machines, Measuring devices, Telecommunication devices (Terminals, Mobile devices), AV devices, Household applications, FA devices, etc.