

BODY CLIPS (BC/BCV)

- Designed to secure a cable to a sheet metal panel
 - Holds up to 3/8" diameter cables
 - **Material: 1050 Spring Steel, Heat Treated**
 - **Finish: Zinc Phosphate and Wax**
 - Vinyl: Plastisol Dipped, Nominal 1/32 (0.8) vinyl thickness
 - Standard Pack: 1000/pack
- Common sizes noted by shading

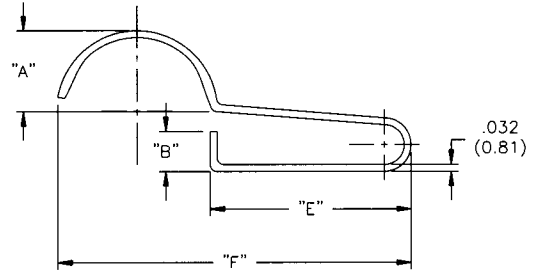

PART NO.	PANEL RANGE	"A"	"B"	"E"	"F"	CUSHION
BC-156-305	.074-.156	.19	.17	.70	1.06	PLAIN
BCV-156-305	(1.88-3.96)	(4.8)	(4.3)	(17.8)	(26.9)	VINYL
BC-175-305	.120-.175	.25	.19	.94	1.63	PLAIN
BCV-175-305	(3.05-4.45)	(6.4)	(4.8)	(23.9)	(41.4)	VINYL
BC-312-305	.175-.312	.22	.22	.89	1.65	PLAIN
BCV-312-305	(4.45-7.92)	(5.6)	(5.6)	(22.6)	(41.9)	VINYL

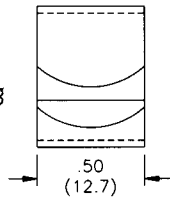
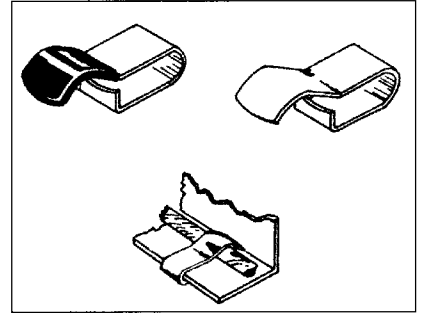

U-CLIPS (SU)

- Snaps easily over metal, plastic or wood panels up to .120" thick
- Barbs provide a strong retention onto panel
- **Material: 1050 Spring Steel, Heat Treated**
- **Finish: Zinc Phosphate and Wax**
- Standard Pack: 2,000/pack

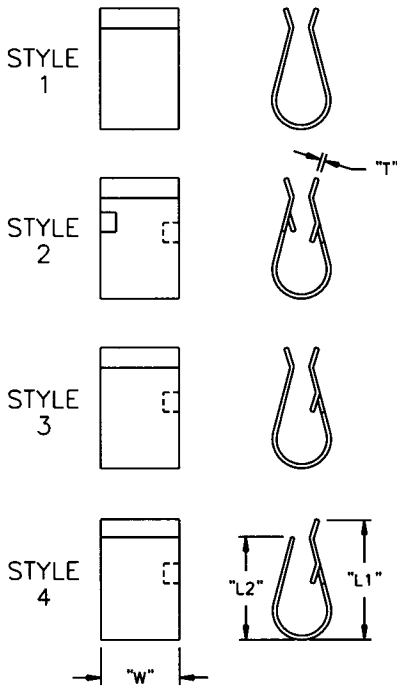

PART NO.	PANEL RANGE	"L1"	"L2"	"W"	"T"	STYLE
SU-0609	.062-.093 (1.57-2.36)	.63 (16.0)	.63 (16.0)	.38 (9.7)	.020 (0.51)	1,2,3
SU-0618	.062-.187 (1.57-4.75)	.75 (19.1)	.75 (19.1)	.63 (16.0)	.025 (0.64)	1,2,3
SU-0512	.050-.120 (1.27-3.05)	.46 (11.7)	.38 (9.7)	.50 (12.7)	.017 (0.43)	1,4
SU-1612	.060-.120 (1.52-3.05)	.38 (9.7)	.31 (7.9)	.38 (9.7)		1,4

