

EAHF-E24-...-P
Profile mounting

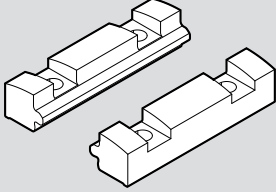

FESTO

Festo SE & Co. KG
Ruiter Straße 82
73734 Esslingen
Germany
+49 711 347-0

www.festo.com

Assembly instructions

8203084
2023-12
[8203086]



Translation of the original instructions
© 2024 all rights reserved to Festo SE & Co. KG

1 Applicable documents

 All available documents for the product → www.festo.com/sp.

Document	Product	Content
Operating instruction	Axis ELGD	–

Tab. 1: Applicable documents

2 Safety

2.1 Safety instructions

– Only mount the product on components that are in a condition to be safely operated.

2.2 Intended use

The profile mounting attaches an axis ELGD to a mounting surface by the basic profile.

2.3 Training of qualified personnel

Work on the product may only be carried out by qualified personnel who can evaluate the work and detect dangers. Personnel must have the relevant mechanical training.

3 Additional information

– Contact the regional Festo contact if you have technical problems
→ www.festo.com.
– Accessories → www.festo.com/catalogue.

4 Product Range Overview

4.1 Scope of delivery

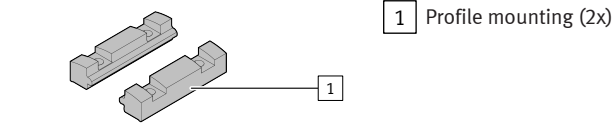

Fig. 1: Scope of delivery

4.2 Not in scope of delivery

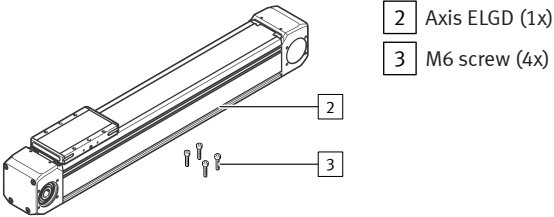

Fig. 2: Not included in the scope of delivery

5 Assembly

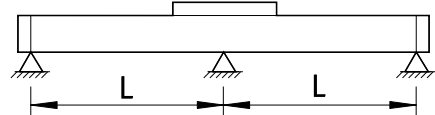

Fig. 3: Determine support spacings and mounting points

- Determine the required support spacings L and the mounting points of the axis → Other applicable documents.

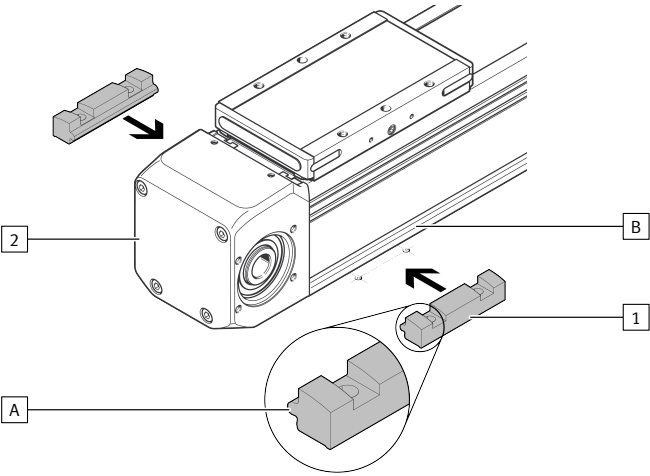

Fig. 4: Positioning profile mountings

- Position the profile mountings [1] at the mounting points.
→ The lug [A] lies in the slot [B] of the axis [2].

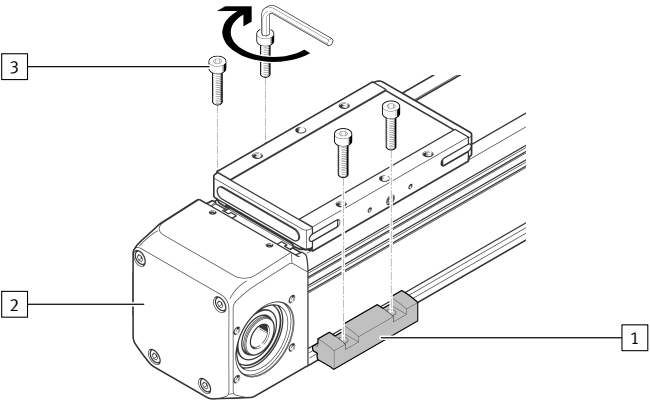

Fig. 5: Installing profile mountings

1. Select the suitable screws [3] for the installation situation.
2. Press the profile mounting [1] against the axis [2].
→ The profile mounting [1] is flush with the axis [2].
3. Fasten the profile mountings [1] on the mounting surface with the screws [3].
Maximum tightening torque: 7.6 Nm
4. Repeat the mounting steps for all mounting points.