

## Features

- Measuring length: 1000 mm
- Incremental encoder output:  
*High Linedriver*
- A, A', B, B', Z, Z' channels
- 5-24VDC Supply Voltage
- 0.1mm/pulse resolution
- IP65 protection

## RS PRO Motion Control Sensors

RS Stock No.: 0359023



RS Professionally Approved Products bring to you professional quality parts across all product categories. Our product range has been tested by engineers and provides a comparable quality to the leading brands without paying a premium price.

## Product Description

*This product is designed as compact, high robust, accurate linear position sensor, using optic encoder technology, up to 1000 mm measuring length. It provides incremental linear position feedback for wide range of industrial applications.*

## Mechanical Specifications

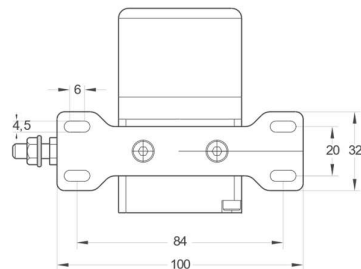
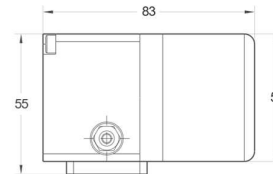
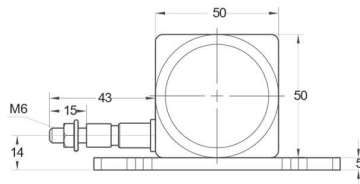

### Push-Pull Cable Output

+V : Brown  
0V : White  
GND : Shield  
Ch A : Yellow  
Ch B : Green  
Ch Z : Gray

### TTL - High Linedriver - Linedriver Cable Output

+V : Brown  
0V : White  
GND : Shield  
Ch A : Yellow  
Ch B : Green  
Ch Z : Gray  
Ch A Inv.: Blue  
Ch B Inv.: Red  
Ch Z Inv.: Pink

## General Specifications

Encoder Technology	Linear Measuring
Stroke	1000 mm
Type of measurement	Optical
Resolution	0,1 mm/pulse
Output signal	A, A', B, B', Z, Z'
Output signal type	High Linedriver
Supply Voltage	5 – 24 VDC
Power consumption (without load)	<40 mA (24 VDC)
Electrical connections	2.5 m cable (standard)
Displacement speed	2 m/s
Case material	Aluminium
Weight	< 500 gr
IP Rating	IP 65
Operating temperature	-20°C ... +80°C
Storage temperature	-30°C ... +90°C

## Approvals

Declarations	CE, UKCA, ROHS, REACH
--------------	-----------------------

## Similar Products

RS PRO Part Number	Stroke	Output Signal Type	Resolution	Supply Voltage	Connector / Cable
0359025	2000mm	High Line driver A, A', B, B' Z, Z'	0,1 mm/pulse	5-24 VDC	2,5 meter cable