



3699

3699

**STUD ELBOW, BSP PARALLEL AND METRIC**

this fitting orientates for positioning purposes

<b>maximum working pressure</b>	<b>bar</b>	<b>MPa</b>	<b>psi</b>
	20	2,0	290
<b>working temperature</b>	<b>°C (Celsius)</b>	<b>F (Fahrenheit)</b>	<b>K (Kelvin)</b>
	From -20 to 120	From -4 to 248	From 253 to 393
<b>body</b>	nickel-plated brass		
<b>'O'-rings</b>	Fluoroelastomer FKM (FPM)		
<b>'O'ring</b>	engineering grade polymer		

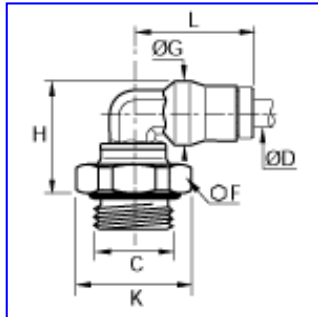

3699

3699

STUD ELBOW, BSP PARALLEL AND METRIC  
for metric tubing

Part No	ØD (mm)	C	E (mm)	F (mm)	ØG (mm)	H (mm)	J (mm)	K (mm)	L (mm)	 (kg)
3699 04 10	4	G1/8		13,0	10,0	17,0		14,0	18,0	0,016
3699 04 13	4	G1/4		16,0	10,0	17,5		17,5	18,0	0,016
3699 04 19	4	M5x0,8		10,0	10,0	18,0		11,0	18,0	0,011
3699 04 52	4	M6x1		10,0	10,0	18,0		11,0	18,0	0,010
3699 04 56	4	M8x1		11,0	10,0	18,0		12,0	18,0	0,013
3699 06 10	6	G1/8		13,0	12,0	19,0	8,0	14,0	21,5	0,017
3699 06 13	6	G1/4		16,0	12,0	19,5	8,0	17,5	21,5	0,020
3699 06 60	6	M10x1		13,0	12,0	19,0		14,0	21,5	0,017
3699 08 10	8	G1/8		13,0	15,0	20,5	10,0	14,0	23,5	0,032
3699 08 13	8	G1/4		16,0	15,0	21,5		17,5	23,5	0,025
3699 08 17	8	G3/8		20,0	15,0	21,5		22,0	23,5	0,030
3699 10 13	10	G1/4		16,0	17,5	27,0		17,5	29,0	0,037

3699 10 17	10	G3/8	20,0	17,5	25,5		22,0	29,0	0,038
3699 12 13	12	G1/4	16,0	19,5	29,5		17,5	31,0	0,047
3699 12 17	12	G3/8	20,0	19,5	28,5		22,0	31,0	0,048
3699 12 21	12	G1/2	24,0	19,5	28,5		26,0	31,0	0,081
3699 14 17	14	G3/8	20,0	21,5	29,0	16,0	22,0	34,0	0,085
3699 14 21	14	G1/2	24,0	21,5	29,5		26,0	34,0	0,094