

## Features

- 100-5000 ppr. Resolution
- Incremental encoder output: Push-Pull, TTL, Linedriver or HLD output
- 50 mm case diameter
- 6-8-10-12-14-15 mm rod diameter
- 3500 rpm max.
- Hollow shaft or semi hollow shaft case

## RS PRO Motion Control Sensor Optic Rotary Incremental Encoder

Stock No.. 0100432



RS Professionally Approved Products bring to you professional quality parts across all product categories. Our product range has been tested by engineers and provides a comparable quality to the leading brands without paying a premium price.

## Product Description

Series designed as compact, highly robust, rotary motion control sensors, using incremental optic measuring technology, up to 5000 ppr. resolution. Series provides angular speed & displacement feedback for wide range of industrial applications.

## Mechanical Specifications

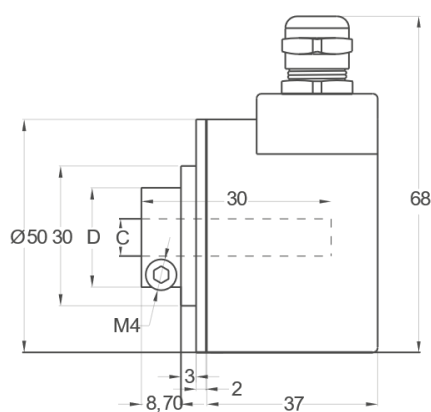

SHType (Radial)

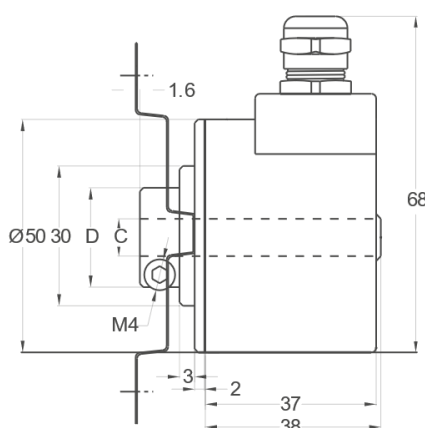

HType (Radial)



| PRI 50SH / H | SH<br>(semi hollow shaft) / H<br>(hollow shaft) |        |
|--------------|---|--------|
|              | C   | D      |
|              | Ø6mm  | 20mm   |
|              | Ø8mm  | 22mm   |
|              | Ø10mm   | 23,5mm |
|              | Ø12mm   | 23,5mm |
|              | Ø14mm   | 29,5mm |
|              | Ø15mm   | 29,5mm |

### Push - Pull Cable Output

+V : Brown  
0V : White  
GND: Shield  
Ch A: Yellow  
Ch B: Green  
Ch Z: Gray

### TTL - HLD Linedriver Cable Output

+V : Brown  
0V : White  
GND : Shield  
Ch A : Yellow  
Ch B : Green  
Ch Z : Gray  
Ch A inv: Blue  
Ch B inv: Red  
Ch Z inv: Pink

## General Specifications

|  |   |
|--|---|
| Resolution                               | 100-5000 ppr.   |
| Output channels                          | A,B,Z or AA,BB, ZZ  |
| Output type                              | TTL, Linedriver, Push-Pull, HLD   |
| Power supply                             | 5 VDC, 5-24 VDC or 8-24 VDC   |
| Power consumption(without load)          | <40 mA (24 VDC)   |
| Cable                                    | 2.5 meter (standard) 5 wire + shield (Push-Pull)<br>2.5 meter (standard) 8 wire + shield (Linedriver) |
| Maximum permissible shaft loading radial | Radial: 100N<br>Axial: 60N  |
| Displacement speed                       | 3500 rpm  |
| Rod diameter                             | Ø6-8-10-12-14-15 mm   |
| Rod material                             | Stainless steel   |
| Case dimension                           | Ø50 mm  |
| Case material                            | Aluminium and painted steel   |
| Protection level                         | IP 54   |
| Operating temperature                    | -20°C ... +80°C   |
| Storage temperature                      | -30°C ... +90°C   |

## Approvals

|              |                       |
|--------------|-----------------------|
| Declarations | CE, UKCA, ROHS, REACH |
|--------------|-----------------------|

## Article

| RS PRO Part Number | MPN     | Hollow Shaft Diameter | Output               | Resolution | Pover Supply | Connector / Cable |
|--------------------|---------|-----------------------|----------------------|------------|--------------|-------------------|
|                    | 0100432 | 12                    | Push Pull<br>A, B, Z | 1024 ppr.  | 5-24 VDC     | 2,5 meter cable   |