

HC-STA-D07-BWSCF-M32-PL-BK - Housing



1672252

<https://www.phoenixcontact.com/in/products/1672252>

Please be informed that the data shown in this PDF document is generated from our online catalog. Please find the complete data in the user documentation. Our general terms of use for downloads are valid.



Screw-in housing D7, with single locking latch, material: PA, protective cover material: PA, height: 35.5 mm, protective cover: yes, seal: yes, Standard, for socket inserts

Commercial data

Item number	1672252
Packing unit	1 pc
Minimum order quantity	1 pc
Product key	AF7APD
GTIN	4067923220270
Weight per piece (including packing)	30.8 g
Weight per piece (excluding packing)	222 g
Country of origin	CN

HC-STA-D07-BWSCF-M32-PL-BK - Housing



1672252

<https://www.phoenixcontact.com/in/products/1672252>

Technical data

Notes

General	for contact inserts HC-A03, A04, D07, D08, Q02, Q03, Q04, Q05, Q07, Q12
---------	---

Product properties

Product type	Housing with locking latch
Housing type	Screw-in housing
Application	Standard
Type	D7
Seal present	yes
Protective cover	yes
Shielded	no

Dimensions

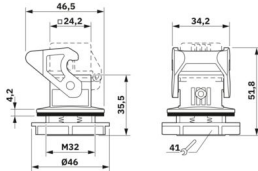
Dimensional drawing	
Height	35.5 mm
Thread pitch	1.5 mm

Material specifications

Flammability rating according to UL 94	V0 (Housing)
	V0 (Interlock)
	V0 (Protective cover)
Seal material	NBR
	NBR
Housing material	PA
Material, protective cover	PA
Locking latch material	PA

Mechanical properties

Mechanical data

Locking type	Latch
--------------	-------

Connection data

Tightening torque	5 Nm ... 7.5 Nm
-------------------	-----------------

Mounting

Assembly note	For mounting socket inserts
---------------	-----------------------------

HC-STA-D07-BWSCF-M32-PL-BK - Housing



1672252

<https://www.phoenixcontact.com/in/products/1672252>

To ensure anti-rotation protection of the housing, use the attached mounting cutout. Alternatively, you can use a consistently round panel cutout. However, this cutout cannot guarantee anti-rotation protection.

Environmental and real-life conditions

Ambient conditions

Degree of protection	IP66 (when plugged in or with locked protective cover)
Impact strength	IK06
Ambient temperature (operation)	-40 °C ... 125 °C

Drawings

Dimensional drawing

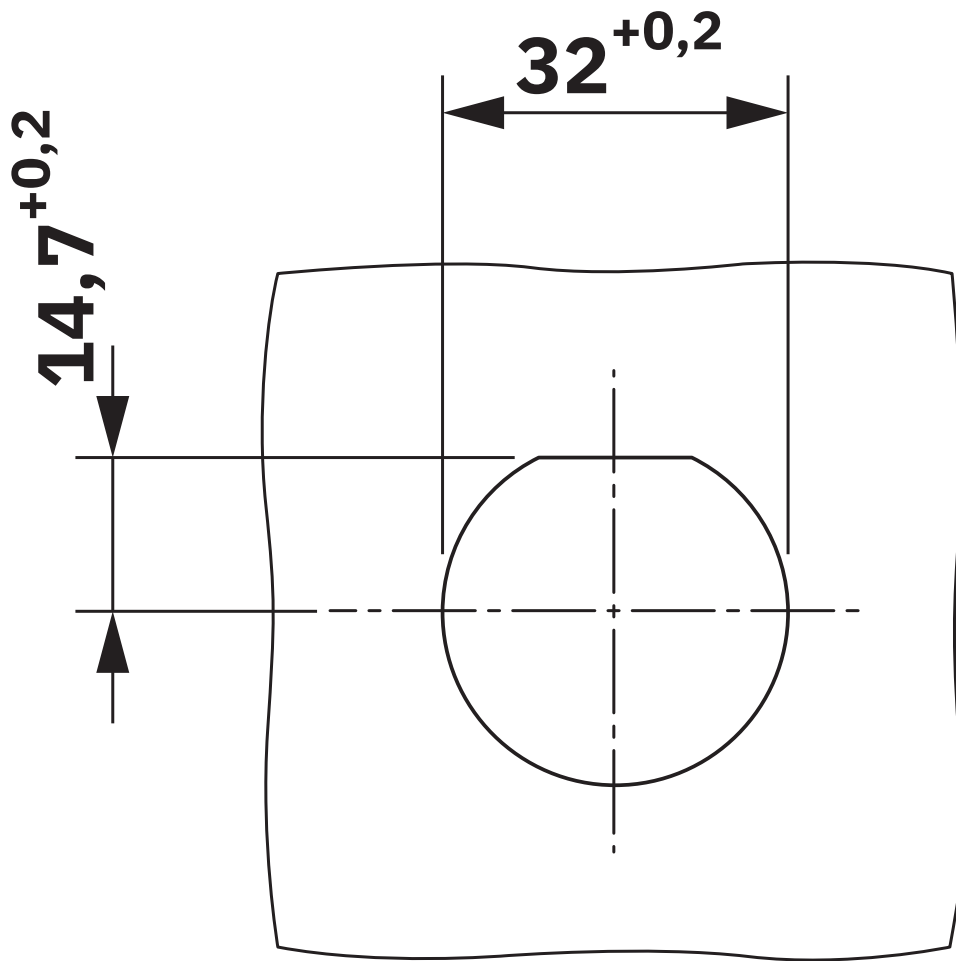

Panel cutout

HC-STA-D07-BWSCF-M32-PL-BK - Housing

1672252

<https://www.phoenixcontact.com/in/products/1672252>



Dimensional drawing

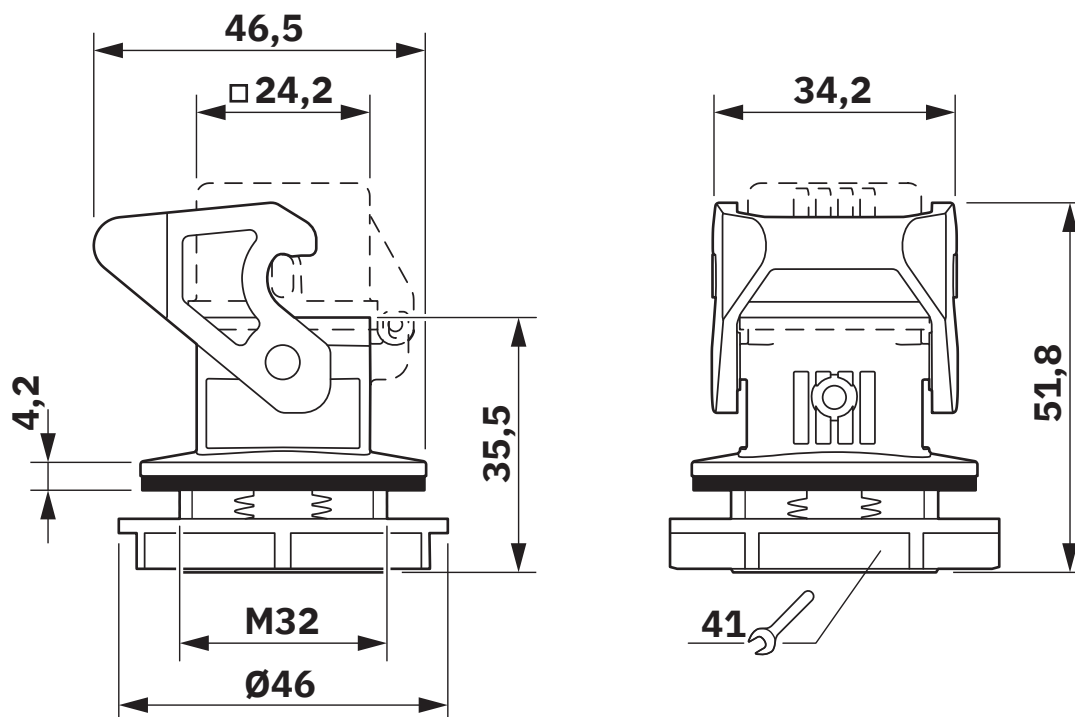

Dimensional drawing

HC-STA-D07-BWSCF-M32-PL-BK - Housing



1672252

<https://www.phoenixcontact.com/in/products/1672252>

Classifications

ECLASS

ECLASS-11.0	27440202
ECLASS-13.0	27440202

ETIM

ETIM 9.0	EC000437
----------	----------

HC-STA-D07-BWSCF-M32-PL-BK - Housing



1672252

<https://www.phoenixcontact.com/in/products/1672252>

Environmental product compliance

EU RoHS	
Fulfills EU RoHS substance requirements	Yes, No exemptions
China RoHS	
Environment friendly use period (EFUP)	EFUP-E
	No hazardous substances above the limits
EU REACH SVHC	
REACH candidate substance (CAS No.)	No substance above 0.1 wt%

HC-STA-D07-BWSCF-M32-PL-BK - Housing



1672252

<https://www.phoenixcontact.com/in/products/1672252>

Accessories

US-EMLP (20X9) CUS - Plastic label

0830085

<https://www.phoenixcontact.com/in/products/0830085>

Plastic label, Card, can be ordered: by card, white, labeled according to customer specifications, mounting type: adhesive, Number of individual labels: 75, text field height: 9 mm, text field width: 20 mm



HC-D07-SL-PLBK - Housing brackets

1424440

<https://www.phoenixcontact.com/in/products/1424440>

Replacement latch for HC-D7 housing



HC-STA-D07-BWSCF-M32-PL-BK - Housing

1672252

<https://www.phoenixcontact.com/in/products/1672252>



UNIFOX-WRENCH - Screw pliers

1212835

<https://www.phoenixcontact.com/in/products/1212835>



Screw pliers, with fast adjustment, for wrench size 10 mm ... 36 mm, size: 260 mm

Phoenix Contact 2025 © - all rights reserved

<https://www.phoenixcontact.com>

PHOENIX CONTACT (I) Pvt. Ltd.

A-58/2, Okhla Industrial Area, Phase - II, New Delhi-110 020

+91.1275.71420

info@phoenixcontact.co.in