

## FEATURES

- Primary voltage rating of 230 - 415V ac
- Secondary voltage rating of 55 or 230V ac
- Power rating of 50 - 1000VA
- Operating frequency of 50/60Hz
- Maximum temperature of 130°C
- Low noise laminations
- Varnish impregnated
- Protection class IP00

## RS PRO Isolating Transformers



RS Professionally Approved Products bring to you professional quality parts across all product categories. Our product range has been tested by engineers and provides a comparable quality to the leading brands without paying a premium price.

Subject to errors and changes in data sheets. D4856176

## Product Description

Single phase transformers with screw connectors for multiple input and brackets for screw fixation. Designed according to the following specifications.

- High quality safety and isolating transformers designed for use in control circuits and general applications.
- Low loss/noise laminations.
- Dual standard primary winding 230/400V ac with +15V tap for input flexibility. Earth terminal provided.
- Dual secondary windings centre tapped.
- Varnish impregnated.
- Fully shrouded screw terminals with voltage markings at label.
- Detailed product specification on permanent label.
- High efficiency, low regulation design.
- Designed and manufactured to conform to IEC 61558-1
- 100% electrical and flash tested

## General Specifications

<b>Number of Outputs</b>	1
<b>Output Protection Type</b>	None. Suggested fusing according to current rating.
<b>Applications</b>	Medical industry, testing power devices

## Mechanical Specifications

<b>Mounting Type</b>	Panel
<b>Length</b>	84 - 150mm
<b>Width</b>	84 - 175mm
<b>Depth</b>	91 - 155mm
<b>Weight</b>	1.9 – 14.6kg

## Electrical Specifications

<b>Power Rating</b>	50 - 1000VA
<b>Primary Voltage Rating</b>	230 - 415V ac
<b>Secondary Voltage Rating</b>	55 or 230V ac
<b>Temperature Class</b>	B (130°C)

Input Data	
Rated Input Voltage	230 - 415V ac
Switch-On Time	100%
Minimum Operating Frequency	50Hz
Maximum Operating Frequency	60Hz

Output Data	
Rated Output Voltage	55 or 230V ac
Rated Power	50 - 1000VA

## Protection Category

IP Rating	IP00
-----------	------

## Approvals

Declarations	MFR Declaration of Conformity
Compliance	RoHS, CE
Standards Met	IEC/BS/EN 61558-1 AS/NZS 61558.1 IEC/BS/EN 61558-2-6 AS/NZS 61558.2.6

## Order Details

RS Stock number	Power VA	Specification	No-load voltage	According to
504290	50	Isolating Transformers + 15 - 0 - 230 - 400V / 12 - 0 -	13.1	IEC61558-2-6
504313	50	Isolating Transformers + 15 - 0 - 230 - 400V / 24 - 0 -	25.8	IEC61558-2-4
504296	50	Isolating Transformers + 15 - 0 - 230 - 400V / 55 - 0 -	59	IEC61558-2-4
504307	50	Isolating Transformers + 15 - 0 - 230 - 400V / 0 - 230V	243.2	IEC61558-2-4
504303	100	Isolating Transformers + 15 - 0 - 230 - 400V / 12 - 0 -	12.8	IEC61558-2-6
504151	100	Isolating Transformers + 15 - 0 - 230 - 400V / 24 - 0 -	25.6	IEC61558-2-4
504161	100	Isolating Transformers + 15 - 0 - 230 - 400V / 55 - 0 -	59	IEC61558-2-4
504167	100	Isolating Transformers + 15 - 0 - 230 - 400V / 0 - 230V	244	IEC61558-2-4
504177	150	Isolating Transformers + 15 - 0 - 230 - 400V / 12 - 0 -	12.7	IEC61558-2-4
504155	150	Isolating Transformers + 15 - 0 - 230 - 400V / 55 - 0 -	58.1	IEC61558-2-4
504173	200	Isolating Transformers + 15 - 0 - 230 - 400V / 12 - 0 -	12.6	IEC61558-2-6
504123	200	Isolating Transformers + 15 - 0 - 230 - 400V / 24 - 0 -	25.3	IEC61558-2-4
504133	200	Isolating Transformers + 15 - 0 - 230 - 400V / 55 - 0 -	57	IEC61558-2-4
504139	200	Isolating Transformers + 15 - 0 - 230 - 400V / 0 - 230V	239	IEC61558-2-4
504149	300	Isolating Transformers + 15 - 0 - 230 - 400V / 12 - 0 -	12.6	IEC61558-2-6
504145	300	Isolating Transformers + 15 - 0 - 230 - 400V / 24 - 0 -	25.3	IEC61558-2-4
504212	300	Isolating Transformers + 15 - 0 - 230 - 400V / 55 - 0 -	57	IEC61558-2-4
504218	500	Isolating Transformers + 15 - 0 - 230 - 400V / 55 - 0 -	56.3	IEC61558-2-4
504228	500	Isolating Transformers + 15 - 0 - 230 - 400V / 0 - 230V	238.4	IEC61558-2-4
504224	1000	Isolating Transformers + 15 - 0 - 230 - 400V / 55 - 0 -	56.1	IEC61558-2-4
504234	1000	Isolating Transformers + 15 - 0 - 230 - 400V / 0 - 230V	235.3	IEC61558-2-4

## Mechanical Drawings

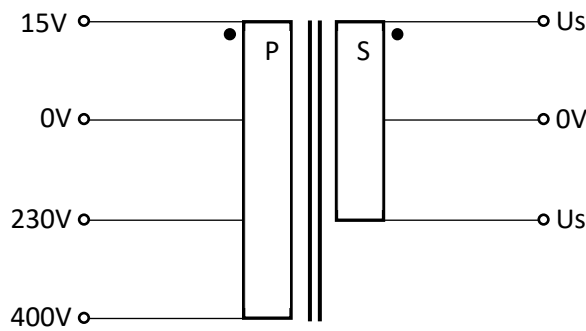
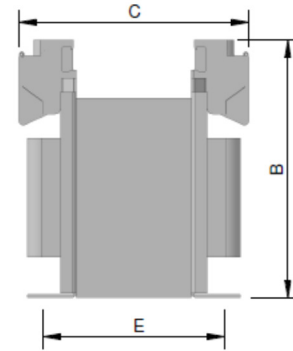
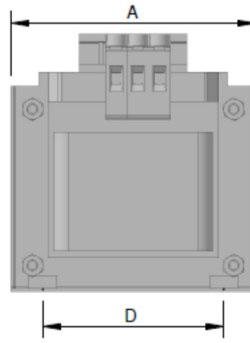
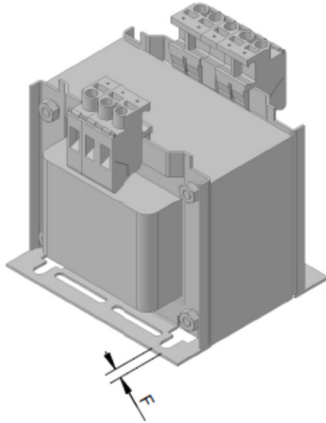

Power	Overall Size	Fixing	Fixing hole	Weight
[VA]	A x B x C [mm]	D x E [mm]	F [mm]	[kg]
50	84 x 91 x 84	64 x 64	4.5	1.9
100	84 x 91 x 97	64 x 72	4.5	2.5
150	108 x 110 x 90	84 x 72	6.5	3.5
200	108 x 110 x 114	84 x 92	6.5	5.0
300	120 x 130 x 143	90 x 106	6.5	6.9
500	120 x 130 x 143	90 x 106	6.5	7.5
1000	150 x 155 x 175	122 x 132	7.0	14.6