



ENGLISH

Datasheet

RS PRO Bearing Adapter Sleeve

Stock No: 196-4133



Technical Specifications:

To include attributes e.g. height, width, depth, color etc.

Inside Diameter	35mm
Locknut Diameter	58mm
Total Length	46mm

Features & Benefits:

- Most commonly used method of locating bearings with a tapered bore onto a cylindrical shaft
- Easy to Install
- Require no additional location on the shaft required
- Fitted with a slit that allows for easy mounting to increase flexibility.
- Different options available to suit many bearing variations.
- Range of sizes available to accommodate oil injection

Dimensional line drawings

Dimensions

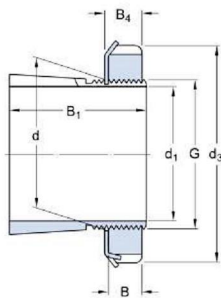

d ₁	35	mm
d	40	mm
d ₃	58	mm
B ₁	46	mm
B	9	mm
B ₄	10	mm
G	M 40x1.5	

Mass

Mass adapter sleeve assembly

0.22 kg



rspro.com



Quality Standards

M?r? ????s?? ???? M??s?d.???



rspro.com

