

Copyright FCI.

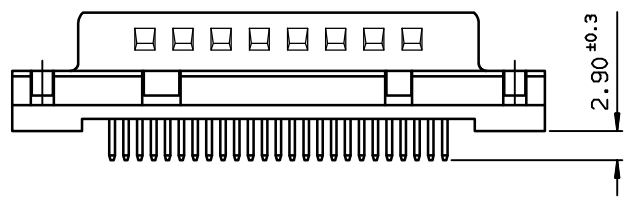
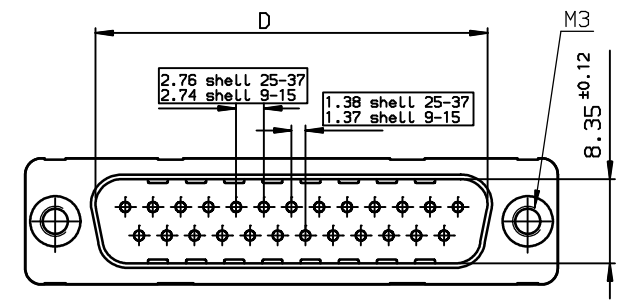
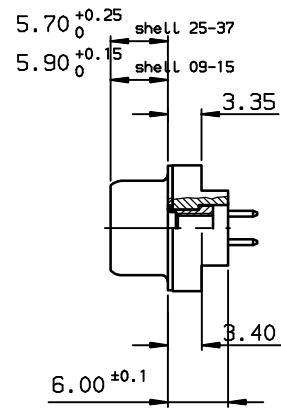
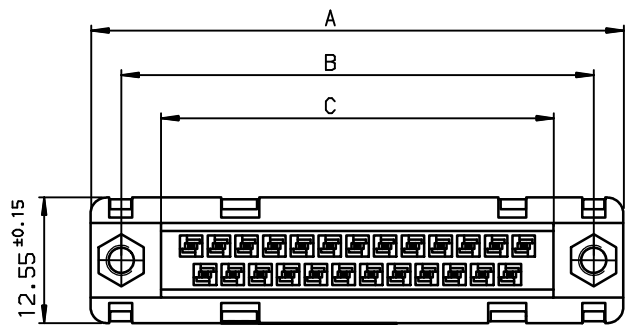

TIN LEAD PART NUMBER

SHELL	A±0.38	B±0.12	C±0.10	D±0.25	E±0.07	PART NUMBER
09	30.81	24.99	16.96	16.79	10.96	D09P24A.PL00
15	39.14	33.32	25.18	25.12	19.18	D15P24A.PL00
25	53.03	47.04	39.12	38.84	33.12	D25P24A.PL00
37	69.32	63.50	55.68	55.30	49.68	D37P24A.PL00

Plating: 4 --> flash AU
Plating: 6 --> 0.76µ AU

LEAD FREE PART NUMBER

SHELL	A±0.38	B±0.12	C±0.10	D±0.25	E±0.07	PART NUMBER
09	30.81	24.99	16.96	16.79	10.96	D09P24A.PL00LF
15	39.14	33.32	25.18	25.12	19.18	D15P24A.PL00LF
25	53.03	47.04	39.12	38.84	33.12	D25P24A.PL00LF
37	69.32	63.50	55.68	55.30	49.68	D37P24A.PL00LF

Plating: 4 --> flash AU
Plating: 6 --> 0.76µ AU

PC card drilling dimensions(after plating)
(thickness 1.60±0.20mm)

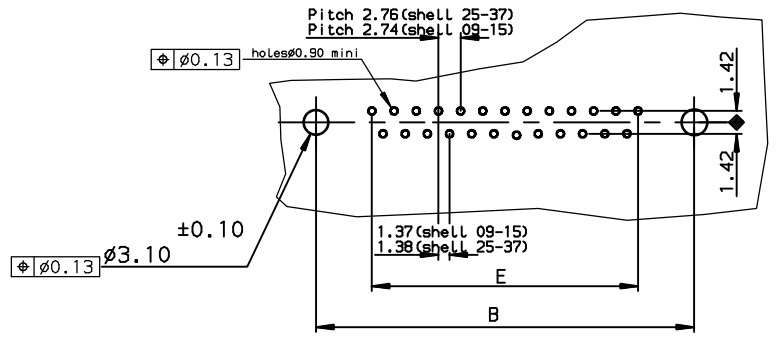

rev	ecn no	dr	date
C	-	JOU	1996/09/25
D	LS05-001	MPE	2005/03/09
E	LS05-0056	MPE	2005/06/27
F	LS06-0097	LGO	2006/07/29
-	-	-	-
-	-	-	-
-	-	-	-

GENERAL CHARACTERISTICS AND ROHS INFORMATIONS:
SEE DRAWING C01-8646-0000

www.fciconnect.com		surface ISO 1302 ✓	tolerance std ISO 406 ISO 1101	projection mm
		TOLERANCES UNLESS OTHERWISE SPECIFIED		size A3
Dr	LELEON	1992/09/10	ANGULAR	Scale 2
Eng	PESSON	1992/09/10	LINEAR	ECN LS06-0097
Chr	LEGARE	1992/09/10	0.xx' ± 2'	Spec ref -
Appr	LEGARE	1992/09/10	0.xxx ± 0.1	
		Product family	D-SUB	
title MALE CONNECTOR DELTA D ST		part no C01-8646-0096		Rev. F
straight,solder type for		CUSTOMER		sheet 1 of 1
catalog no				